

For Sublease

6,487 SF Retail / Flex
1002 N Central Expy, Bldg 5
Richardson, TX 75080



Property specifications

- 6,487 SF Available
- +/- 2,000 SF Retail/Showroom
- Available immediately
- Sublease expires August 31, 2028
- Three (3) dock doors
- Furniture and racking available

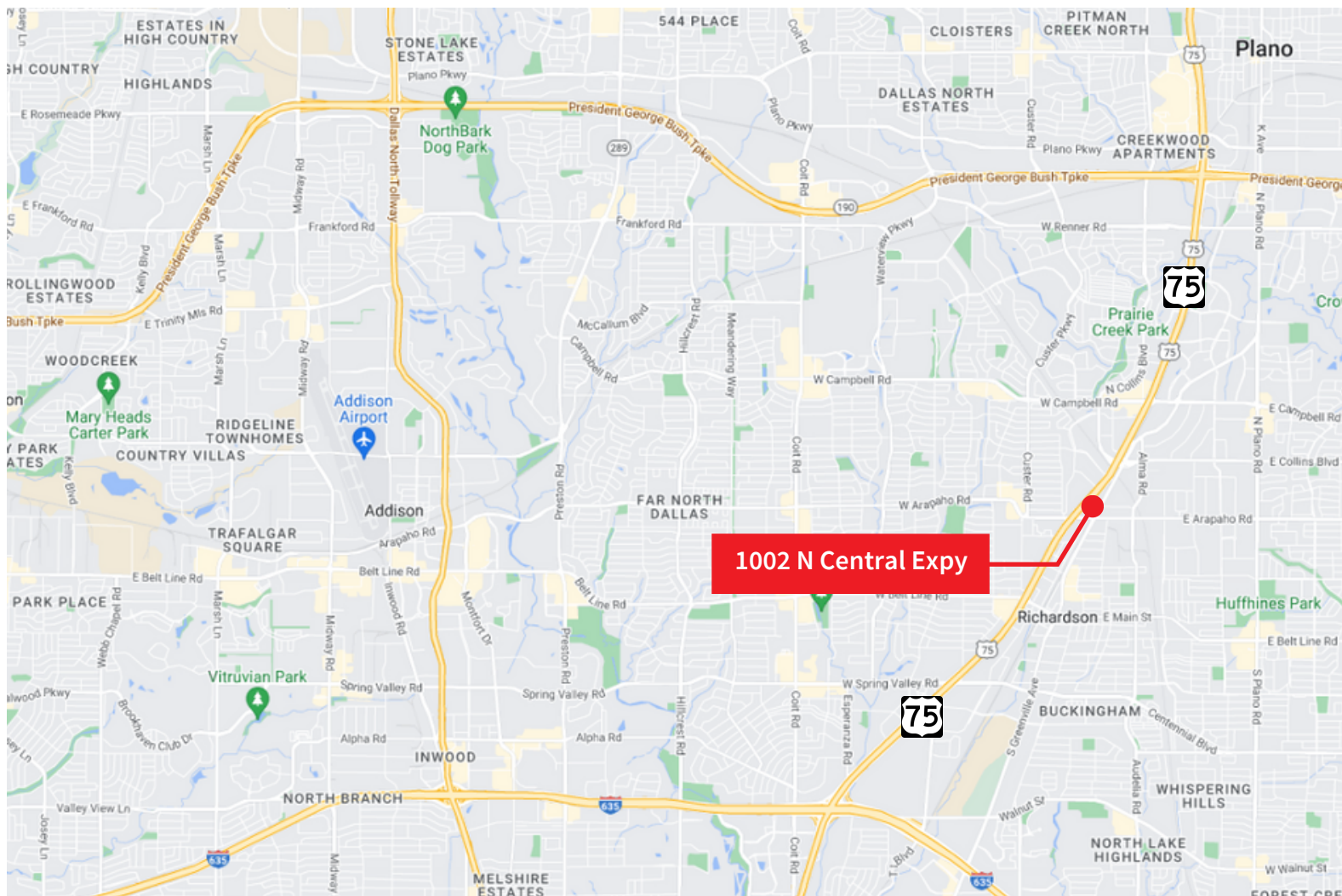

Site Plan

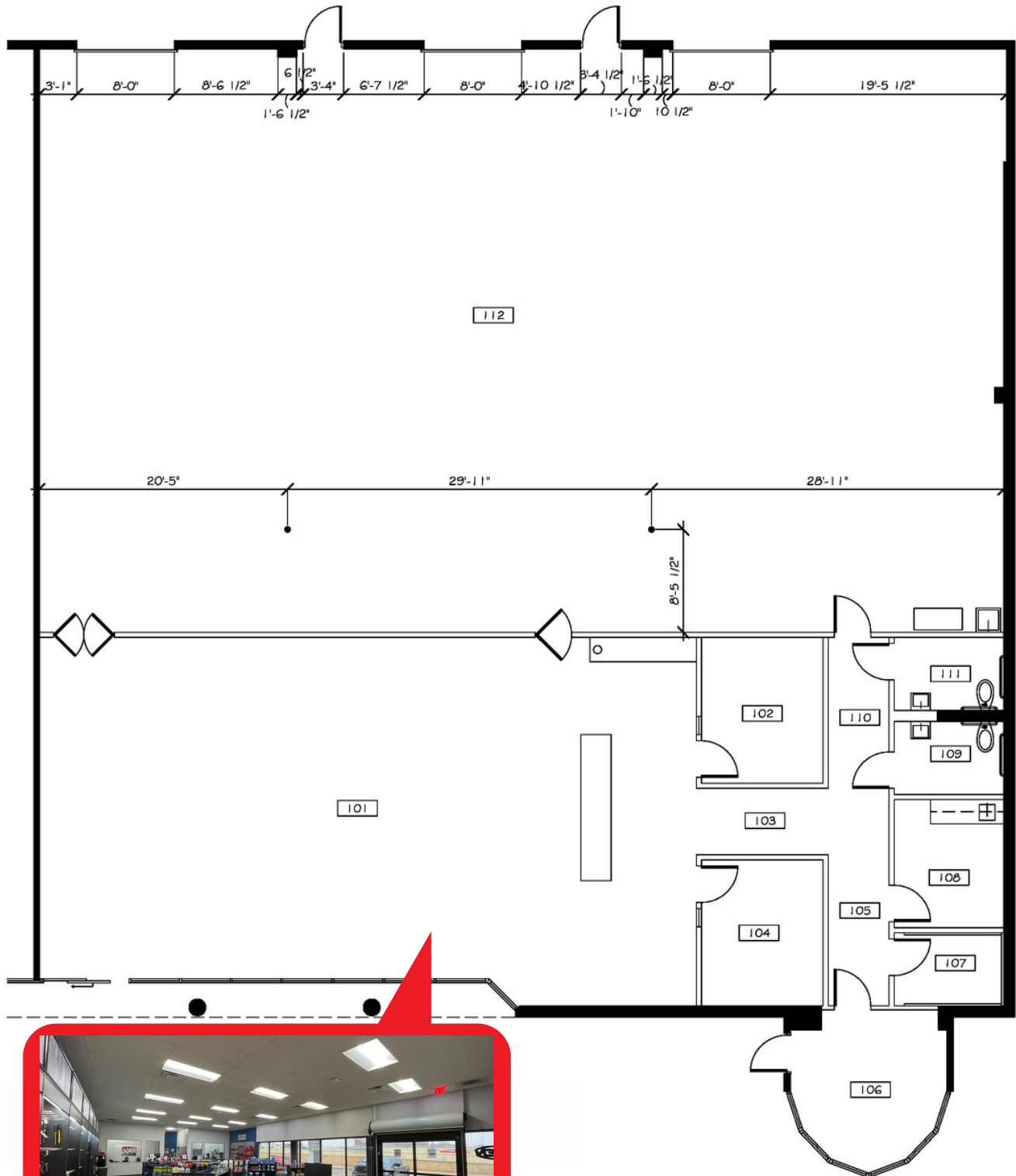



Caleb McCoy, SIOR
214 949 2084
caleb.mccoy@jll.com

Parker Grona
214 438 6516
parker.grona@jll.com