

FOR LEASE

7375 CHAPMAN AVENUE

GARDEN GROVE, CALIFORNIA



±45,896 SF
HIGH IMAGE FREE STANDING INDUSTRIAL BUILDING

LOUIS TOMASELLI

Executive Managing Director

+1 949 885 2985

louis.tomaselli@jll.com

RE Lic #00904844

MIKE FOWLER

Senior Managing Director

+1 310 597 2002

mike.fowler@jll.com

RE Lic #01197983



Jones Lang LaSalle Brokerage, Inc. RE license #01856260

THE HIGHLIGHTS



- ◆ ± 45,896 SF high image free standing industrial building
- ◆ ± 43,232 SF warehouse space
- ◆ ± 2,116 SF office space (459 SF secondary entry)
- ◆ ± 22.6' - 25.1' warehouse clearance throughout
- ◆ Eight (8) dock-high doors
- ◆ One (1) grade level door
- ◆ 2,000A, 277/480V, 3p/4w power supply (verify)
- ◆ Fire sprinklers (1.39 GMP / 960SF rated)
- ◆ Fenced yard
- ◆ Excellent West Orange County, Garden Grove Location
- ◆ Close Proximity to the SR-22, I-405 & I-605 Freeways

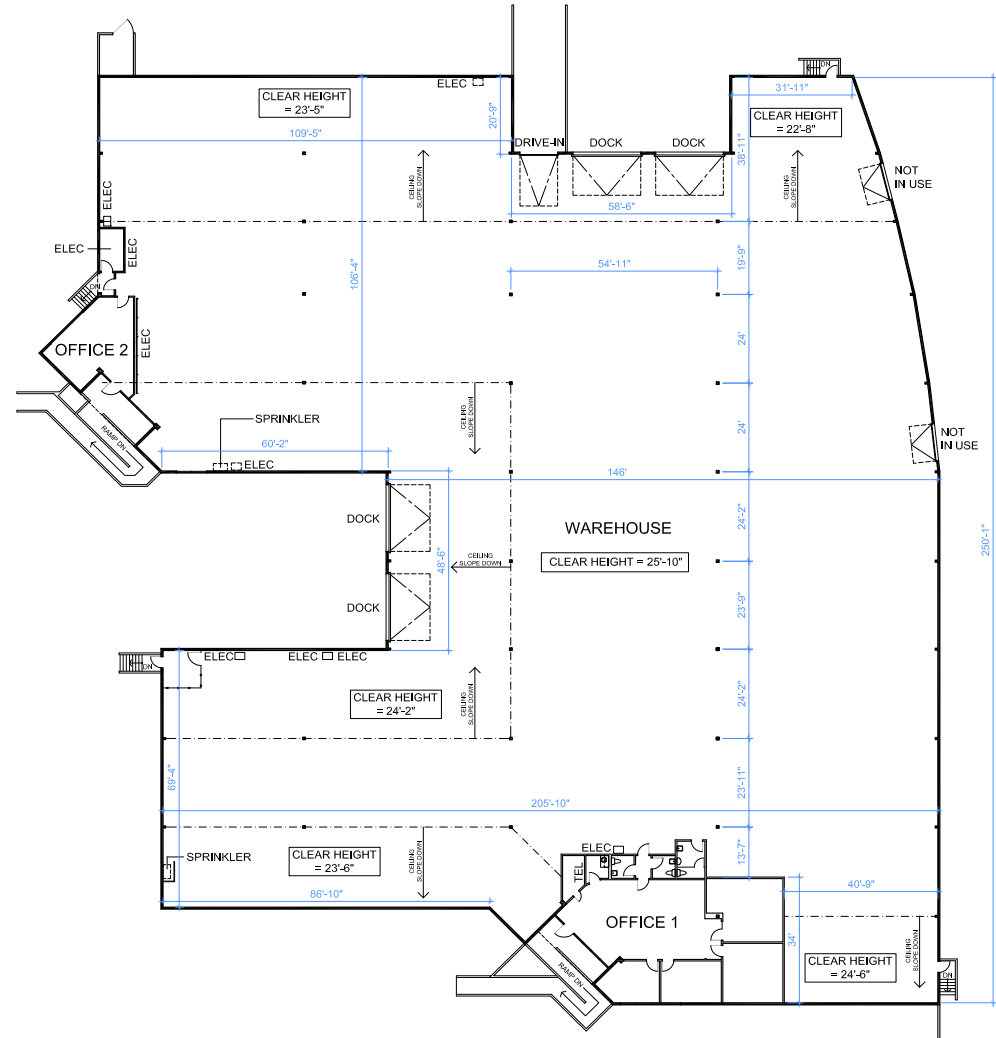

Approx. site, floorplan - not to scale

THE AERIAL



PORTS OF LONG BEACH

LONG BEACH

SEAL BEACH

HUNTINGTON BEACH

WESTMINSTER



7375 CHAPMAN AVE.

Knott Ave.

Chapman Ave.

Beach Blvd.

Western Ave.

Katella Ave.



**LOUIS TOMASELLI**

Executive Managing Director

+1 949 885 2985

louis.tomaselli@jll.com

RE Lic #00904844

MIKE FOWLER

Senior Managing Director

+1 310 597 2002

mike.fowler@jll.com

RE Lic #01197983



Although information has been obtained from sources deemed reliable, neither Owner nor JLL makes any guarantees, warranties or representations, express or implied, as to the completeness or accuracy as to the information contained herein. Any projections, opinions, assumptions or estimates used are for example only. There may be differences between projected and actual results, and those differences may be material. The Property may be withdrawn without notice. Neither Owner nor JLL accepts any liability for any loss or damage suffered by any party resulting from reliance on this information. If the recipient of this information has signed a confidentiality agreement regarding this matter, this information is subject to the terms of that agreement. ©2023. Jones Lang LaSalle IP, Inc. All rights reserved.