

# THE CONFLUENCE

173,035 SF Divisible

1371 Sunland Gin Rd | Casa Grande, AZ



Jones Lang LaSalle Brokerage, Inc. License #: C0508577000





UCID



N Sunland Gin Rd

Casa Grande-Picacho Hwy

E Hanna Rd

±1,274 Spec Office Suite

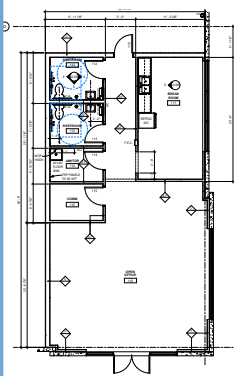

## BUILDING B

|                     |   |
|---------------------|---|
| Available Space     | 173,035 SF, divisible   |
| Building Dimensions | 220' x 785'   |
| Loading             | 38 dock high doors / 4 drive-in doors   |
| Power               | 3000A, 277/480 volt, three phase electrical service.<br>Conduit for future power expansion to 6000A power provided by APS |
| Parking             | 140 auto parking stalls / future trailer parking expansion  |
| Zoning              | L1 (City of Casa Grande)  |
| Floor               | 6" thick warehouse floor slab   |
| Column Spacing      | 60' speed bays, 56' x 53' bay size in the warehouse area  |
| Height              | 32' clear height  |
| Roof                | 1% sky lights, 20-year roof warranty  |
| Truck Court         | 100% concrete, fully secured 208' shared truck court  |
| Rails               | Rail capable UPRR main line   |
| Sprinklers          | K-25 ESFR   |





# CASA GRANDE/ELOY DEMOGRAPHICS

| Drive Time | 2022 Total Population | Projected 2027 Population | Households | Civilian Population of Age 16+ Labor Force | 2022 Median Age |
|------------|-----------------------|---------------------------|------------|--|-----------------|
| 30 minutes | 110,692               | 117,404                   | 38,070     | 47,047                                     | 36.7            |
| 60 minutes | 2,161,369             | 2,251,418                 | 804,673    | 1,124,563                                  | 34.9            |
| 90 minutes | 5,827,846             | 6,038,566                 | 2,190,196  | 2,917,399                                  | 36.7            |



## DRIVE TIMES FROM ELOY, AZ

|                                 |            |
|---------------------------------|------------|
| Chandler, AZ                    | 30 minutes |
| Tucson, AZ                      | 45 minutes |
| Phoenix, AZ                     | 45 minutes |
| Lukeville Port of Entry, Mexico | 2.5 hours  |
| San Diego, CA                   | 5 hours    |
| Los Angeles, CA                 | 6.5 hours  |

## AREA IMPROVEMENTS

**±40 minutes** (42.8 miles) to existing Intel campus

**±70 minutes** (77.6 miles) to future TSMC site

**\$800M 26-mile expansion** of I-10 from Chandler to Casa Grande has been approved, construction to commence in 2025





**ANTHONY LYDON, CSCMP**  
Executive Managing Director  
+1 602 282 6268  
AJ.Lydon@jll.com

**JOHN LYDON**  
Managing Director  
+1 602 282 6326  
John.Lydon@jll.com

**PAT HARLAN**  
Senior Managing Director  
+1 602 282 6298  
Pat.Harlan@jll.com

**HAGEN HYATT**  
Vice President  
+1 602 282 6275  
Hagen.Hyatt@jll.com

Although information has been obtained from sources deemed reliable, neither Owner nor JLL makes any guarantees, warranties or representations, express or implied, as to the completeness or accuracy as to the information contained herein. Any projections, opinions, assumptions or estimates used are for example only. There may be differences between projected and actual results, and those differences may be material. The Property may be withdrawn without notice. Neither Owner nor JLL accepts any liability for any loss or damage suffered by any party resulting from reliance on this information. If the recipient of this information has signed a confidentiality agreement regarding this matter, this information is subject to the terms of that agreement. ©2023. Jones Lang LaSalle IP, Inc. All rights reserved.

