



OFFICE SPACE IN PARK PLACE BUSINESS PARK FOR LEASE
PARK PLACE III

REDUCED RATE, MOTIVATED LANDLORD!



12000 W PARK PL., MILWAUKEE

PARK PLACE III



BUILDING SPECIFICATIONS

Building size:	37,820 s.f.
Available s.f.	9,285 s.f.
Max. contig.:	9,285 s.f.
Occupancy:	Immediate
Floors:	1
Building class:	A
Built / Renovated:	1985 / 1995
Parking:	3.65 / 1,000 s.f.
Signage:	Monument available
Lease rate:	<u>\$14.00 / s.f. Gross</u>



FEATURES

- Divisible to +/-4,000 SF
- 1 story, class A office building
- Park-like setting with beautiful views of pond
- Outdoor patio / seating area and additional green space
- Exceptional visibility from the freeway and the main Park Place corridor



FLOOR PLAN

Suite 300: 1,148 s.f.

Suite 100: 8,137 s.f.

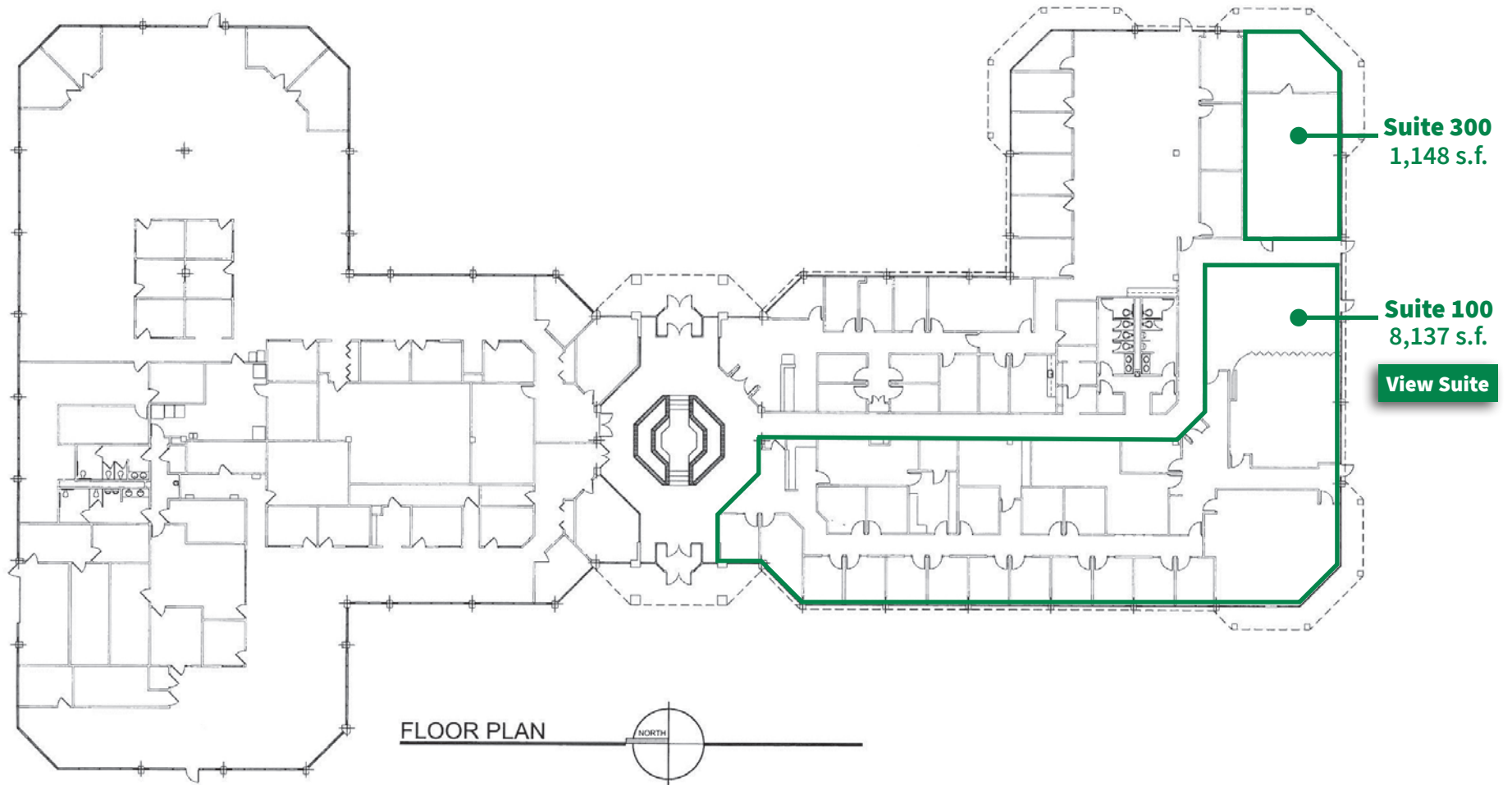



OFFICE SPACE IN PARK PLACE BUSINESS PARK FOR LEASE

PARK PLACE III

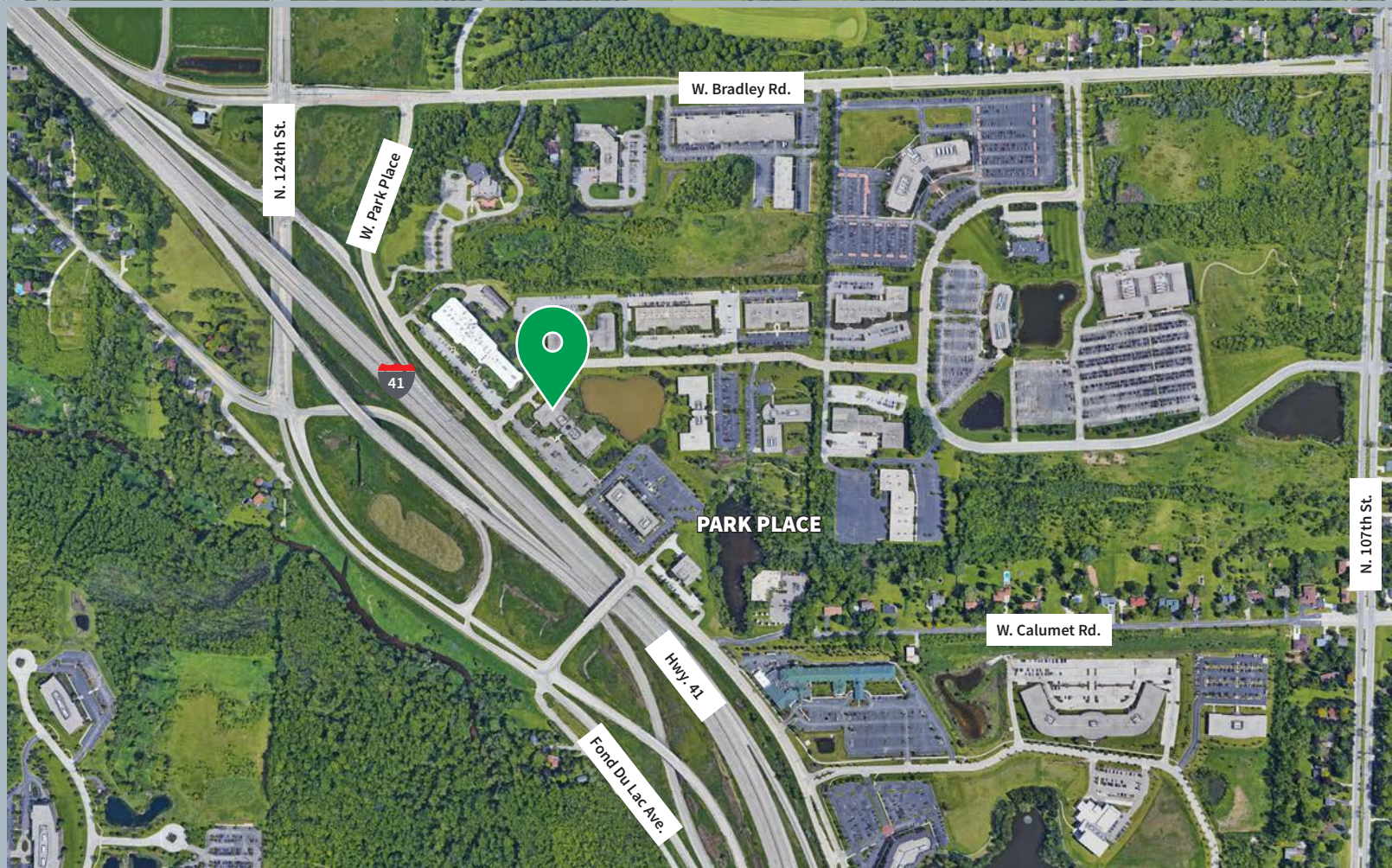

Nick Hepner
Vice President
direct + 1 414 944 2107
cell + 1 608 444 1675
nick.hepner@am.jll.com

James M. Young
Senior Vice President
direct + 1 414 944 2105
cell + 1 262 853 4002
james.young@am.jll.com