

# For Lease

±13,242 SF flex space available



Congleton Building 7

**8958 Bond St.**

Overland Park, Kansas

**Kevin Wilkerson**

+ 1 913 469 4601

kevin.wilkerson@jll.com

**Phil Algrim**

+ 1 913 469 4605

phil.algrim@jll.com

**Ben Cadenas**

+ 1 913 469 4609

ben.cadenas@jll.com

# Property specifications

Premises Size	±13,242 SF total ±500 SF office ±12,742 SF warehouse
Clear Height	18'
Dock Doors	3 Dock High 1 Drive In
Lease Rate	\$8.25 PSF Gross Industrial

## Aerial View



- Easy access to both I-35 and 69 Highway at 87<sup>th</sup> Street and 95<sup>th</sup> Street
- Abundant services nearby

# Floor Plan

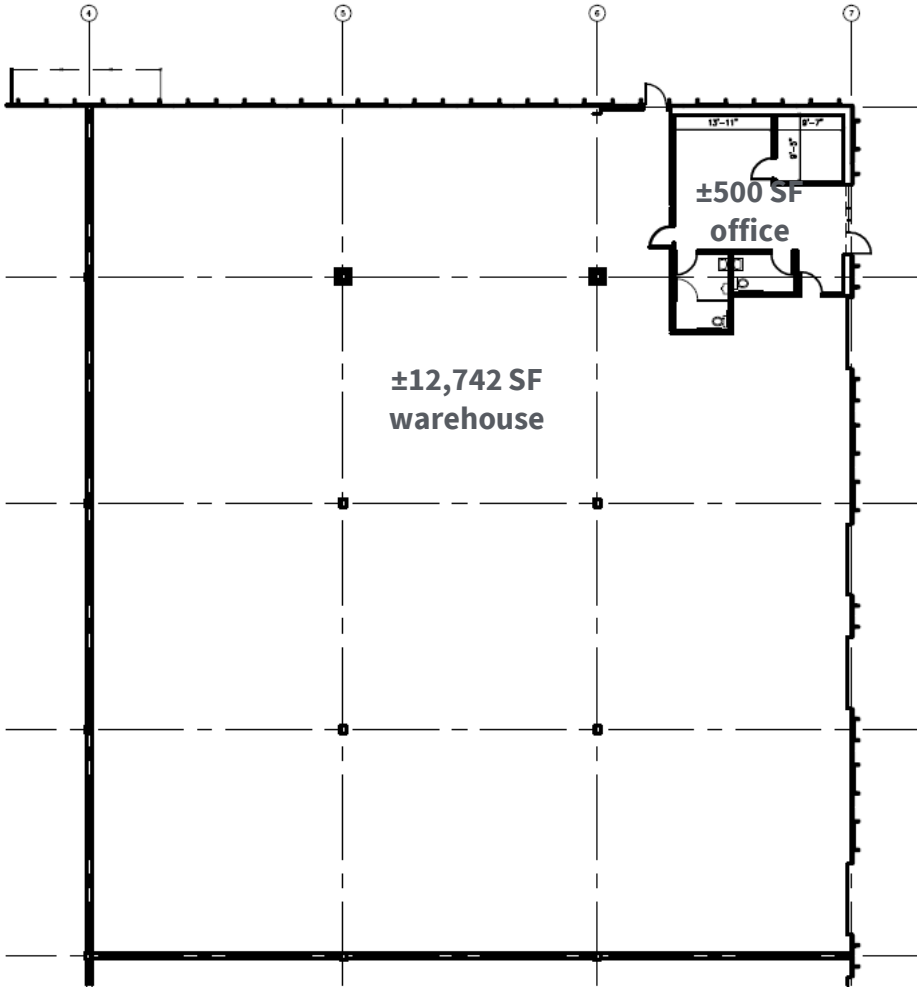

Although information has been obtained from sources deemed reliable, JLL does not make any guarantees, warranties or representations, express or implied, as to the completeness or accuracy as to the information contained herein. Any projections, opinions, assumptions or estimates used are for example only. There may be differences between projected and actual results, and those differences may be material. JLL does not accept any liability for any loss or damage suffered by any party resulting from reliance on this information. If the recipient of this information has signed a confidentiality agreement with JLL regarding this matter, this information is subject to the terms of that agreement. ©2024 Jones Lang LaSalle IP, Inc. All rights reserved.