



2038
CONCOURSE DR

LUNDY AVE

CONCOURSE DRIVE

For sublease

2038 Concourse Drive, Unit D, San Jose
10,232 RSF Available

Joel Yungen

RE License #01850588

M +1 724 288 5001

joel.yungen@jll.com

David Ross

RE License #02052598

M +1 415 450 8588

jdave.ross@jll.com



Jones Lang LaSalle Brokerage, Inc. Real Estate License #01856260

Sublease

Location	2038 Concourse Drive Unit D San Jose, CA
Type	Warehouse / Distribution
Size	10,232 SF
Loading	2 Docks / 1 Grade
Clear Height	18' - 20'
Availability	July 1, 2024
LED	2/28/2026
Pricing	Call for Pricing

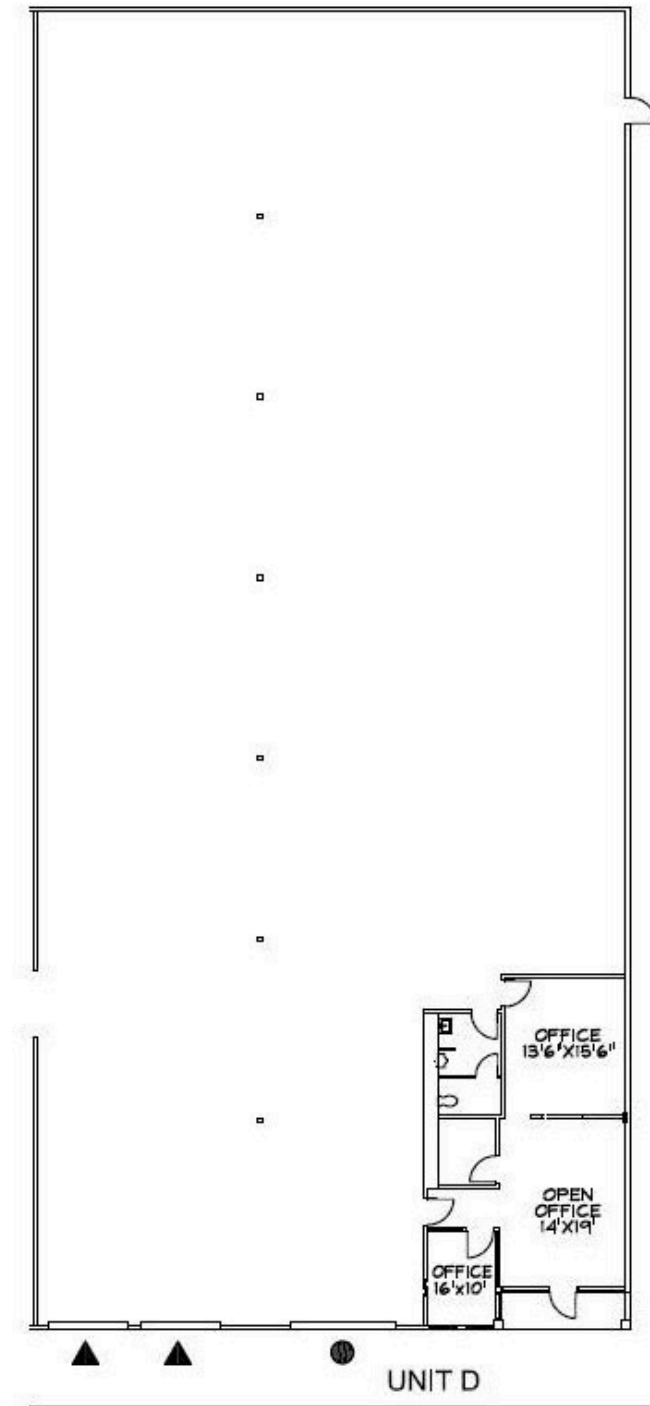

10,232
Square Feet

Joel Yungen

RE License #01850588

M +1 724 288 5001

joel.yungen@jll.com

David Ross

RE License #02052598

M +1 415 450 8588

jdave.ross@jll.com



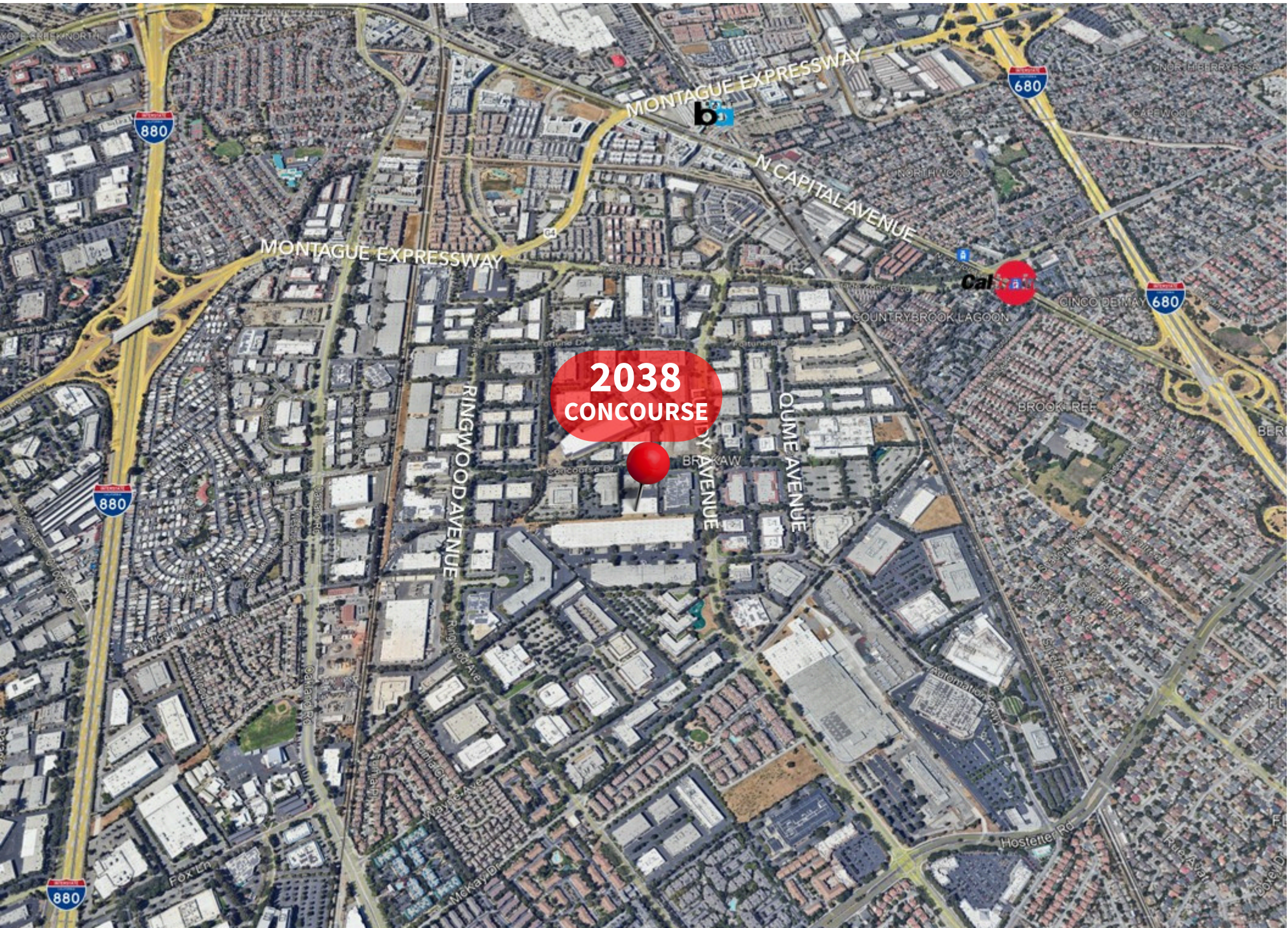



About JLL

For over 200 years, JLL (NYSE: JLL), a leading global commercial real estate and investment management company, has helped clients buy, build, occupy, manage and invest in a variety of commercial, industrial, hotel, residential and retail properties. A Fortune 500® company with annual revenue of \$20.9 billion and operations in over 80 countries around the world, our more than 103,000 employees bring the power of a global platform combined with local expertise. Driven by our purpose to shape the future of real estate for a better world, we help our clients, people and communities SEE A BRIGHTER WAYSM. JLL is the brand name, and a registered trademark, of Jones Lang LaSalle Incorporated. For further information, visit [jll.com](https://www.jll.com).

Joel Yungen

RE License #01850588
M +1 724 288 5001
joel.yungen@jll.com

David Ross

RE License #02052598
M +1 415 450 8588
jdave.ross@jll.com