

# 6750 Dumbarton Circle

Fremont, CA



## Full Building Sublease

**±118,535 RSF Available Now**

Flexible term through May 31, 2032



Jones Lang LaSalle Brokerage, Inc. License #01856260

# Highlights



**Full Building  
Opportunity  
±118,535 SF**



**Two  
floors**



**Available now  
through  
May 31, 2032**



**Furniture  
available**



**Bike  
storage**

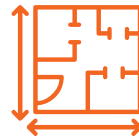

**Large All  
Hands  
Training  
Room**



**2 large  
breakrooms**



**High-end  
tech finishes  
throughout**



**On-site surface  
parking**



**EV Charging  
stations**



**Power -  
3500 amp /  
480 volt**



## 2 Stories of High-End Office









# Floorplan

## 1st Floor

±59,268 RSF

Highway 84

Dumbarton Circle

Lobby Entrance

- Break Area
- Building Core/Maintenance
- 3 Large Conference Rooms
- 18 Medium Conference Rooms
- 45 Small Conference Rooms
- Open Work Area - 340 Desks
- Lab Area



# Floorplan

## 2nd Floor

±59,266 RSF

Highway 84

Dumbarton Circle

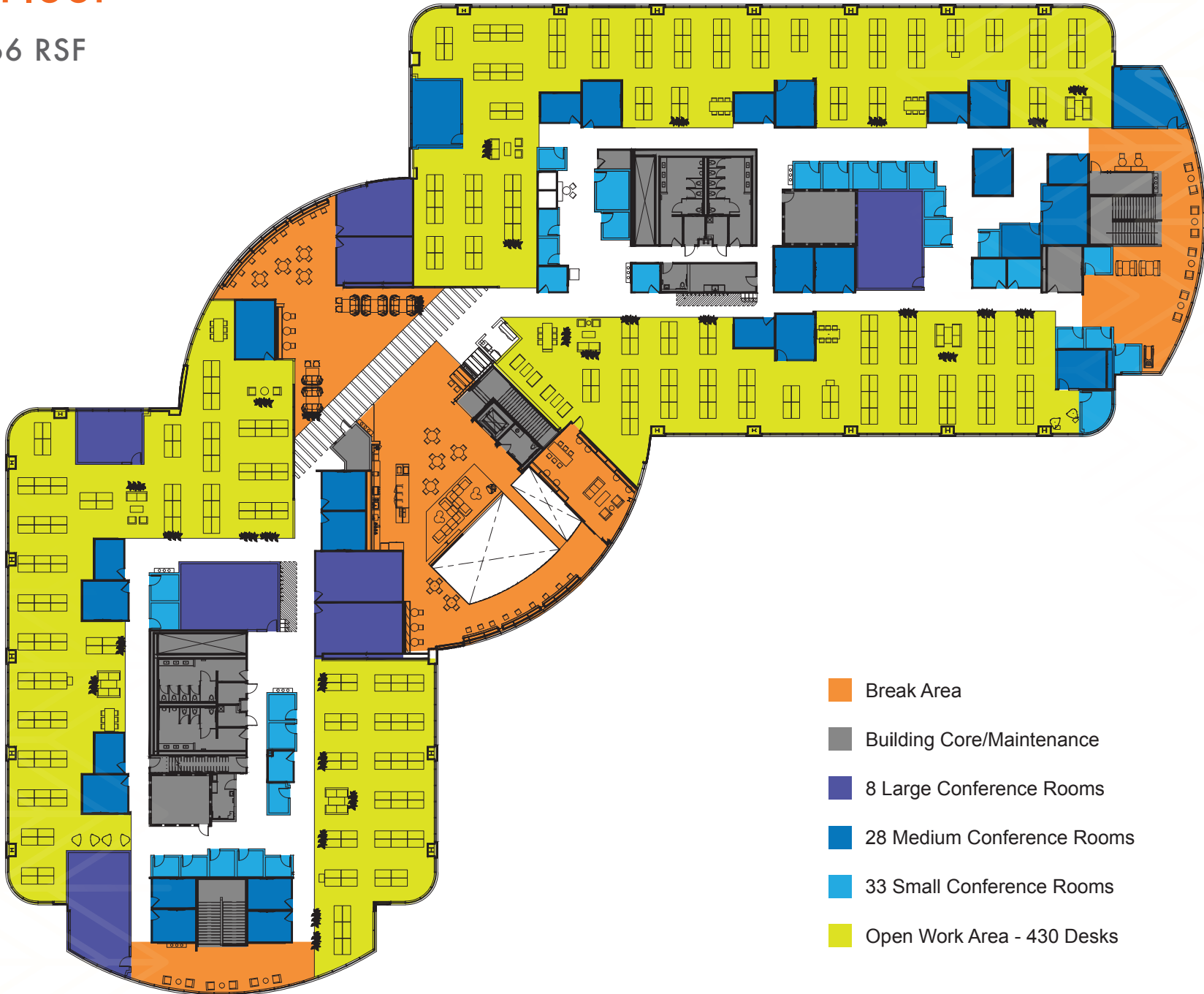

- Break Area
- Building Core/Maintenance
- 8 Large Conference Rooms
- 28 Medium Conference Rooms
- 33 Small Conference Rooms
- Open Work Area - 430 Desks



# Amenities & Neighbors



## AMENITIES

- |                                      |                                     |
|--------------------------------------|-------------------------------------|
| 1. Jack in the Box                   | 9. Aloft Silicon Valley             |
| 2. King of Thai Noodles House        | 10. Chipotle Mexican Grill          |
| 3. Rice and Spoon Vietnamese Cuisine | 11. Vitality Bowls Newark           |
| 4. Tasty Pot - Newark                | 12. Sprouts Farmers Market          |
| 5. Tramy's Restaurant                | 13. Safeway                         |
| 6. Pan Fried Dumplings               | 14. Starbucks                       |
| 7. Coyote Hills Regional Park        | 15. Courtyard by Marriott Newark SV |
| 8. Ardenwood Farmyard Cafe           |                                     |



# 6750 Dumbarton Circle

Fremont, CA



## MARK BODIE

*Senior Managing Director*

+1 650 480 2212

Mark.Bodie@jll.com

RE Lic#: 01941415

## TODD HUSAK

*Senior Managing Director*

+1 650 315 7865

Todd.Husak@jll.com

RE Lic#: 01785130

## TOSS VALLENTINE

*Senior Managing Director*

+1 650 480 2133

Toss.Vallentine@jll.com

RE Lic#: 01742629

## CLARISSA RICHARDSON

*Vice President*

+1 415 395 7299

Clarissa.Richardson@jll.com

RE Lic#: 02085310

Although information has been obtained from sources deemed reliable, neither Owner nor JLL makes any guarantees, warranties or representations, express or implied, as to the completeness or accuracy as to the information contained herein. Any projections, opinions, assumptions or estimates used are for example only. There may be differences between projected and actual results, and those differences may be material. The Property may be withdrawn without notice. Neither Owner nor JLL accepts any liability for any loss or damage suffered by any party resulting from reliance on this information. If the recipient of this information has signed a confidentiality agreement regarding this matter, this information is subject to the terms of that agreement. ©2024 Jones Lang LaSalle IP, Inc. All rights reserved.

