



For sublease

Industrial warehouse
for sublease available
in Grimes, Iowa

105,000 SF

Prairie Business Park III
4201 S James St. | Suite 240
Grimes, Iowa 50111

Property specifications

Total availability: 105,000 RSF

Lease rate: Call broker for price

Est. OPEX available upon request

Sublease expiration: 2/28/2027

- Highly visible from S James Street and SE 37th Street
- Dock doors: 7
- ESFR sprinklers
- Ample free parking
- Card access security
- Total building size: 300,000 SF

Contact broker for
additional information

jll.com/des-moines

Jones Lang LaSalle Brokerage, Inc.

Tanner Hedstrom

Vice President

+1 515 745 2734

tanner.hedstrom@jll.com

Austin Hedstrom, SIOR

Executive Vice President

+1 515 414 1767

austin.hedstrom@jll.com

Industrial warehouse for sublease

4201 S James St. | Grimes, Iowa 50111

105,000 SF

Floor plan

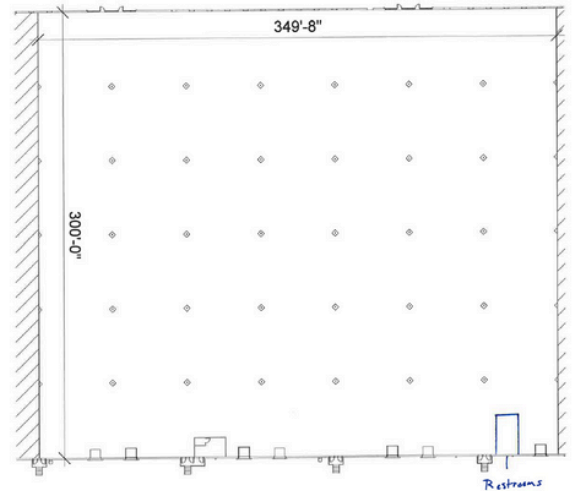

- Rear load facility
- 32' clear ceiling height
- 50' x 250' bays
- 50' x 50' column spacing
- 208 Volt, 1,200 Amp, 3-phase electrical service
- Located at the crossroads of I-80/I-35
- Convenient access to the expanded I-80, I-35 & Highway 141, offering an additional half diamond interchange at Meredith Drive



Tanner Hedstrom
tanner.hedstrom@jll.com

Austin Hedstrom
austin.hedstrom@jll.com

jll.com/des-moines

Although information has been obtained from sources deemed reliable, neither Owner nor JLL makes any guarantees, warranties or representations, express or implied, as to the completeness or accuracy as to the information contained herein. © 2024 Jones Lang LaSalle IP, Inc. All rights reserved.

