

# For Lease

## 11054 RED RUN BOULEVARD, OWINGS MILLS, MD

PAD SITE AVAILABLE!



For more information,  
please contact retail advisory:

**ANA HENRICH**  
Vice President, Retail  
443 465 4384  
[ana.henrich@jll.com](mailto:ana.henrich@jll.com)





# For Lease

# CLOSE UP AERIAL

11054 RED RUN BOULEVARD, OWINGS MILLS, MARYLAND



For more information,  
please contact retail advisory:

**ANA HENRICH**  
Vice President, Retail  
443 465 4384  
ana.henrich@jll.com



# For Lease

11054 RED RUN BOULEVARD,  
OWINGS MILLS, MARYLAND

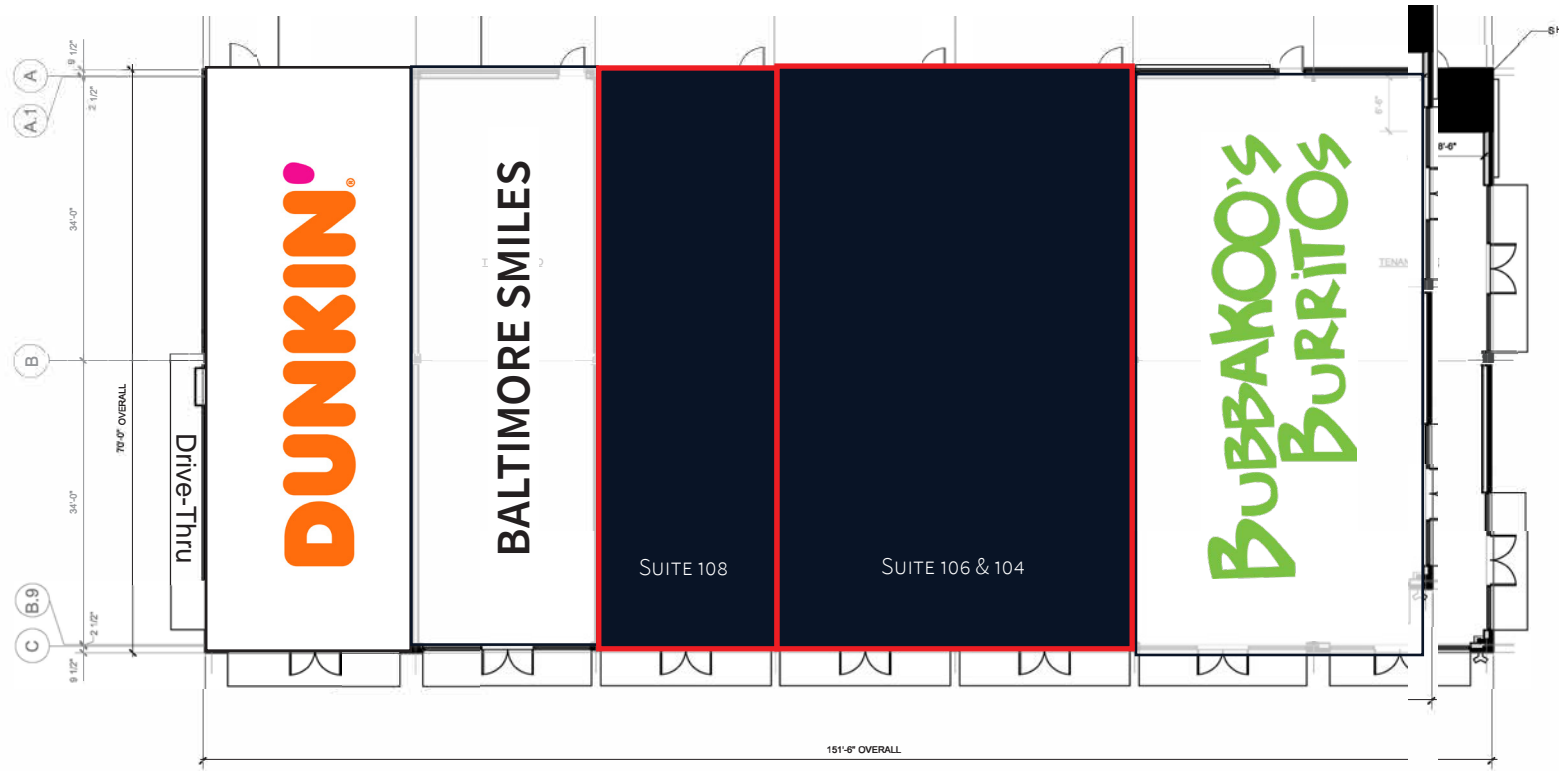

For more information,  
please contact retail advisory:

**ANA HENRICH**  
Vice President, Retail  
443 465 4384  
ana.henrich@jll.com





# For Lease

# AS-BUILT SITE PLAN

11054 RED RUN BOULEVARD, OWINGS MILLS, MARYLAND

## RETAIL AVAILABLE SPACES

- +/- 1 ACRE PAD SITE
- SUITE 108: +/- 1,500 SF
- SUITE 106 & 104: +/- 3,451 SF

## TRAFFIC COUNTS

- 16,067 ADT (RED RUN BLVD.)

## PROPERTY HIGHLIGHT

Come join **Dunkin Donuts**, and **Baltimore Smiles** at **Red Run Station**, a beautiful, new retail development located in the heart of the Owings Mills Business District. There are six tenant spaces available ranging from 1,400 to 6,071 square feet, which could include restaurants and/or small businesses. Red Run Station is within close proximity to surrounding residential and commercial communities and offers ample, well-lit, free parking.

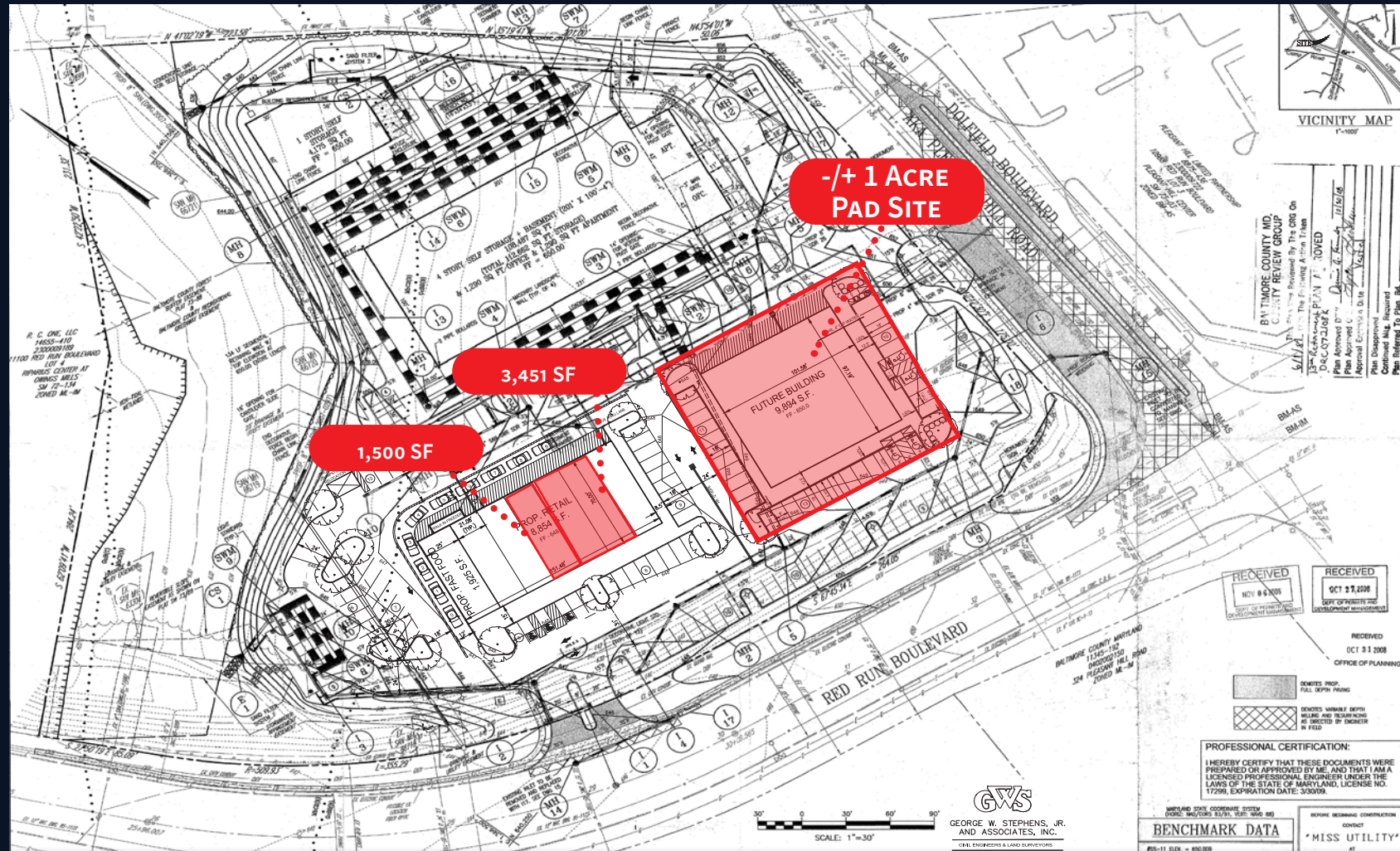

For more information,  
please contact retail advisory:

**ANA HENRICH**  
Vice President, Retail  
443 465 4384  
ana.henrich@jll.com





# For Lease

## LOCATION & DEMOGRAPHICS

11054 RED RUN BOULEVARD, OWINGS MILLS, MARYLAND

### POPULATION

1 MILE	3 MILES	5 MILES
■ 7,008	■ 82,339	■ 141,217

### HOUSEHOLD INCOME - AVERAGE

1 MILE	3 MILES	5 MILES
■ \$87,411	■ \$85,894	■ \$88,521

### HOUSEHOLD SIZE

1 MILE	3 MILES	5 MILES
■ 2,821	■ 32,158	■ 55,122

### EMPLOYMENT

1 MILE	3 MILES	5 MILES
■ 3,669	■ 44,534	■ 73,549

### MEDIAN AGE

1 MILE	3 MILES	5 MILES
■ 37	■ 37	■ 39



For more information,  
please contact retail advisory:

**ANA HENRICH**  
Vice President, Retail  
443 465 4384  
ana.henrich@jll.com





# For Lease

For more information, please contact retail advisory:

**ANA HENRICH**

Vice President, Retail

443 465 4384

[ana.henrich@jll.com](mailto:ana.henrich@jll.com)

