



For lease

**1501 S Pennsylvania Avenue
Morrisville, PA**

Industrial Outdoor Storage

±8,253 SF Service Facility

3.8 Acres

Site Plan

Property Highlights

- Site Size: 3.8 acres
- Building Size: ±8,253 SF
- Zoning: Industrial (RD-1)
- Fenced, lit and graveled
- Under new, professional ownership
- Dedicated employee/visitor parking





Building Plan

Building Highlights

- ±8,253 SF
- Six (6) drive-in doors (12'x 15')
- Drive-thru accessibility
- 17' clear height
- Bi-level office space

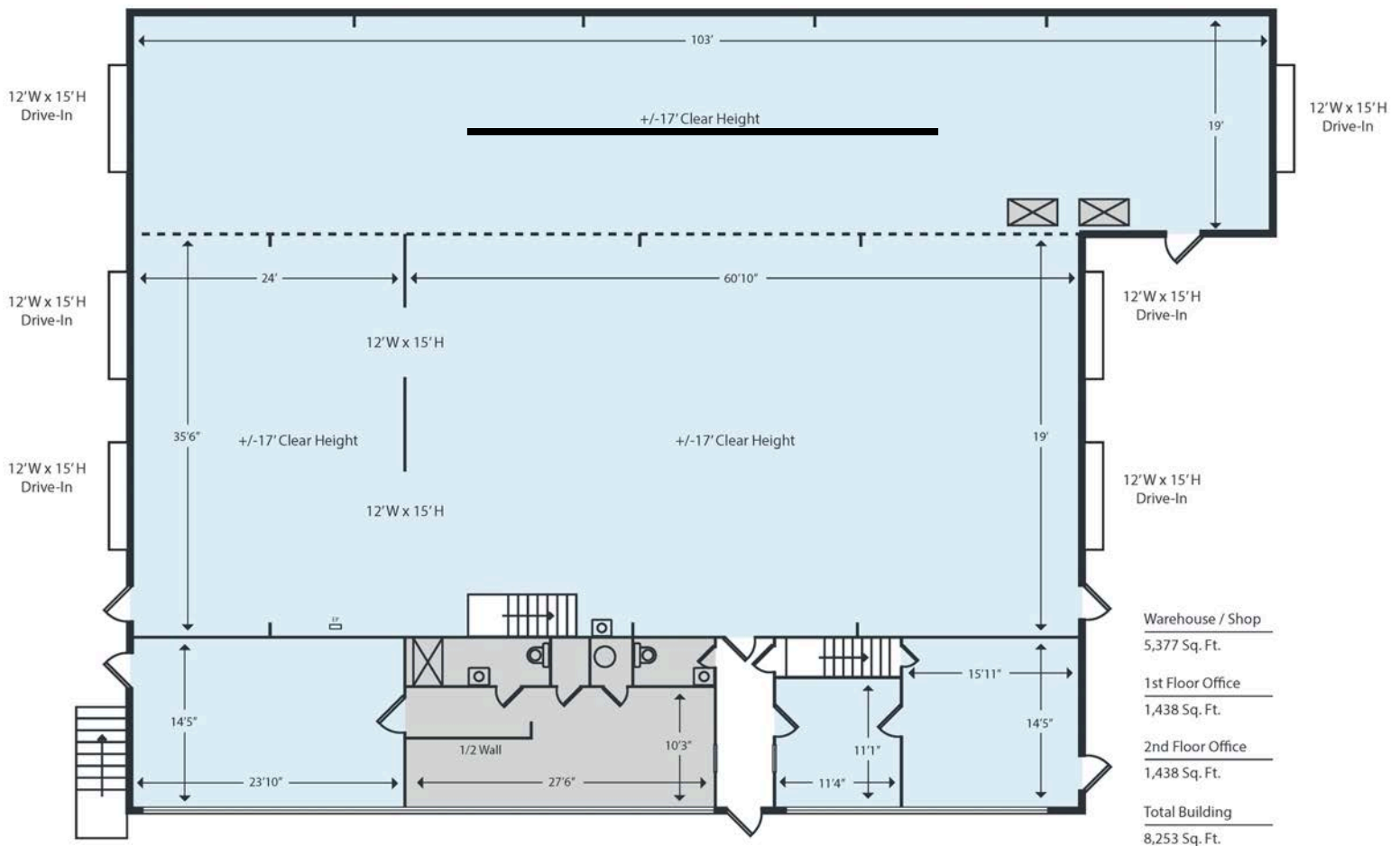

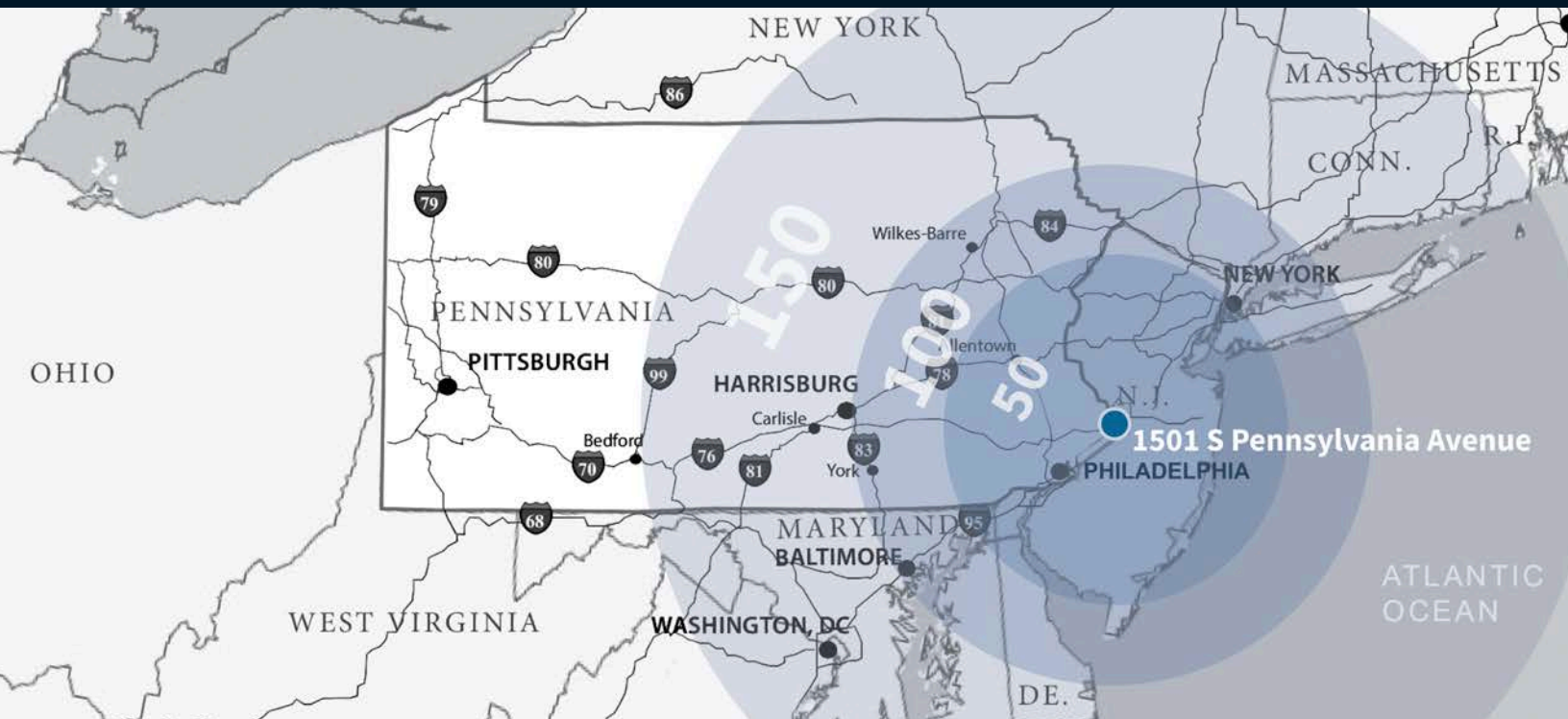

1501 S Pennsylvania Avenue

MORRISVILLE, PA

DISTANCES TO CITIES

	Distance (mi)	Drive Time (hrs)
Philadelphia, PA	32	40 min.
New York, NY	67	1 hr 10 min.
Baltimore, MD	130	2 hr. 10 min.
Washington, DC	168	2 hr. 50 min.
Boston, MA	280	4 hr. 20 min.

DISTANCES TO PORTS

Port of Philadelphia	28	30 min.
Port of Wilmington	61	1 hr. 2 min.
Ports of NY/NJ	63	1 hr 5 min.
Port of Baltimore	134	2 hr. 10 min.

- 11.5 million population within a 50-mile radius
- 639,324 labor force within a 30-minute drive time
- Efficient access to Route 1, Pennsylvania Turnpike, I-95, & NJ Turnpike
- Proximity to large industrial pockets in PA & NJ

DISTANCE TO AIRPORT

Philadelphia Airport	41	40 min.
JFK Airport	79	1 hr. 25 min.

DISTANCE TO INTERMODAL

Norfolk Southern Morrisville	8	14 min.
CSX Philadelphia	36	35 min.

Mitch Russell
mitch.russell@jll.com
+1 610 249 2274

Kyle Lockard
kyle.lockard@jll.com
+1 610 249 2299

Larry Maister
larry.maister@jll.com
+1 610 249 2297

jll.com

Although information has been obtained from sources deemed reliable, neither Owner nor JLL makes any guarantees, warranties or representations, express or implied, as to the completeness or accuracy as to the information contained herein. Any projections, opinions, assumptions or estimates used are for example only. There may be differences between projected and actual results, and those differences may be material. The Property may be withdrawn without notice. Neither Owner nor JLL accepts any liability for any loss or damage suffered by any party resulting from reliance on this information. If the recipient of this information has signed a confidentiality agreement regarding this matter, this information is subject to the terms of that agreement. ©2024. Jones Lang LaSalle IP, Inc. All rights reserved.