

# For lease

Parkway Place 1 & 2  
Jacksonville, FL 32216



**Ross Crabtree**

Executive Vice President  
ross.crabtree@jll.com  
+1 904 559 3915

**Mack Keasler**

Senior Associate  
mack.keasler@jll.com  
+1 904 559 3902

**Luke Pope, SIOR**

Executive Managing Director  
luke.pope@jll.com  
+1 904 356 4550



# About Parkway Place

- Two single story buildings built in 1986
- Zoned IBP-2
- 7.0/1,000 s.f. parking ratio
- Convenient to I-95 and Butler Blvd.
- Easy access to Southpoint area amenities
- 13' clear height
- Grade level access



## Parkway Place 1

**6680 Southpoint Pkwy.**

**56,460 s.f. available**

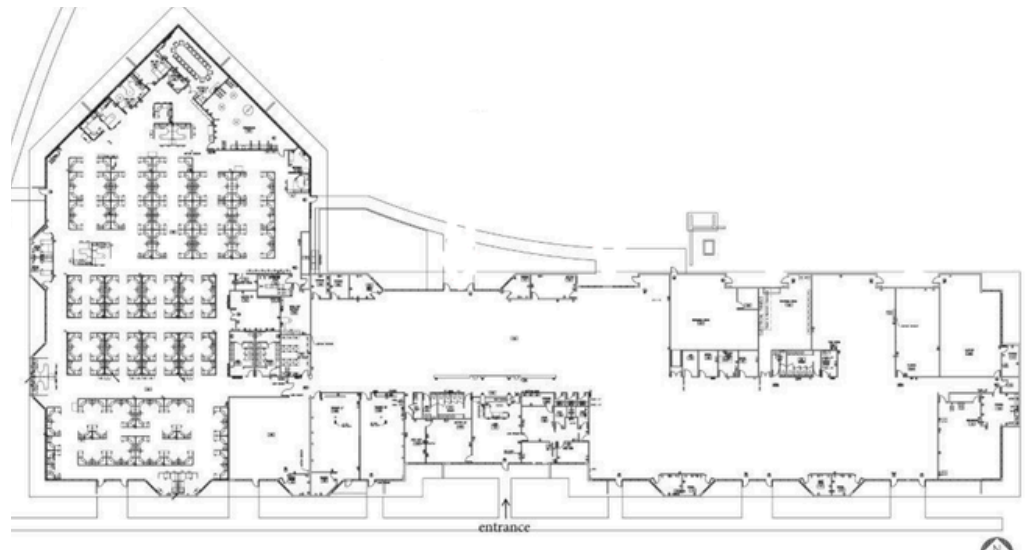

## Parkway Place 2

**6700 Southpoint Pkwy.**

**Ste. 100 - 4,000 - 13,923 s.f. available**

**Ste. 500 - 11,491 s.f. available**

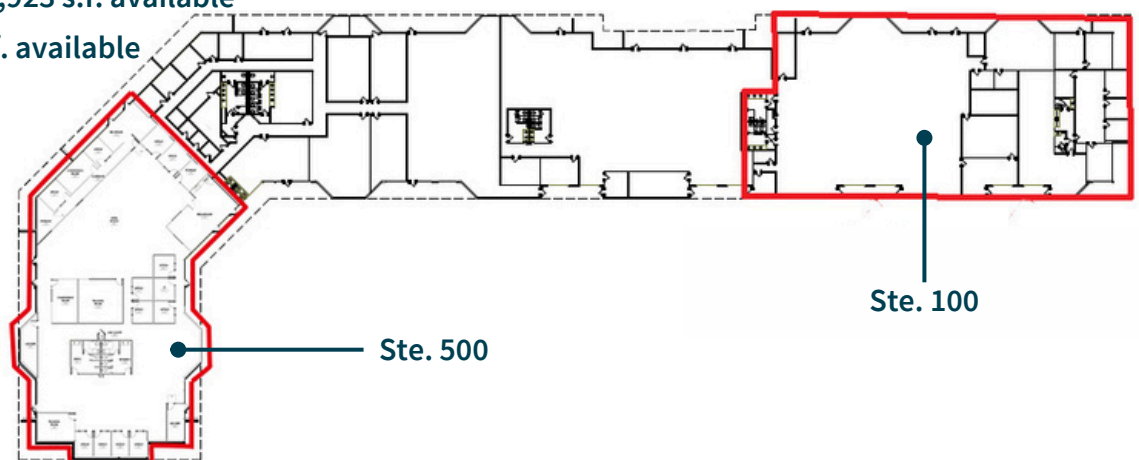



# Parkway Place

Convenient Southside location

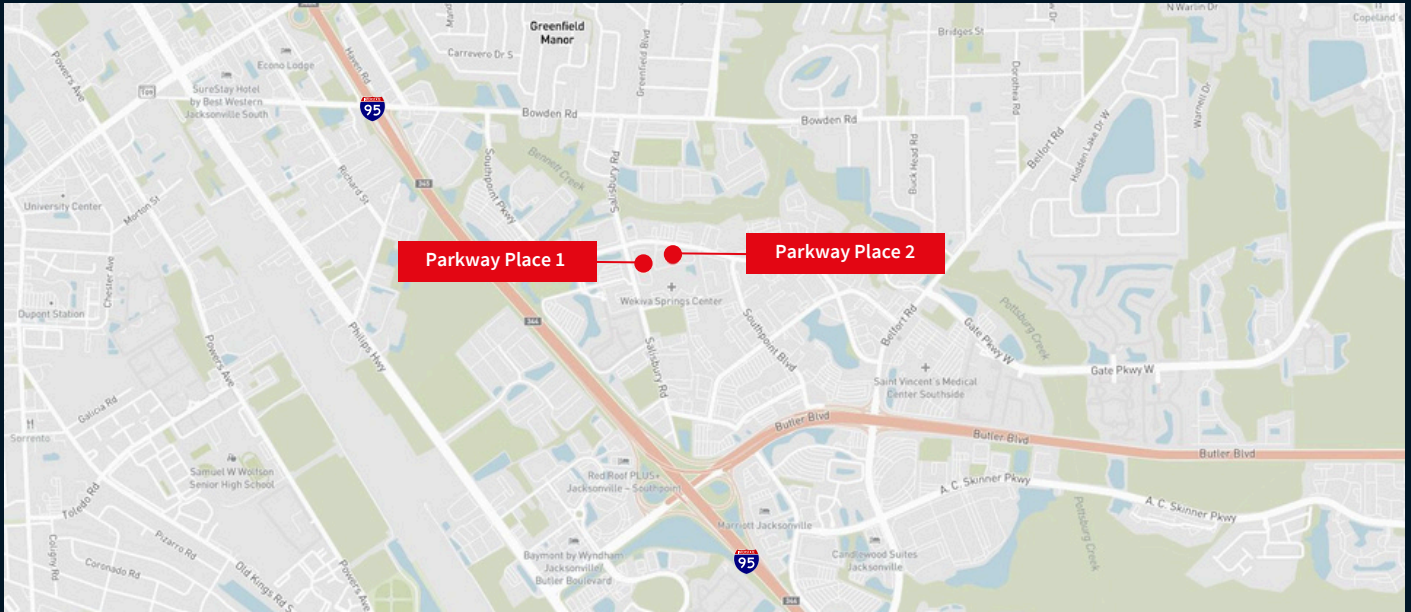

- Centrally located at the intersection of I-95, US-1 and Butler Blvd.
- Part of Southpoint Business Park
- Frontage on Southpoint Pkwy.
- Quick access to all major roadways including Butler Blvd., US-1 and I-95
- Easy access to Southpoint area amenities

**Ross Crabtree**  
Executive Vice President  
ross.crabtree@jll.com  
+1 904 559 3915

**Mack Keasler**  
Senior Associate  
mack.keasler@jll.com  
+1 904 559 3902

**Luke Pope, SIOR**  
Executive Managing Director  
luke.pope@jll.com  
+1 904 356 4550