

Kenton House

695 Grand Ave, St. Paul, MN 55105



Sara Martin

sara.martin@jll.com

612 209 8271

Zac Hoang

zac.hoang@jll.com

612 217 5156



Property highlights

- Last available vacancy
- New construction mixed-use project
- 80 units of luxury apartments including 6 signature penthouse units above retail
- Join locally loved tenants Emmett's Public House and Saji-ya Sushi, as well as a soon-to-be-announced anchor corner tenant
- Strong neighborhood retail shopping along Grand Ave

Site information

Location: 695 Grand Ave, St. Paul, MN 55105

Description: 150,000 SF New Construction Mixed-Use

Traffic counts

Grand Ave: 11,100 vpd

Summit Ave: 11,500 vpd

** Source: PlacerAI 2022 Study Averages*

Availability

Suite 4: 1,055 SF

Demographics

Radius	1 Mile	3 Mile	5 Mile
Population	25,818	171,405	368,381
Median HH Income	\$72,121	\$69,960	\$69,097
Average HH Income	\$115,584	\$106,271	\$102,251

** Source: 2023 Esri Forecasts based on The Census 2000 and 2010 data converted by Esri into 2020 geography*

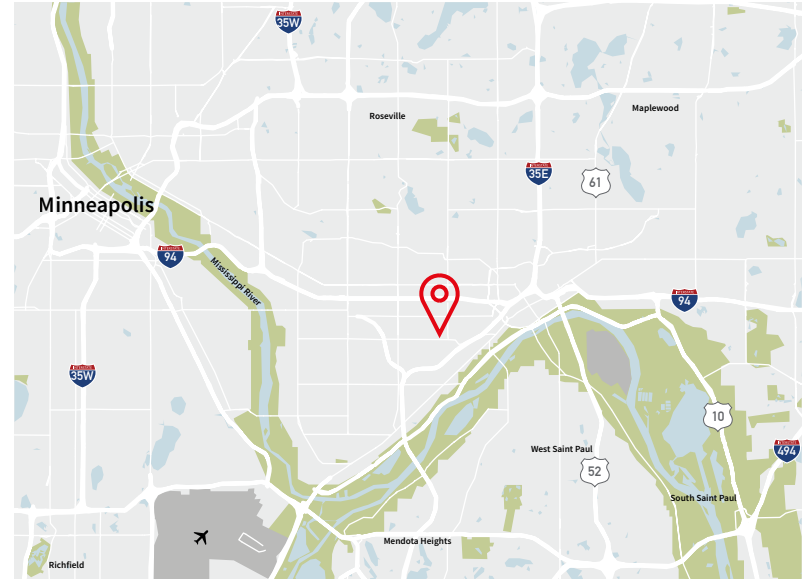

Nearby Tenants



Site plan

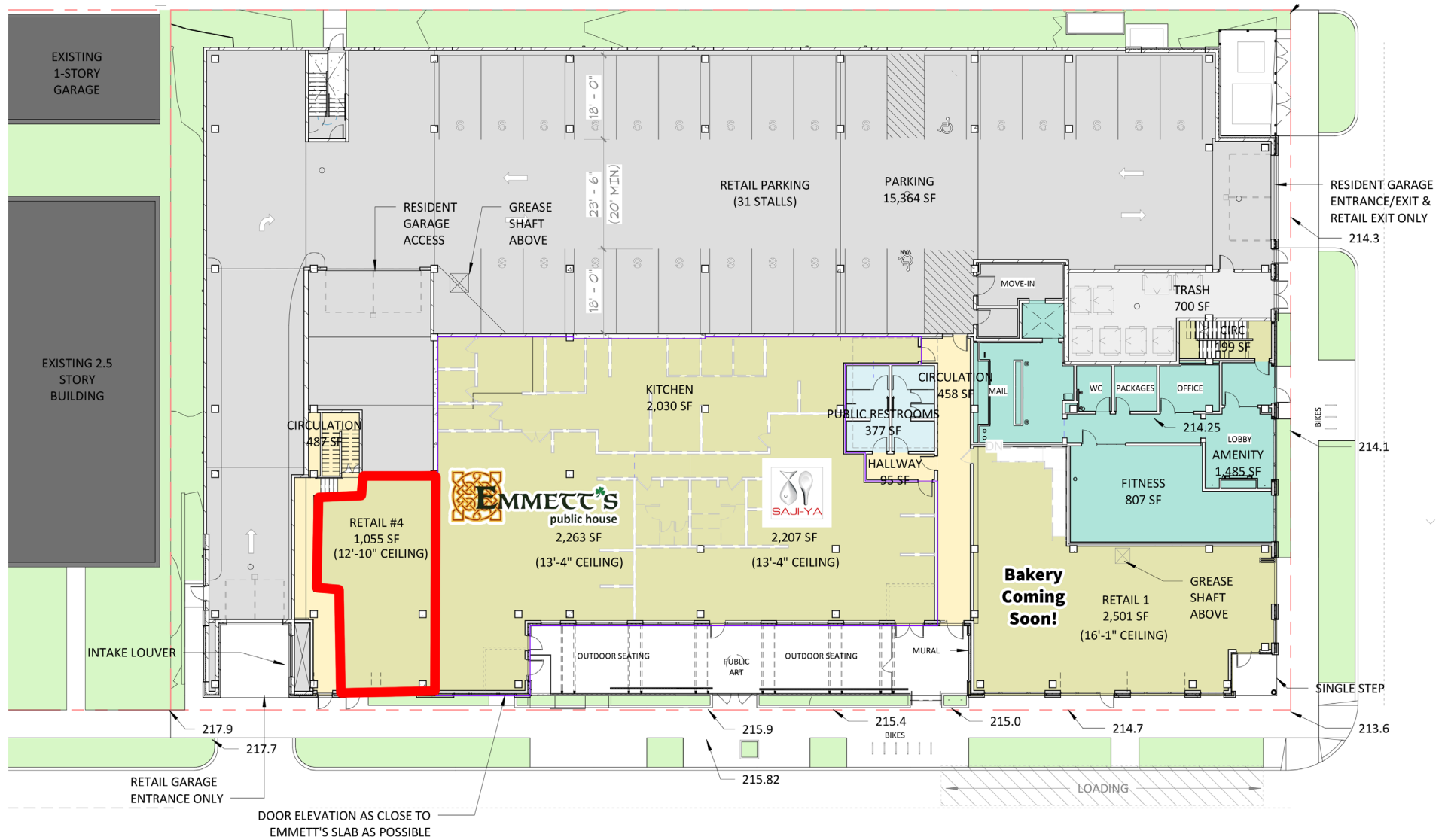

Trade area

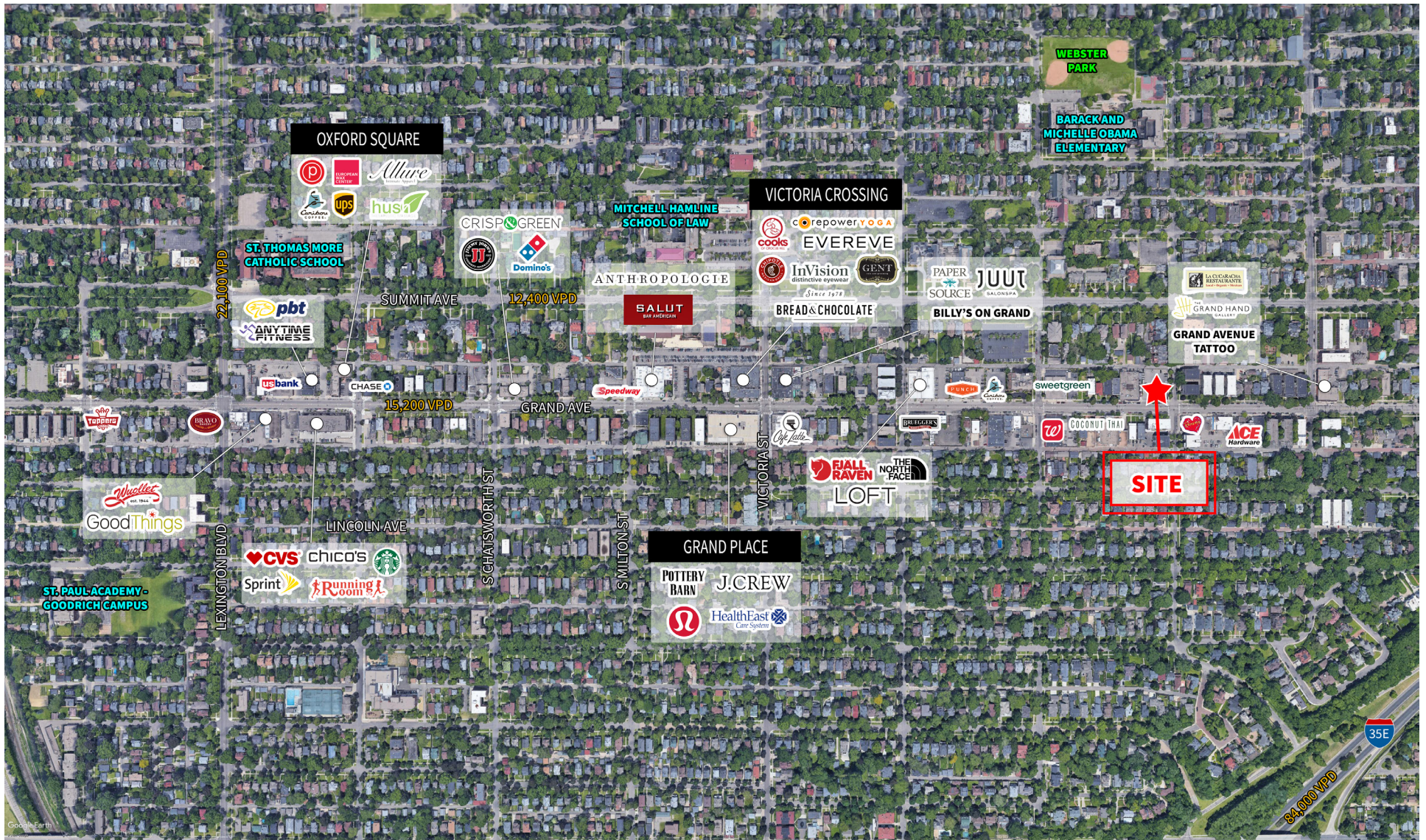

Contact us

Sara Martin

sara.martin@jll.com

612 209 8271

Zac Hoang

zac.hoang@jll.com

612 217 5156



© 2022 Jones Lang LaSalle IP, Inc. All rights reserved. The information contained in this document is proprietary to JLL and shall be used solely for the purposes of evaluating this proposal. All such documentation and information remains the property of JLL and shall be kept confidential. Reproduction of any part of this document is authorized only to the extent necessary for its evaluation. It is not to be shown to any third party without the prior written authorization of JLL. All information contained herein is from sources deemed reliable; however, no representation or warranty is made as to the accuracy thereof.

