



carmel
CORPORATE PLAZA

15015 AVENUE OF SCIENCE





84,789 SF
CLASS A OFFICE
IN CARMEL MOUNTAIN RANCH

carmel

CORPORATE PLAZA

High visibility corner location with monument signage opportunity on corner of Avenue of Science and Rancho Carmel Drive

Total building size is approximately 84,789 s.f.

Mix of prime offices and large bullpen areas for cubicles

Unusually large amount of glass line providing spectacular natural light

Entire building features 11' interior ceiling height

Parking ratio: 3.1/1,000 s.f. leased and abundant on street parking available

FLEXIBILITY





15015 AVENUE OF SCIENCE | SUITE 200B | FUTURE SPEC WORK - TO BE COMPLETED

- 9,483 SF
- 4 Offices
- Huddle Room
- Large Conference Room
- Small Conference Room
- Data/IT Room(s)
- Storage Room
- Copy/Print Room
- 5 Phone Booths
- Breakroom
- Open space for 49 6'x6' cubes

Asking Rate: \$2.60/sf + Electric

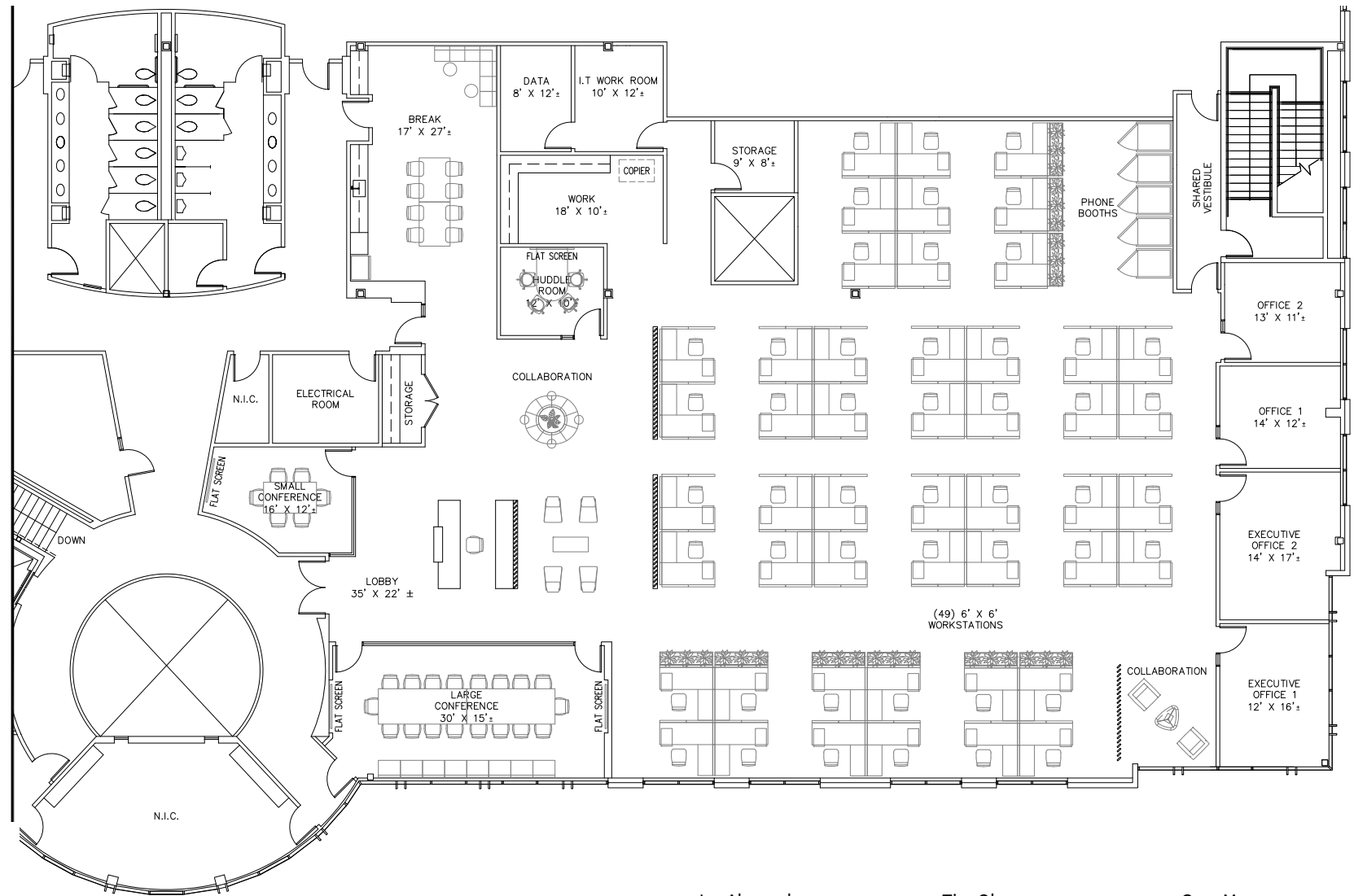

Jay Alexander
tel +1 858 410 1188
jay.alexander@jll.com
RE license #01019910

Tim Olson
tel +1 858 410 1253
tim.olson@jll.com
RE license #01364117

Greg Moore
tel +1 858 410 6367
greg.moore@jll.com
RE license #02068852



Carmel Mountain Road

Innovation Drive

Rancho Carmel Drive

Avenue of Science

Direct I-15 freeway access via Camino Del Norte and Carmel Mountain Road

High profile corner location directly across the street from over 1 million s.f. of retail amenities

Ideal location in San Diego County's premier corporate market with neighbors that include: BAE, Hewlett Packard, Northrop Grumman, Cymer, General Atomics and many others

carmel

CORPORATE PLAZA

① Carmel Mountain Plaza

- Pacific Theatres
- Target
- Marshalls
- In-N-Out

② Shops @ Costco Plaza

- Costco
- Claim Jumper
- Islands Restaurant

③ Carmel Mountain Ranch Town Center

- Ralphs
- Rite-Aid
- Bank of America

④ Carmel Courtyard

- California Pizza Kitchen
- Borders
- Staples

⑤ Hotels and resorts

- Double Tree Golf & Tennis Resort
- Residence Inn

⑥ Staybridge Suites

Although information has been obtained from sources deemed reliable, neither Owner nor JLL makes any guarantees, warranties or representations, express or implied, as to the completeness or accuracy as to the information contained herein. Any projections, opinions, assumptions or estimates used are for example only. There may be differences between projected and actual results, and those differences may be material. The Property may be withdrawn without notice. Neither Owner nor JLL accepts any liability for any loss or damage suffered by any party resulting from reliance on this information. If the recipient of this information has signed a confidentiality agreement regarding this matter, this information is subject to the terms of that agreement. ©2024.Jones Lang LaSalle IP, Inc. All rights reserved.



carmel
CORPORATE PLAZA

15015 AVENUE OF SCIENCE



Jay Alexander
tel +1 858 410 1188
jay.alexander@jll.com
RE license #01019910

Tim Olson
tel +1 858 410 1253
tim.olson@jll.com
RE license #01364117

Greg Moore
tel +1 858 410 6367
greg.moore@jll.com
RE license #02068852