



FOR SUBLEASE

839 Elkridge Landing
Linthicum, MD 21090

Brad Crosley

Senior Managing Director

brad.crosley@jll.com

410-299-4225

Overview

- 3rd floor: 11,637 RSF (turnkey Top Secret Collateral)
- Lower Level: 4,805 RSF (unfinished)
- Term Through: October 31, 2026 or a longer term is available directly with the landlord
- Rate: negotiable
- Furniture and equipment can be made available

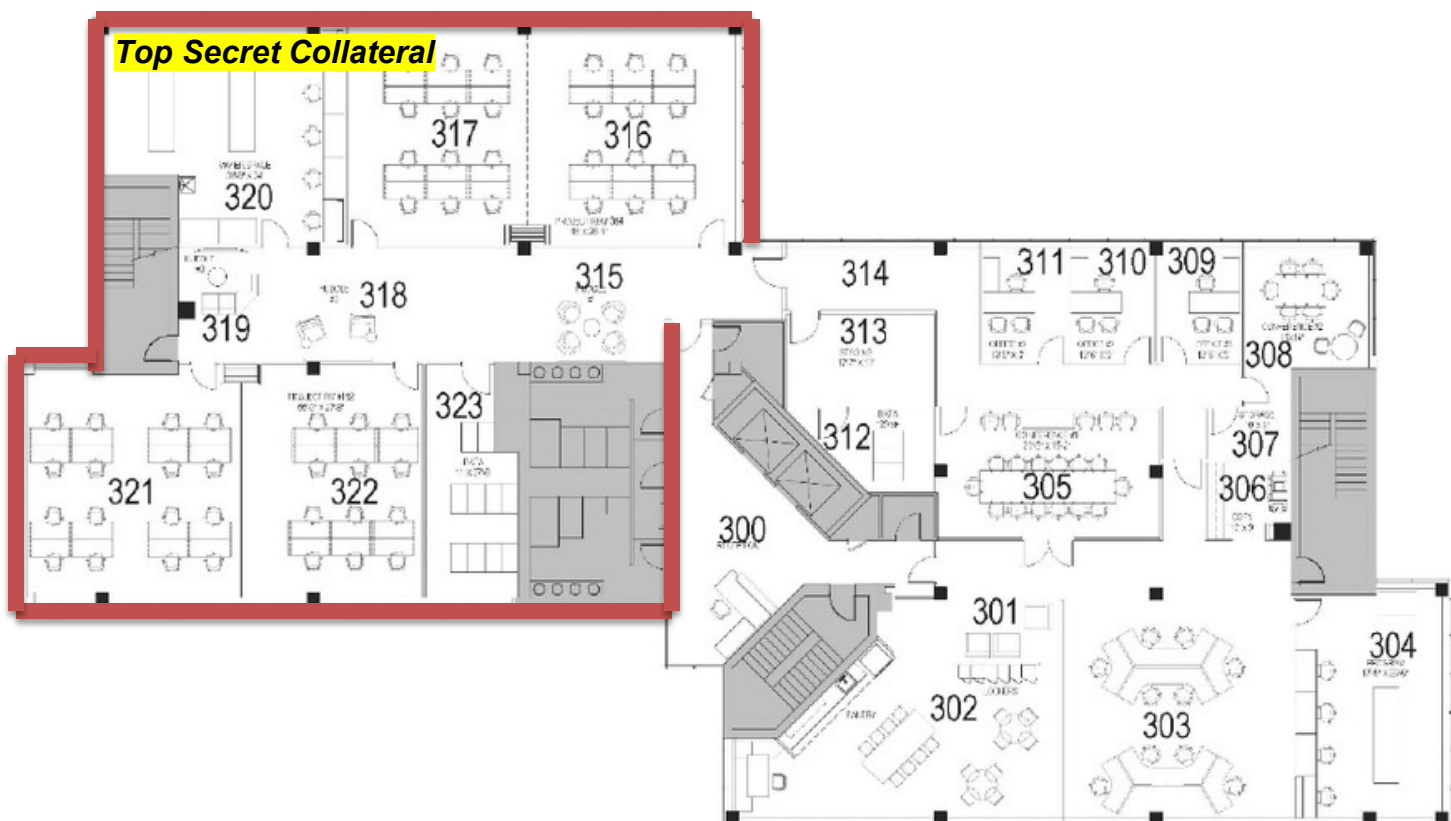



Brad Crosley

Senior Managing Director

brad.crosley@jll.com

410-299-4225