



MEADOWLANDS INDUSTRIAL PORTFOLIO

Owned by institutional investors advised by
J.P. Morgan Asset Management



57,678 S.F. Available

AVAILABLE FOR LEASE

25 E Union Avenue,
East Rutherford, NJ

Building Specifications:

Building Size:	135,498 s.f.
Total Available:	57,678 s.f.
Office / Showroom Size:	7,400 s.f.
Ceiling Height:	17'
Loading:	7 loading docks
Column Spacing:	25' x 30'
Sprinkler:	Wet
Available:	Immediately

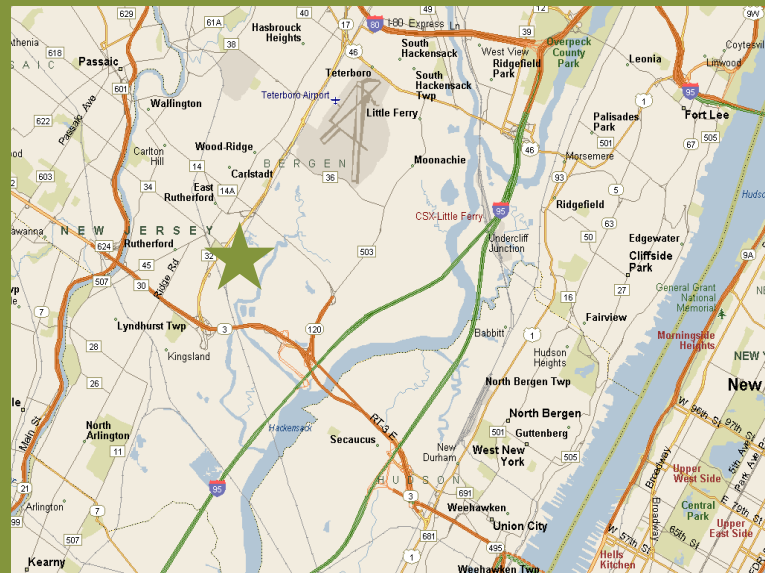

Contact:

David E. Knee, SIOR
Vice Chairman
+1 201 528 4440
david.knee@jll.com

Harold Imperatore
Senior Vice President
+1 908 938 0865
harold.imperatore@jll.com

Michael Palmeri
Senior Vice President
+1 908 361 2461
michael.palmeri@jll.com



Floor Plan

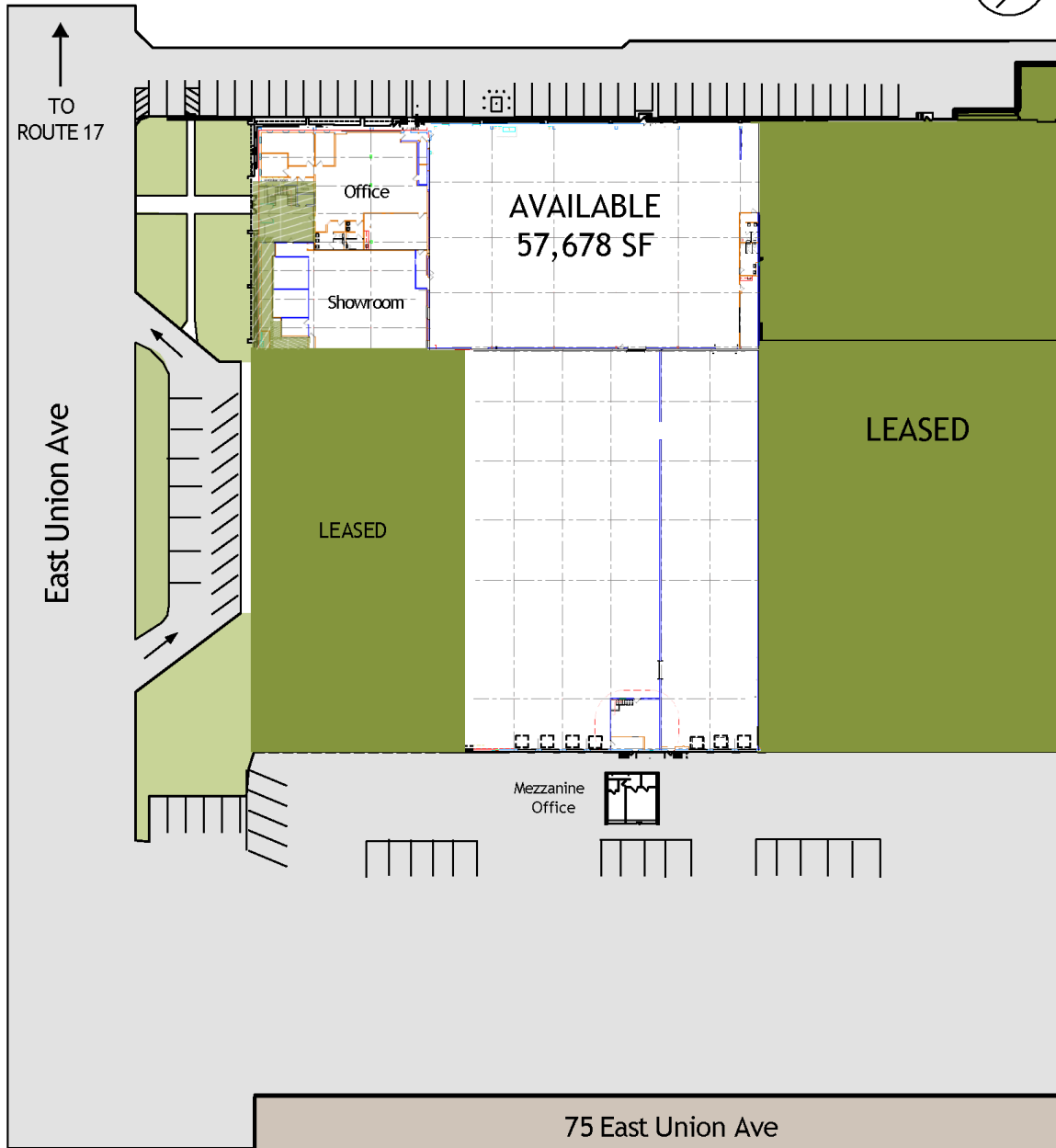

25 E Union Avenue,
East Rutherford, NJ



Contact:

David E. Knee, SIOR
Vice Chairman
+1 201 528 4440
david.knee@jll.com

Harold Imperatore
Senior Vice President
+1 908 938 0865
harold.imperatore@jll.com

Michael Palmeri
Senior Vice President
+1 908 361 2461
michael.palmeri@jll.com



©2016 Jones Lang LaSalle IP, Inc. All rights reserved. All information contained herein is from sources deemed reliable; however, no representation or warranty is made to the accuracy thereof.