

Slabtown Center Sublease



For Sublease

Partial to Full 4th Floor | 10,000-40,912 SF
2055 NW Savier St

FOR LEASING INFORMATION:

Eric Turner

Licensed in OR & WA

+1 503 546 3670

eric.turner@jll.com

Candace Lounsbury

Licensed in OR & WA

+1 503 937 2131

candace.lounsbury@jll.com

The Space

- Full 4th floor available, with flexibility to demise as small as 10,000 SF
- Views of Forest Park, Slabtown, and downtown Portland
- Ample open-office area along window lines - current total desk count of 265
- Direct secure-access elevators on both sides of building
- Total of 19 private offices and huddles, including a large corner executive suite
- 8 medium conference rooms - 4 with folding wall systems to combine into 2 large rooms - large training room, and 2 teaming rooms
- Large kitchen with double refrigerators
- Term available through September 2029
- A minimum of 1.5/1,000 parking





Building Amenities

- Newly renovated lobbies with concierge
- Fitness center with showers & lockers
- Tenant lounge, board room and medium conference room
- Bike hub
- Located in the heart of vibrant Slabtown, near tons of restaurants, cafes, new housing development, and shopping
- Easy access to downtown and I-405
- Direct availability on floors 2 & 3 can allow up to 121,213 SF of contiguous office space



Floor 4 | 40,912 RSF – can demise as small as 10,000 RSF

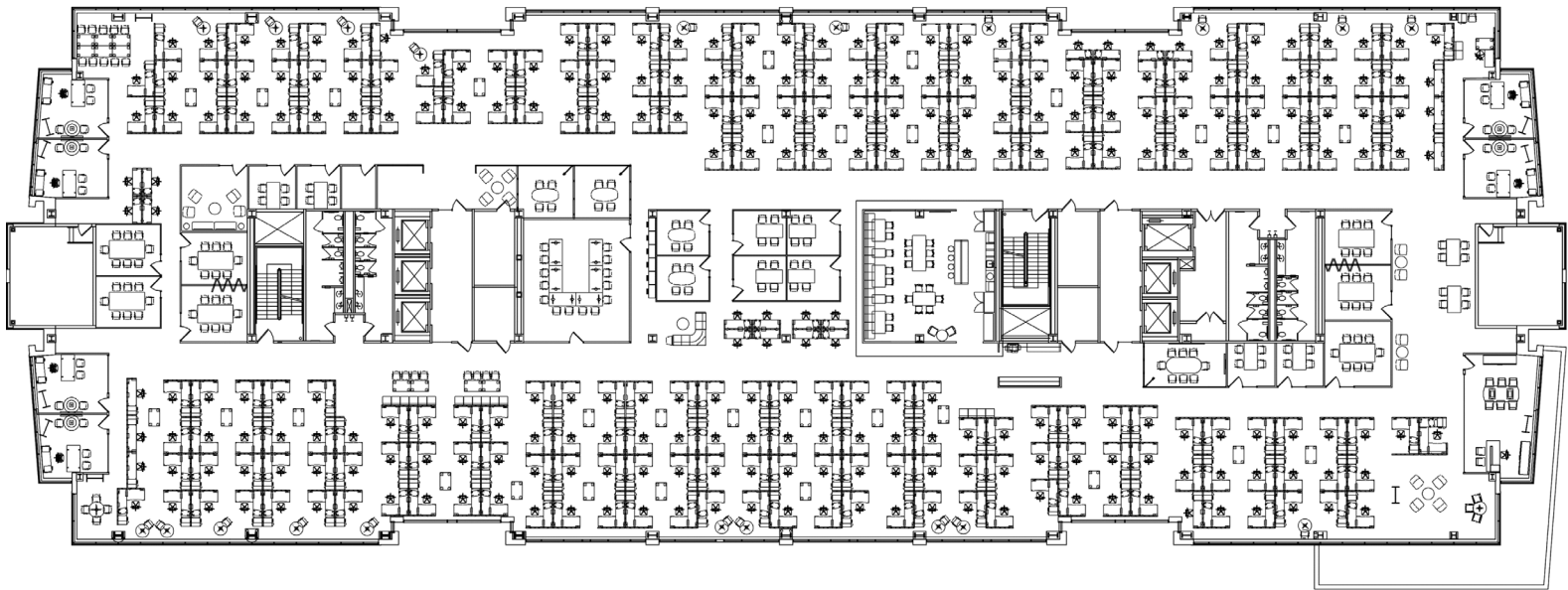

Nearby Amenities

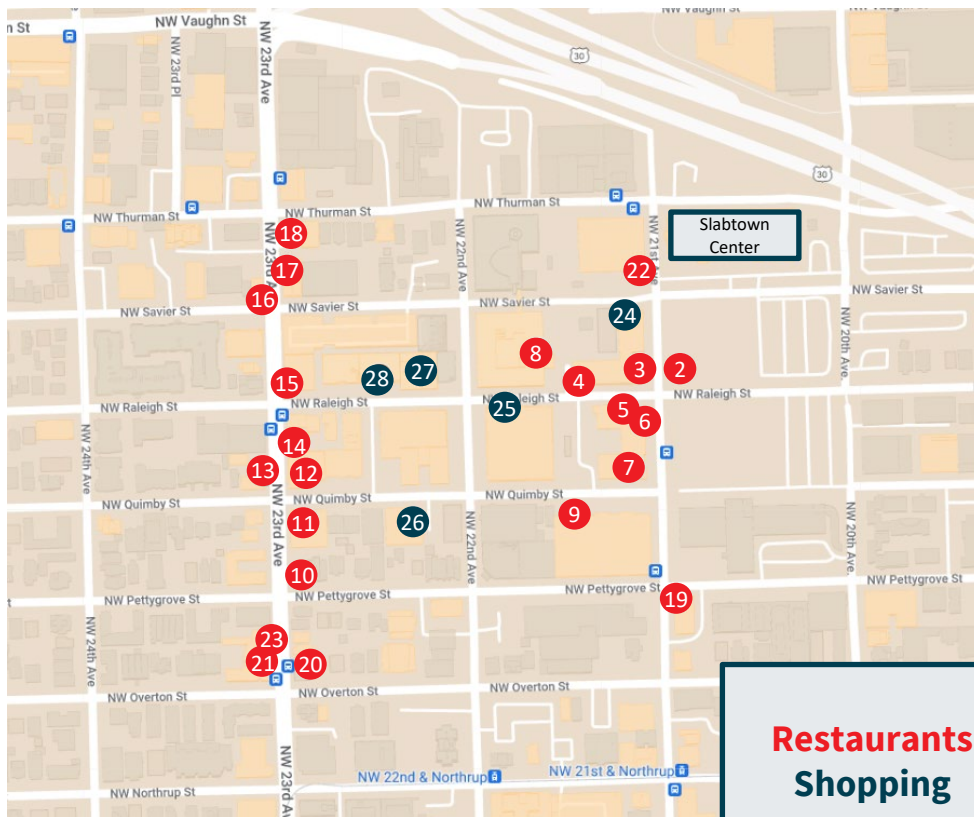

**Restaurants
Shopping**

FOR LEASING INFORMATION:

Eric Turner

Licensed in OR & WA

+1 503 546 3670

eric.turner@jll.com

Candace Lounsbury

Licensed in OR & WA

+1 503 937 2131

candace.lounsbury@jll.com

