



281 East US Route 6

SWQ N Division Street & US Highway 6
Morris, IL 60450

Sublease available



Courtney Rouleau

Vice President

+1 312 228 3431

courtney.rouleau@jll.com

Natalie Belloff

Associate

+1 312 228 2008

natalie.belloff@jll.com



Property overview & demographics

- Second-generation restaurant opportunity in Morris, IL
- Prime end-cap positioning offers strong visibility from both US Highway 6 (12,200 ADT) and N Division Street (16,500 ADT)
- Positioned in front of Walmart, the property has exposure to high daily needs traffic
- The site offers an existing drive-thru, enhancing customer convenience and access

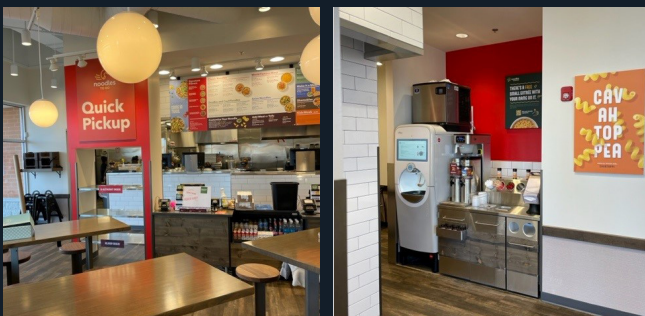

Address	281 East U.S. Route 6 Morris, IL 60450
Size	2,269 SF
Asking rent	Upon request
Status	All tours by appointment only; please do not disturb current occupant's staff or operations
Possession	Currently occupied
Lease Expires	March 31, 2032

Area retailers

Walmart



The UPS Store



DUNKIN'

	3 mile	5 miles	7 miles
Population	15,666	18,324	21,644
Daytime population	19,343	21,301	23,466
Avg household income	\$102,949	\$108,431	\$116,475
Households	6,657	7,698	8,968

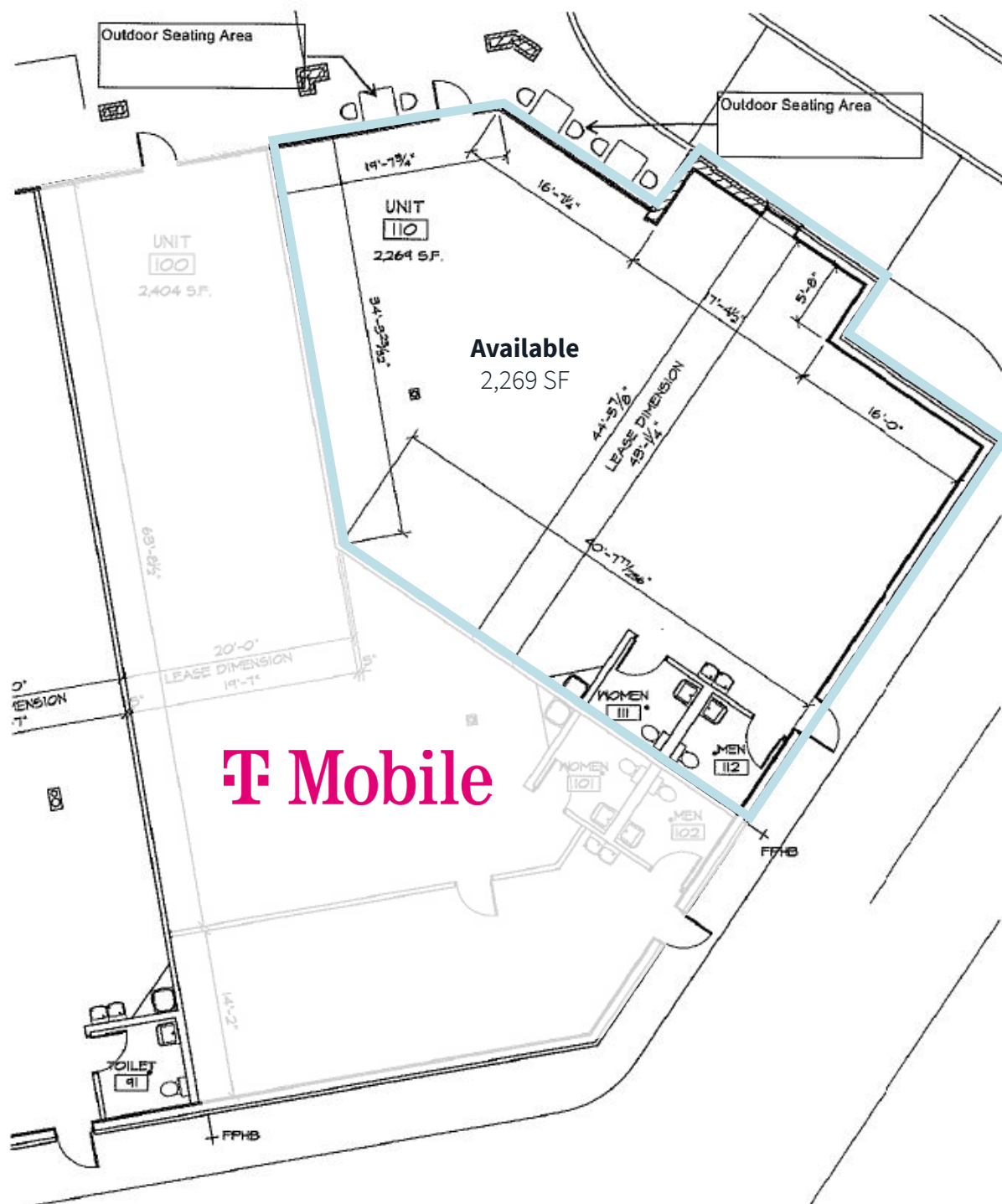

Morris, IL
Retail trade area



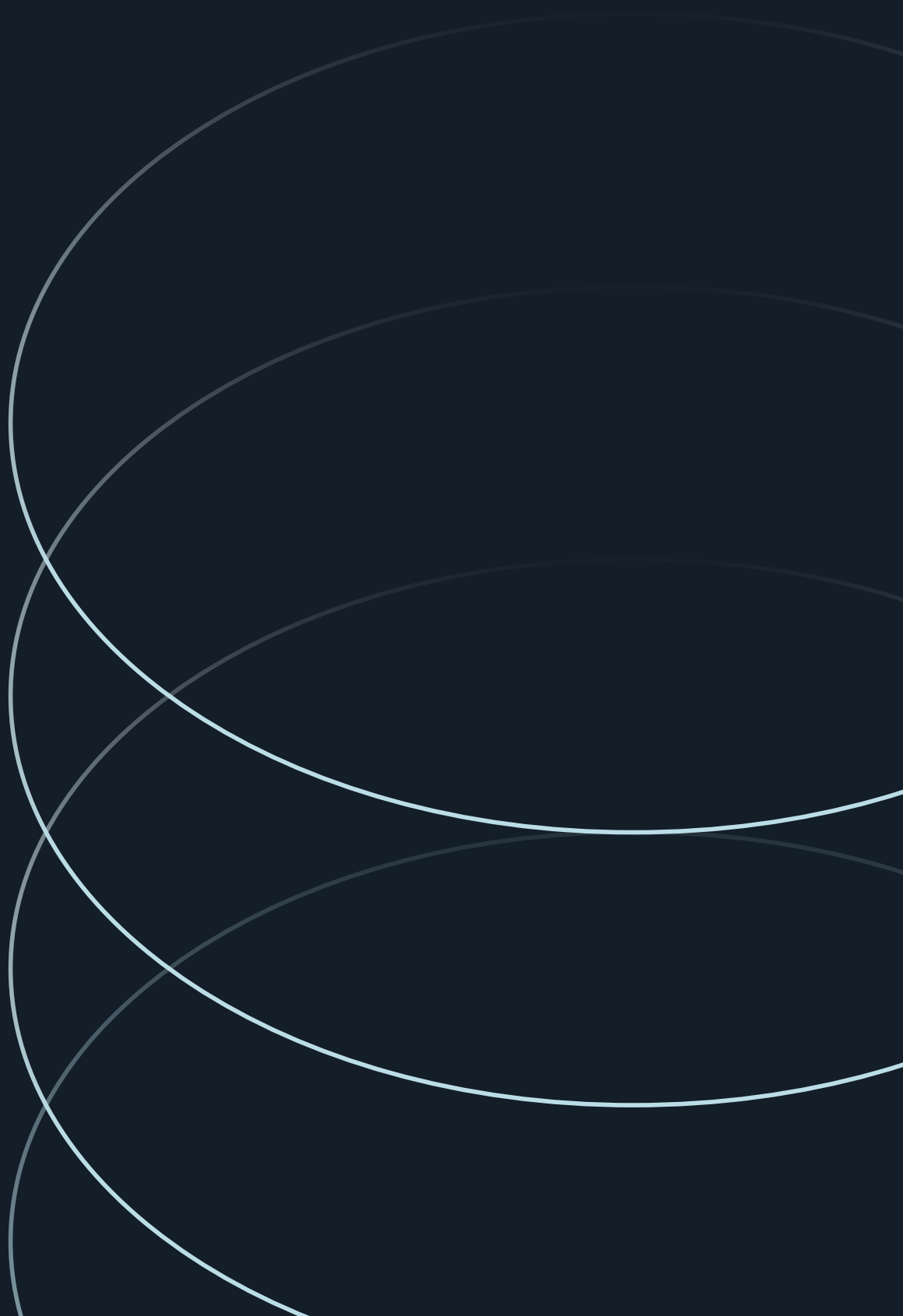

Courtney Rouleau

Vice President

+1 312 228 3431

courtney.rouleau@jll.com

Natalie Belloff

Associate

+1 312 228 2008

natalie.belloff@jll.com