



# For lease

3260 Eagle Park Dr NE | 966 RSF - 17,278 RSF Available

 JLL SEE A BRIGHTER WAY

# Property overview & demographics

## Eagle Crest Office Park

Located in the northeast suburb of Grand Rapids, the building offers high visibility from East Beltline in the well known Eagle Crest Office Park.

Surrounded by countless amenities and located near the I-96 interchange.

A quality class B office building built in 1995, tenants benefit from a strong owner occupier and boasts a high onsite parking ratio of 5.92/1,000 s.f.

Suites ranging from 966 s.f. to 17,278 s.f. at \$17.50/s.f. MG - \$18.50/s.f. MG.



## Demographics



### Number of households

1-miles	3-miles	5-miles
<b>1,364</b>	<b>19,072</b>	<b>75,746</b>

### Median household income

1-miles	3-miles	5-miles
<b>\$155,124</b>	<b>\$86,241</b>	<b>\$72,137</b>

### Estimated population

1-miles	3-miles	5-miles
<b>3,691</b>	<b>48,391</b>	<b>185,725</b>

### Median age

1-miles	3-miles	5-miles
<b>33.9</b>	<b>39.5</b>	<b>35.5</b>



# Availability

Suite	Size	Rate
-------	------	------

105	1,509 s.f.	\$18.50/s.f. MG
110	1,272 s.f.	\$18.50/s.f. MG
115	1,902 s.f.	\$18.50/s.f. MG
120	2,944 s.f.	\$17.50/s.f. MG
125	966 s.f.	\$18.50/s.f. MG
135	4,331 s.f.	\$17.50/s.f. MG
145	1,894 s.f.	\$18.50/s.f. MG
105 - 115	4,683 s.f.	\$17.50/s.f. MG
120 - 145	11,394 s.f.	\$17.50/s.f. MG
105 - 145	16,077 s.f.	\$17.50/s.f. MG



# Floor plan

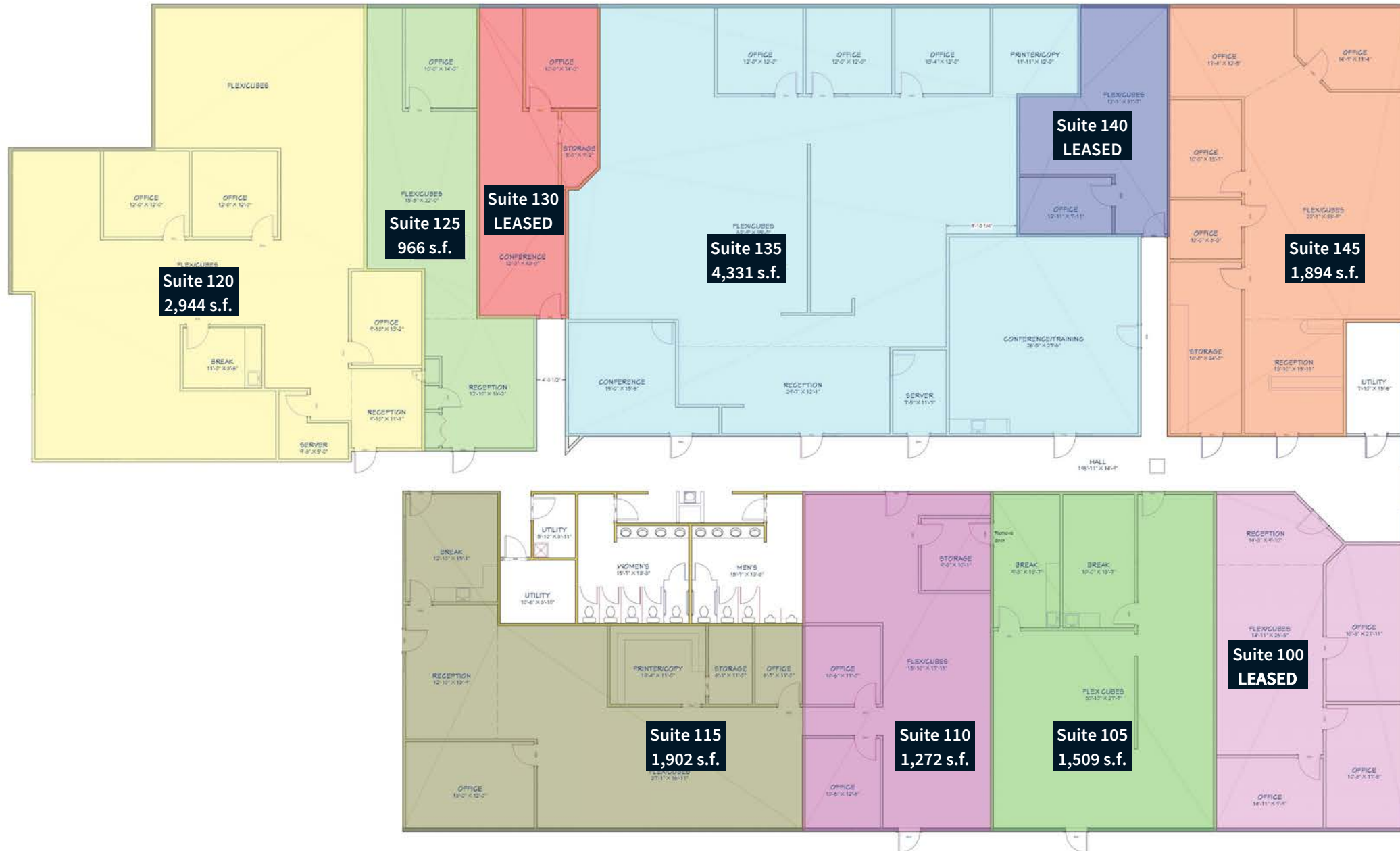



Interior photos



Interior photos





**JLL****Jeff Karger**

Executive Vice President

[jeff.karger@jll.com](mailto:jeff.karger@jll.com)

+ 616 649 3532

**Sarah Noordyke**

Associate

[sarah.noordyke@jll.com](mailto:sarah.noordyke@jll.com)

+ 616 649 3531

©2024. Jones Lang LaSalle IP, Inc. All rights reserved