



5300 Virginia Way

Nashville, TN



10,813-21,685 RSF Available for Sublease

Premier location in the heart of Maryland Farms

- Campus style environment
- Single Tenant HQ Opportunity
- Lease Expiration Date: 3/31/2026
- Private patio with outdoor greenspace
- 2 floors – ability to demise by floor
- Available immediately
- Short drive to Brentwood amenities
- Easy ingress/egress off Virginia Way

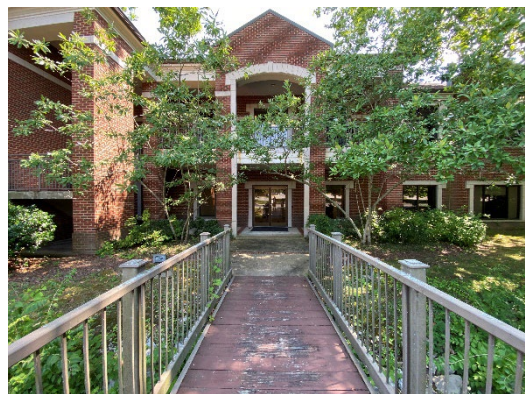

Lauren Mitchell

Managing Director

O: +1 615 928 5305

M: +1 615 497 7136

Lauren.Mitchell@jll.com



5300 Virginia Way

Total SF:	21,685 RSF
Lease Expiration:	3/31/2026
Available:	Immediately
Furniture:	Negotiable
Parking:	3.33/1,000 (70 Parking Spaces)
Notes:	<ul style="list-style-type: none">• Ample storage space on site• Building signage available• HQ feel in Maryland Farms



Main Floor 10,872 SF

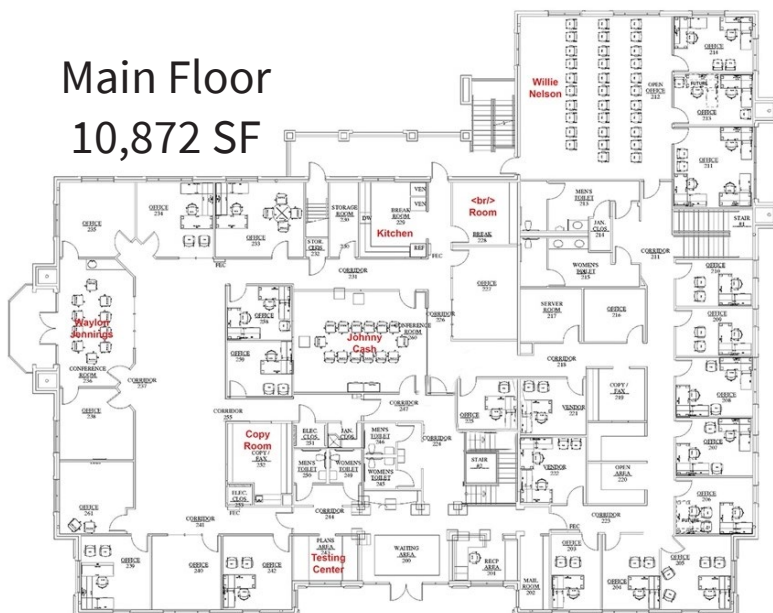

Lower Level 10,813 SF



Contact

Lauren Mitchell
 Managing Director
 O: +1 615 928 5305
 M: +1 615 497 7136
Lauren.Mitchell@jill.com