

MIDTOWN RETAIL OPPORTUNITY

1411 BROADWAY

Retail at the base of a 1.1 million SF office tower, situated between Bryant Park, Times Square & Port Authority



Corey J. Zolcinski
212.812.5707
corey.zolcinski@jll.com

Matt J. Ogle
212.812.5982
matt.ogle@jll.com

Patrick A. Smith
212.812.5888
patricka.smith@jll.com

Location Prominent Seventh Avenue location; one block from Bryant Park

Retail A | Seventh Avenue at 40th Street

Ground floor: 1,439 sf

Frontage

Approx. 50'

Site Status

Currently a portion of H&R Block

Possession

Immediate

Retail B | Seventh Avenue at 39th Street

Ground floor: 850 sf

Frontage

Approx. 40'

Site Status

Vacant

Possession

Immediate

Retail C | 40th Street, between Seventh Avenue and Broadway

Ground floor: 681 sf

Frontage

Approx. 20'

Site Status

Vacant

Possession

Immediate

- Retail adjacent to the "Big Button" - towering symbol of the neighborhood
- Building is home to leading fashion center tenants, including Jones New York, Kellwood, and Levi Strauss & Co.
- Highly-trafficked pedestrian corridor
- Steps from Times Sq-42nd Street subway station with direct access to the station from the building plaza

Retail C



Ground floor

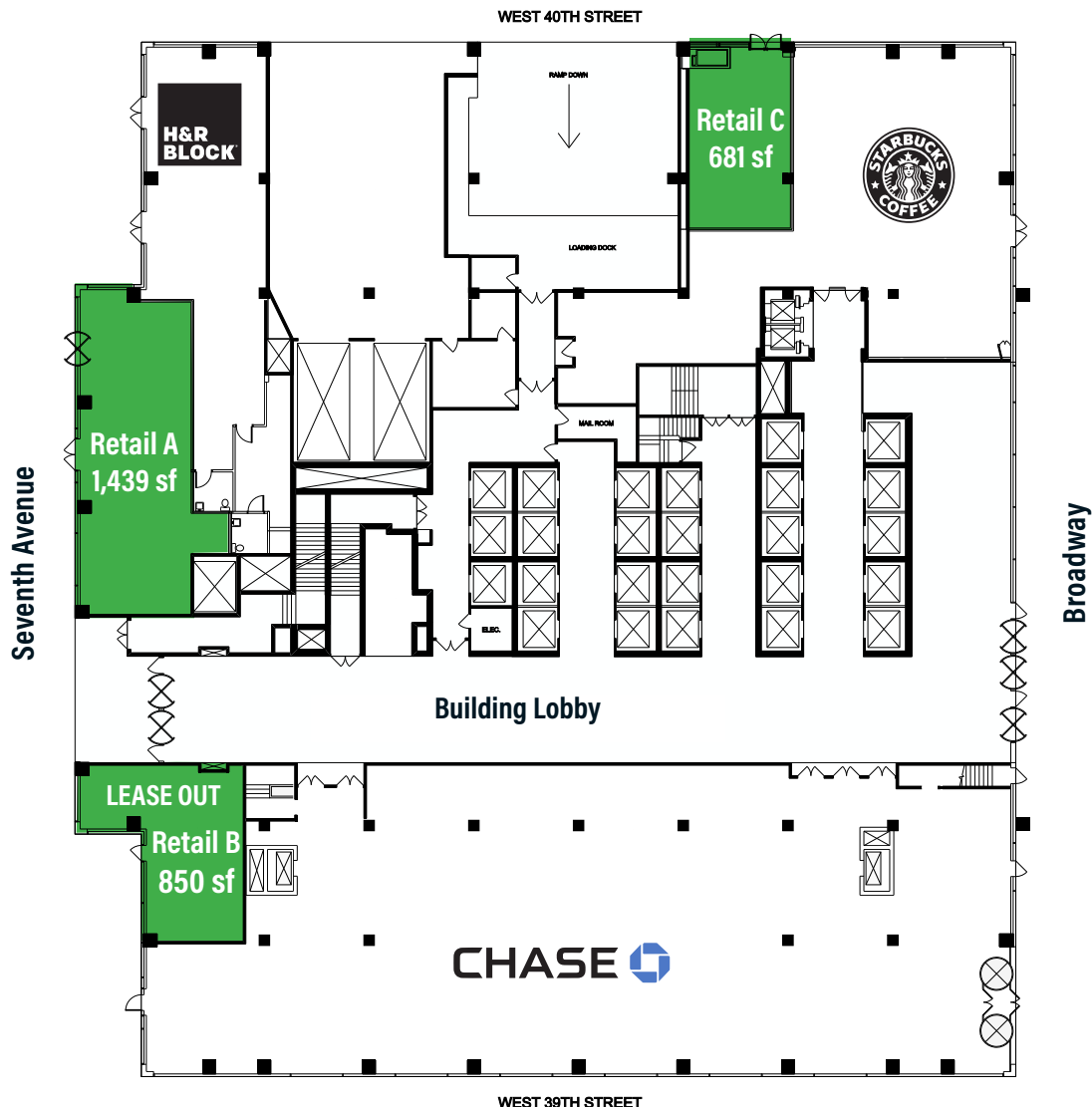



129,941
Pedestrians Weekly

166,531
Area Employees

46,911,644
SF of Office Space

*Within a 1/4 mile



B D F M 7
16,056,128 annual

