

For lease or sale

34,460 SF Food Processing & Cold Storage

©2024 Jones Lang LaSalle Brokerage, Inc. a licensed real estate broker.



**2009 Rolling Hills Dr
Covington, KY 41017**

Location

- Immediate access to I-275 (approx. 1 mile)
- Close to I-75 (approx. 3 miles)
- Easy access to I-71 and I-471
- Near Amazon Air Hub (7 miles)
- Coca-Cola (4 miles)
- Fedex Ground (6 miles)



Property summary

Total building Size	34,460 SF
Cold storage total	7,800 SF
• Convertible Freezer/Cooler	1,000 SF
• Freezer	6,800 SF
Temp. controlled production area	13,000 SF
Dry Warehouse	6,500 SF
Office	3,660 SF
Site size	4.17 AC
Zoning	SI - Suburban Industrial
Clear height	24'
Production Ceiling Height	12'
Refrigerant System	Ammonia
Freezer floor	Glycol in floors
Dock doors	6 total
• Cold docks	2
Drive-in doors	1 - fork lift drive in door
Auto parking	61 spaces
Electrical	2,000a
Lighting	LED
Roof type	TPO/ Replaced ~2020
Construction	Concrete block, metal and sandwich panel

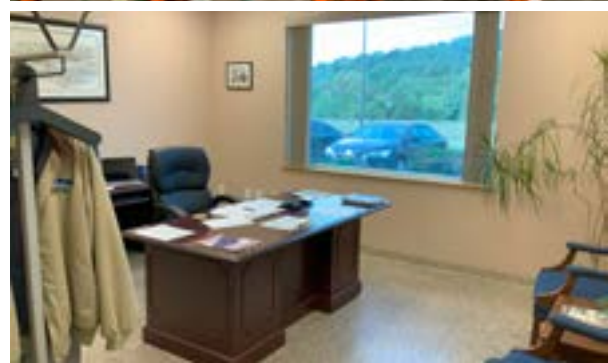

This detailed architectural floor plan illustrates the layout of a facility, possibly a pharmaceutical or food processing plant. The plan is divided into several functional areas:

- Top Section (Production Area):** Includes a large **PRODUCTION AREA** with multiple **PRODUCTION SUPERVISOR** stations. Adjacent to this is a **FINISH PRODUCT RESEAL** area and a **PACKAGING AREA** with several **NEW EVAP** (Evaporator) units. A **MAINTENANCE ROOM** and a **RESTROOM** are also located in this section.
- Middle Section (Support and Storage):** Features a **RECEIVING AREA** with a **RECEIVING** station and a **RECEIVING** area. A **STORAGE** area is also present. A **RESTROOM** and a **LOCKER** are located near the center.
- Bottom Section (Office and Conference):** Contains an **OFFICE** area with a **RECEPTION** desk, a **CONFERENCE ROOM**, and a **RESTROOM**. A **LOCKER** is also located in this section.
- Right Side (Production Area):** Includes a **PRODUCTION AREA** with a **PRODUCTION SUPERVISOR** station and a **PACKAGING AREA** with several **NEW EVAP** units. A **MAINTENANCE ROOM** and a **RESTROOM** are also located in this section.
- Far Right (Production Area):** Features a **PRODUCTION AREA** with a **PRODUCTION SUPERVISOR** station and a **PACKAGING AREA** with several **NEW EVAP** units. A **MAINTENANCE ROOM** and a **RESTROOM** are also located in this section.

The plan includes numerous smaller rooms, corridors, and specialized equipment, providing a comprehensive view of the facility's layout and functional zones.

[illegible]

Site plan

R O L L I N G H I L L S D R I V E

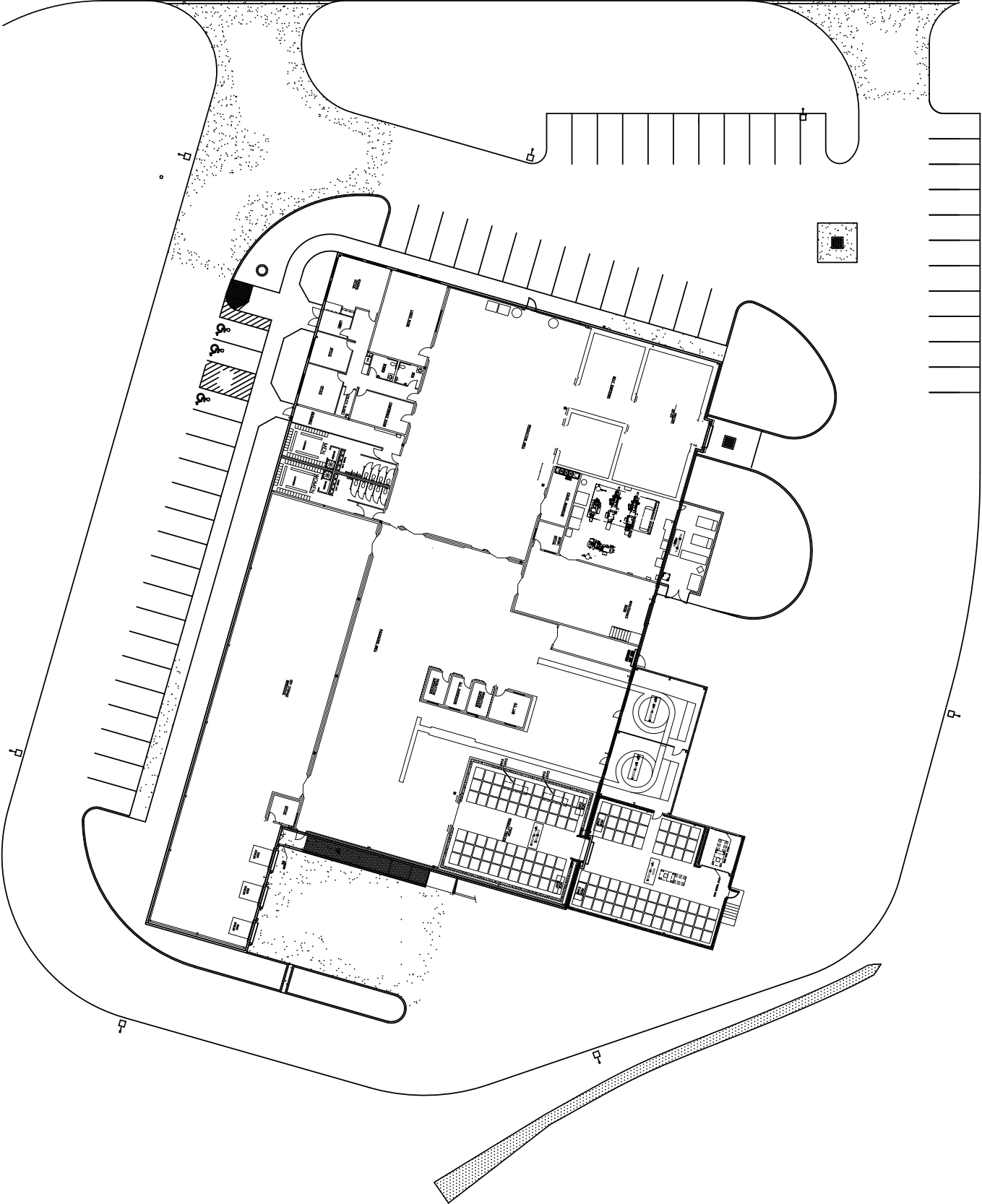



2009 Rolling Hills Dr - Aerial view



Northern Kentucky : The Gateway to the South

A thriving region for business, logistics, and innovation

Top State for Business

#2 State for Cost of Doing Business
CNBC - 2023

#4 Best State for Infrastructure
CNBC - 2023

#5 America's Top States for Business
Cheif Executive, 2023

Top 10 in Tax Climate for Businesses
Tax Foundation, 2023

Ideal location

Northern Kentucky offers a prime location with access to major logistics and transportation hubs, making it a vital business gateway.

#1 Largest Global Amazon Air Hub
Airports Council International - North America 2012-2023

#1 in the U.S for logistics infrastructure

#6 State for business friendliness
CNBC - 2023

Mark Volkman

Senior Managing Director
mark.volkman@jll.com
+1 513 226 2076

Brian Leonard

Executive Managing Director
brian.leonard@jll.com
+1 513 257 5653

Although information has been obtained from sources deemed reliable, JLL does not make any guarantees, warranties or representations, express or implied, as to the completeness or accuracy as to the information contained herein. Any projections, opinions, assumptions or estimates used are for example only. There may be differences between projected and actual results, and those differences may be material. JLL does not accept any liability for any loss or damage suffered by any party resulting from reliance on this information. If the recipient of this information has signed a confidentiality agreement with JLL regarding this matter, this information is subject to the terms of that agreement. ©2024 Jones Lang LaSalle IP, Inc. All rights reserved.