

Site plan

Pleasant Hill Industrial Park Pleasant Hill, Iowa

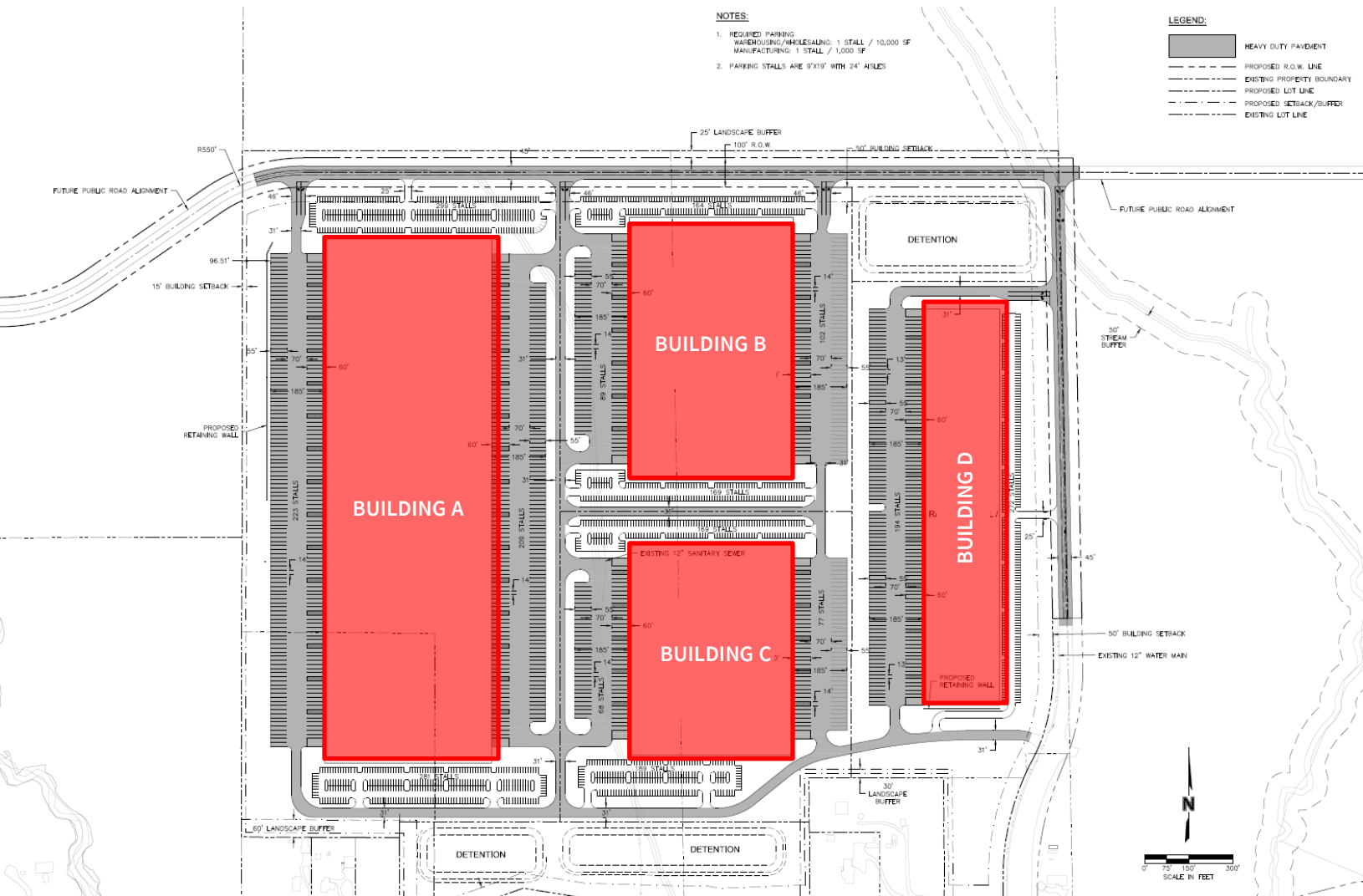

Building A

Building dimensions: 570' x 1,792'

Total SF: 1,021, 440 SF

Parking Stalls: 609 stalls

Parking ratio: 1 stall/1,761 SF

Truck stalls: 435

Building B

Building dimensions: 560'x728'

Total SF: 407,680 SF

Parking stalls: 358 stalls

Parking ratio: 1 stall/1,139 SF

Truck stalls: 145

Building C

Building dimensions: 560'x896'

Total SF: 501,760 SF

Parking stalls: 333

Parking ratio: 1 stall / 1,507 SF

Truck stalls: 191

Building D

Building dimensions: 260'x1352'

Total SF: 351,520 SF

Parking stalls: 272

Parking ratio: 1 stall / 1,292 SF

Truck stalls: 194