 **JLL** SEE A BRIGHTER WAY

For Lease

500 Maitland Ave S | Maitland FL
2,213 ± RSF Available

500 Maitland Ave S / Maitland, FL

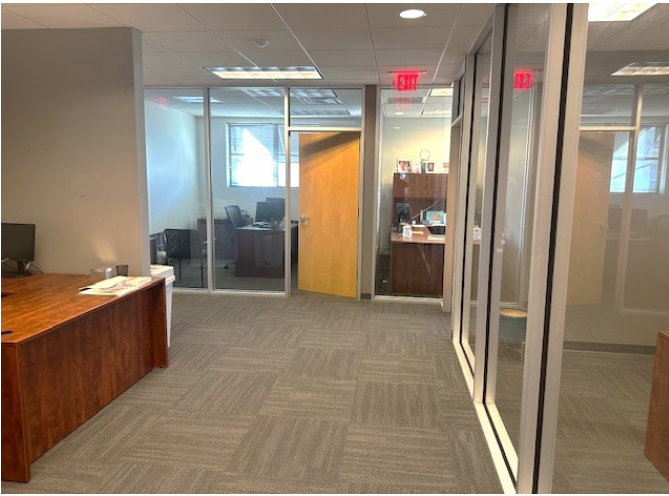





2,213 RSF available



The building is directly across Maitland Avenue from the Maitland Public Library



Highly visible signage on the corner of Maitland Ave and Ventriss



Glass walls allowing for plenty of natural light throughout the space



Ample parking included in rent



Starbucks, Lazy Moon Pizza, Antonio's, and more within walking distance



Mixture of open area, conference, reception, and private offices



Includes break area, and storage room



\$27.50/SF MG (net of electric and janitorial)



Available immediately

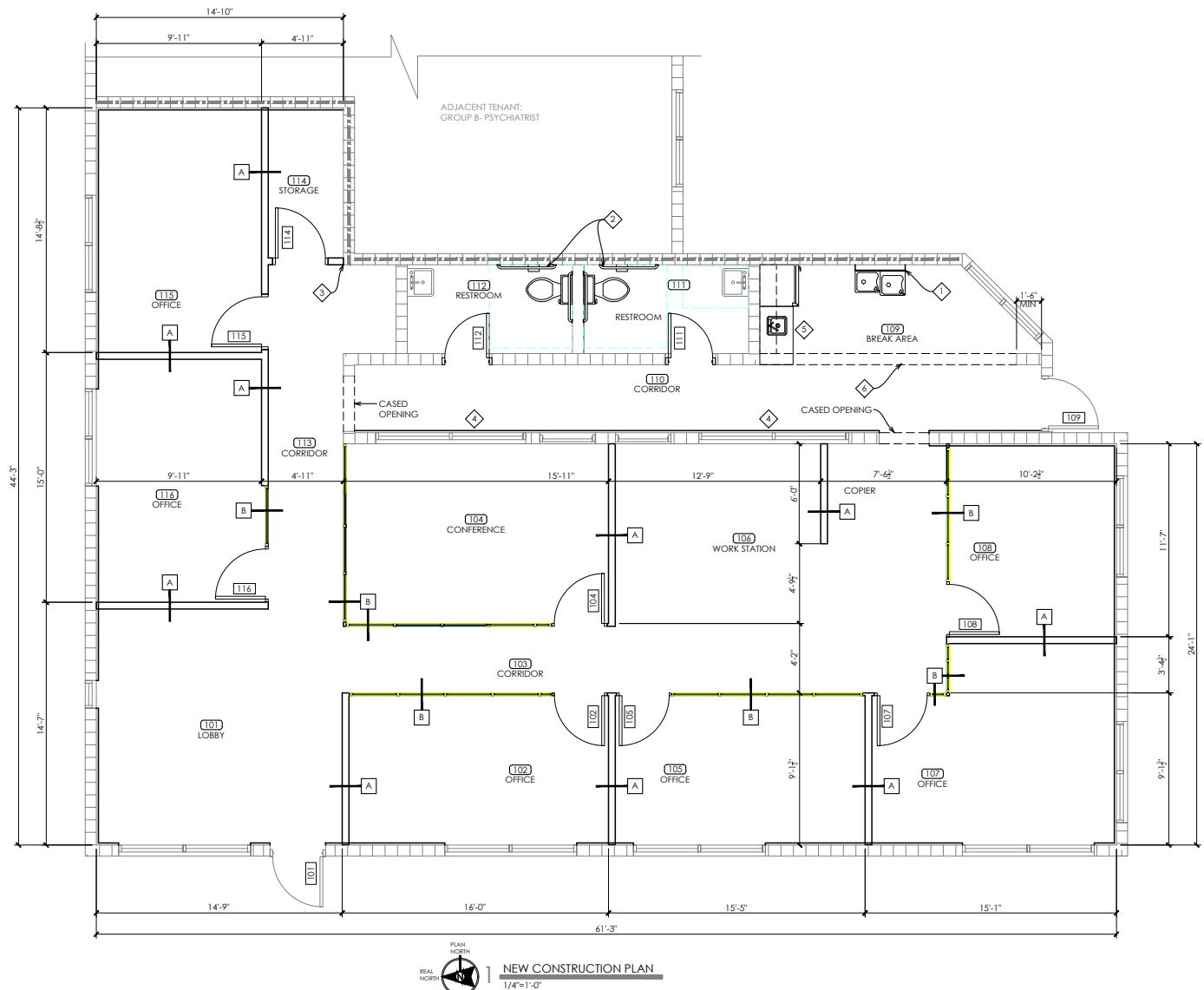

Maitland

The City of Maitland is a premier suburban community of Orlando. Located conveniently off of I-4 and just 7 miles from downtown Orlando, Maitland offers the benefits of a larger metro with access to amenities. Employees benefit from easy access to area retail, restaurant and service amenities in addition to variety housing options in the surrounding area.

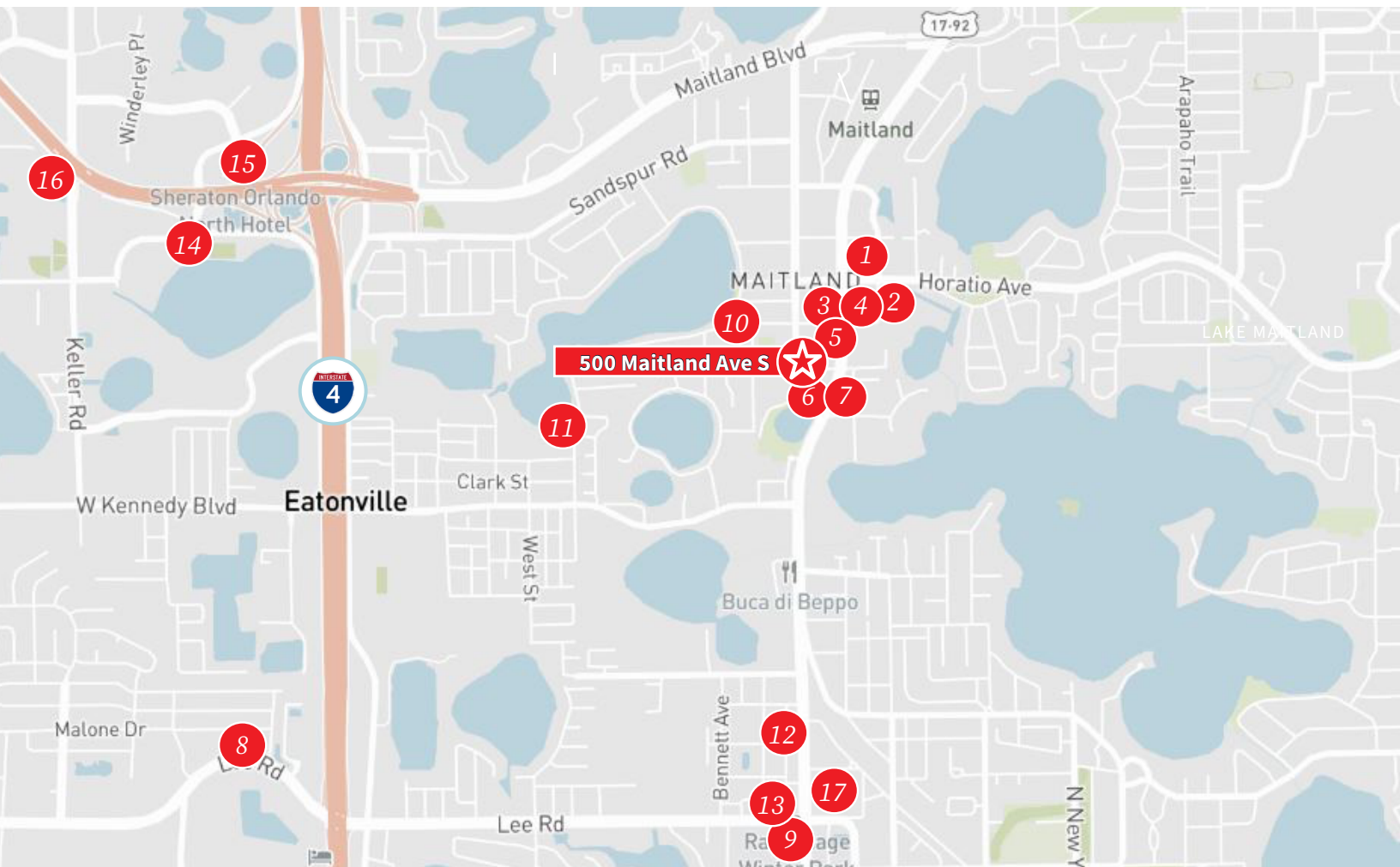

- | | |
|--------------------------------------|---|
| 1. Maitland Plaza | 10. Art & History Museums of Maitland |
| 2. Foxtail Coffee Co. | 11. Audubon Center |
| 3. Starbucks | 12. SpringHill Suites - Winter Park |
| 4. McDonald's | 13. Hilton Garden Inn - Winter Park |
| 5. Firehouse Subs | 14. Homewood Suites - Orlando/Maitland |
| 6. Antonio's Italian | 15. Sheraton - Orlando North |
| 7. Luke's Kitchen & Bar | 16. Courtyard Hotel - Orlando/Altamonte Springs |
| 8. Christner's Prime Steak & Lobster | 17. Winter Park Square |
| 9. Fleming's Prime Steakhouse | (Nordstrom Rack, Sephora, Whole Foods) |

Jamie Barati
Senior Vice President
407-930-1803
jamie.barati@jll.com

John Worrell
Senior Vice President
321-684-9240
john.worrell@jll.com