

# 550

SOUTH PARK

THE SEAMLESS SOLUTION

25,000 RSF FULLY FURNISHED

VIRTUAL TOUR



ADDITIONAL PROFESSIONAL PHOTOS



# *Discover* South Park's New Standard of Space

A **fully furnished opportunity** in San Francisco's famed South Park submarket. Complete with expertly designed Costa Brown workspace that is **move-in Ready**.

- ◆ Brand New Construction
- ◆ Fully Spec'd Out Work Space
- ◆ Move-In Ready Fully Furnished Space
- ◆ Flexible Lease Term



VIRTUAL TOUR





# A Grand Arrival

550 South Park features the distinct advantage of a separated reception area from the workspace, offering countless benefits to your business:



**Increased Privacy:** By segregating your reception area, you safeguard sensitive information and preserve confidentiality.



**Enhanced Security:** Ensure that only authorized personnel/guest gain access to your workspace, protecting your valuable assets, confidential data, and intellectual property.



**Brand Reinforcement:** A well-designed separated reception area provides unique opportunity to display your brand identity.



**Guest Management:** First impressions matter, a dedicated reception area allows your clients and guests to be greeted with professional and welcoming atmosphere.





# Talk of the Town

550 South Park will feature a **5,000 SF multi-use auditorium**. Used regularly as a social stair, the town hall features a highly flexible seating system: keynote or product launch talks for 150, conferences, workshops and open floor exhibitions are only a few of the many possibilities.





# *Unparalleled* Entertainment Space

With a brand new **4,000 RSF roof deck penthouse** atop 550 South Park, boasting views of South Park and San Francisco's skyline, utilize the indoor-outdoor areas to entertain customers, advisors, and investors.





# Where Your *Employees* Want to Be

550 South Park boasts **amenities that stretch beyond the workplace**, delivering an immersive place to work, lounge, entertain and play, all under one roof.

- ◆ Dedicated grand arrival
- ◆ Multi-Use town hall
- ◆ 4,000 RSF private indoor-outdoor terrace
- ◆ Multiple kitchen & bars
- ◆ Fitness center & shower facility
- ◆ Underground speakeasy
- ◆ EV parking





# First Floor

550  
SOUTH PARK

- ◆ Grand entrance
- ◆ Indoor garden
- ◆ Three interconnecting stairwells: ground floor and rooftop terrace access
- ◆ All hands multi-function space
- ◆ Social cafeteria & bar
- ◆ Parking for 3 cars + EV stations
- ◆ 24 work stations (ability to add 6 more)
- ◆ 3 soft-seating pods
- ◆ 9 meeting rooms
- ◆ Huddle space
- ◆ Gym room
- ◆ Bike parking
- ◆ 6 fixtures, 3 womens and 3 mens



Building to be delivered as shown, further tenant design changes are acceptable.



# Second Floor

- ◆ Three interconnecting stairwells: ground floor and rooftop terrace access
- ◆ 48 work stations (ability to add 12 more) phone rooms
- ◆ Large boardroom
- ◆ 2 huddle rooms
- ◆ 2 private offices
- ◆ Open collaboration space
- ◆ Showers & lockers



550  
SOUTH PARK

Building to be delivered as shown, further tenant design changes are acceptable.



# Rooftop Penthouse

550  
SOUTH PARK

- ◆ Views of city and Salesforce tower
- ◆ Entertainment area for clients and partners
- ◆ Indoor and outdoor seating with breakout areas
- ◆ Walking loop

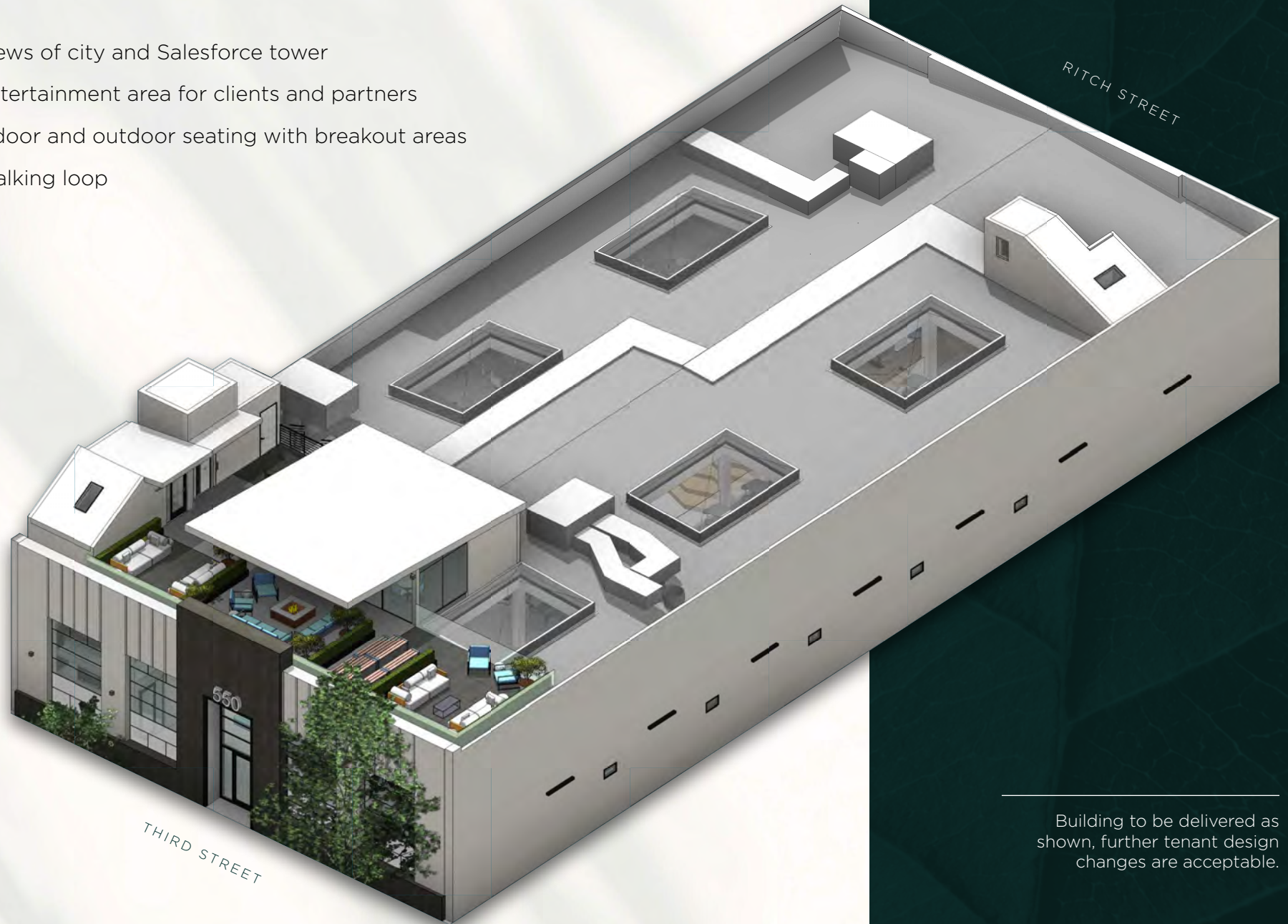

Building to be delivered as shown, further tenant design changes are acceptable.



# *Connected in* the Heart of San Francisco

- MUNI Metro
- BART
- Caltrain
- Central Subway
- MUNI Metro Station
- BART Station
- Central Subway Station





# Venture Capital Hub of San Francisco

Deemed the “Sand Hill Road of San Francisco,” South Park serves as a thriving epicenter for innovation, attracting influential venture capital neighbors.

At the forefront, 550 South Park spearheads a vibrant community that fosters collaboration and fuels entrepreneurial growth in the heart of South Park.





# 550

## SOUTH PARK

**Charlie Hanafin**

**415.395.4951**

**[charlie.hanafin@jll.com](mailto:charlie.hanafin@jll.com)**

**License #: 01856260**

**John Roskos**

**415.713.8474**

**[john.roskos@jll.com](mailto:john.roskos@jll.com)**

**License #: 02038370**

**Brittan Hawken**

**310.344.2554**

**[brittan.hawken@jll.com](mailto:brittan.hawken@jll.com)**

**License #: 01963161**



**VIRTUAL TOUR**

**ADDITIONAL PROFESSIONAL PHOTOS**

Jones Lang LaSalle Brokerage, Inc. License #01856260

Although information has been obtained from sources deemed reliable, neither Owner nor JLL makes any guarantees, warranties or representations, express or implied, as to the completeness or accuracy as to the information contained herein. Any projections, opinions, assumptions or estimates used are for example only. There may be differences between projected and actual results, and those differences may be material. The Property may be withdrawn without notice. Neither Owner nor JLL accepts any liability for any loss or damage suffered by any party resulting from reliance on this information. If the recipient of this information has signed a confidentiality agreement regarding this matter, this information is subject to the terms of that agreement. ©2024 Jones Lang LaSalle IP, Inc. All rights reserved.

