



For Sale

Ideal Owner/User Opportunity

1065 W Levoy Drive
Taylorsville, Utah

2nd Floor or Full Building
Availability

\$190/SF Purchase Price

Favorable Loan Assumptions



Top Floor

- 22,837 RSF
- Ideal Owner/User Floor
- Open space with light office build out and large team kitchen

Full Building

- 45,741 RSF
- Income producing first floor tenant
- Potential for owner/user to occupy up to 45,000 RSF

Building Highlights

- Crown Signage Available
- Two story Central Valley Opportunity
- Zoned RD – Research and Development Uses Permitted
- 5.0/1,000 Surface Parking
- Backup Generator On-site
- Conveniently located between I-15 and I-215



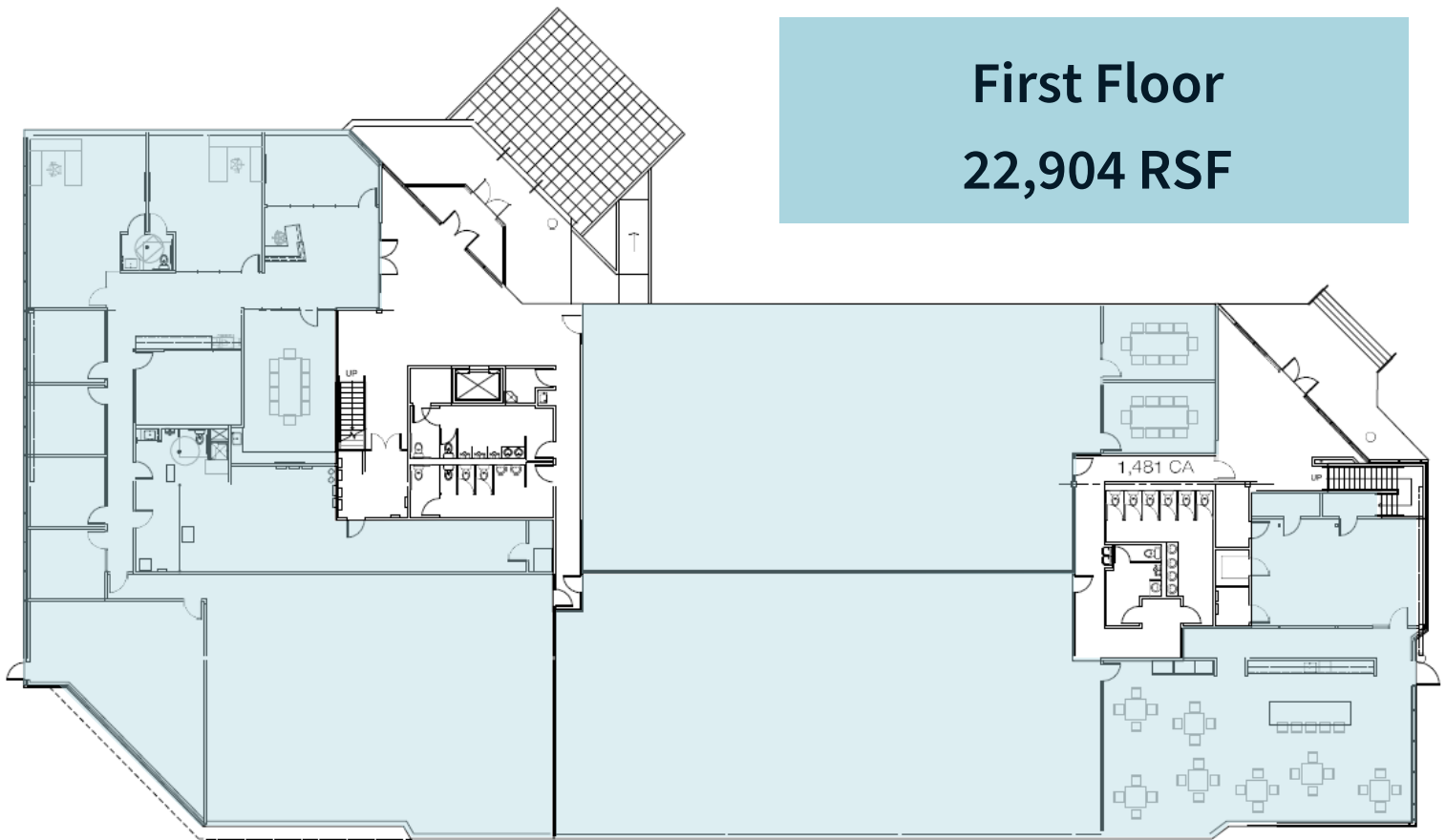

First Floor
22,904 RSF

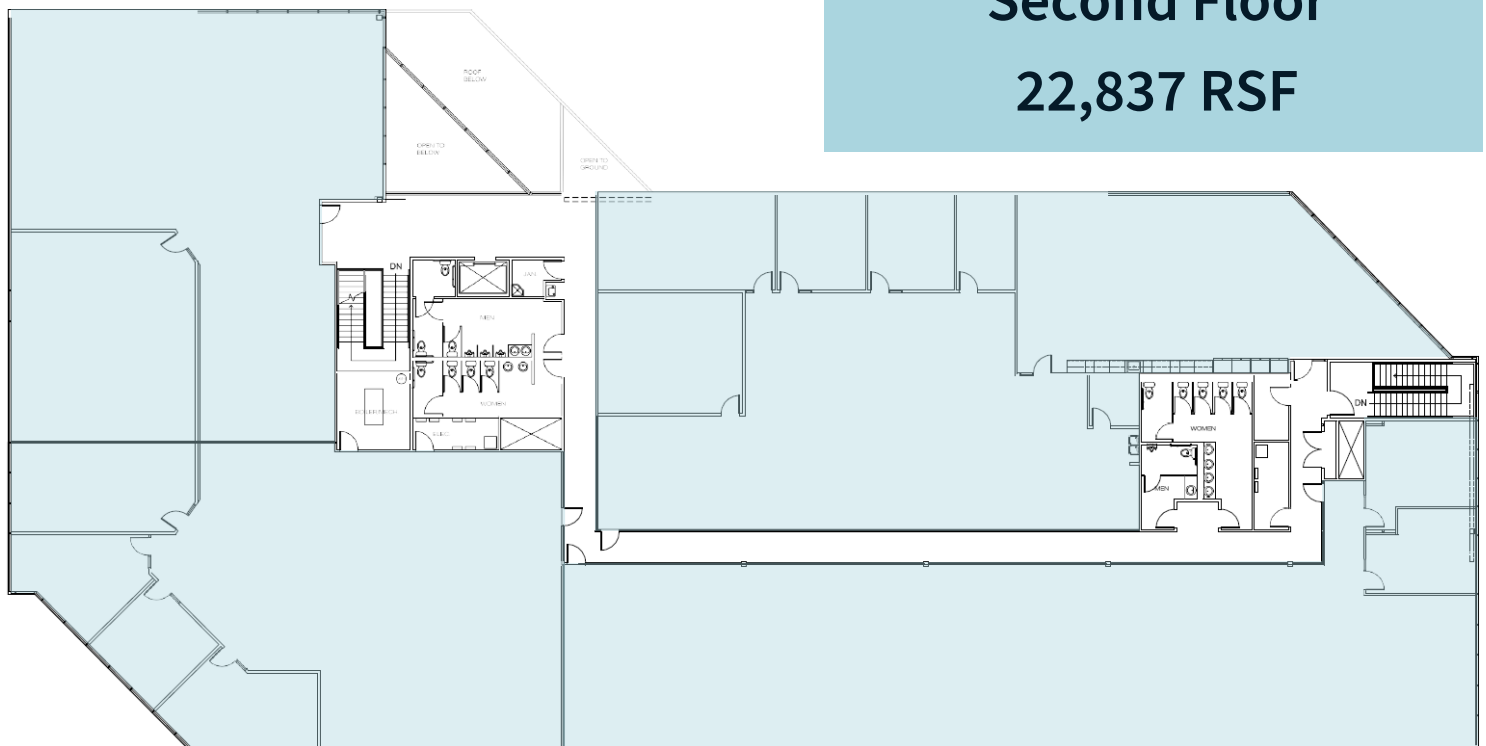

Second Floor
22,837 RSF

About JLL

For over 200 years, JLL (NYSE: JLL), a leading global commercial real estate and investment management company, has helped clients buy, build, occupy, manage and invest in a variety of commercial, industrial, hotel, residential and retail properties. A Fortune 500® company with annual revenue of \$20.9 billion and operations in over 80 countries around the world, our more than 103,000 employees bring the power of a global platform combined with local expertise. Driven by our purpose to shape the future of real estate for a better world, we help our clients, people and communities SEE A BRIGHTER WAYSM. JLL is the brand name, and a registered trademark, of Jones Lang LaSalle Incorporated. For further information, visit jll.com.

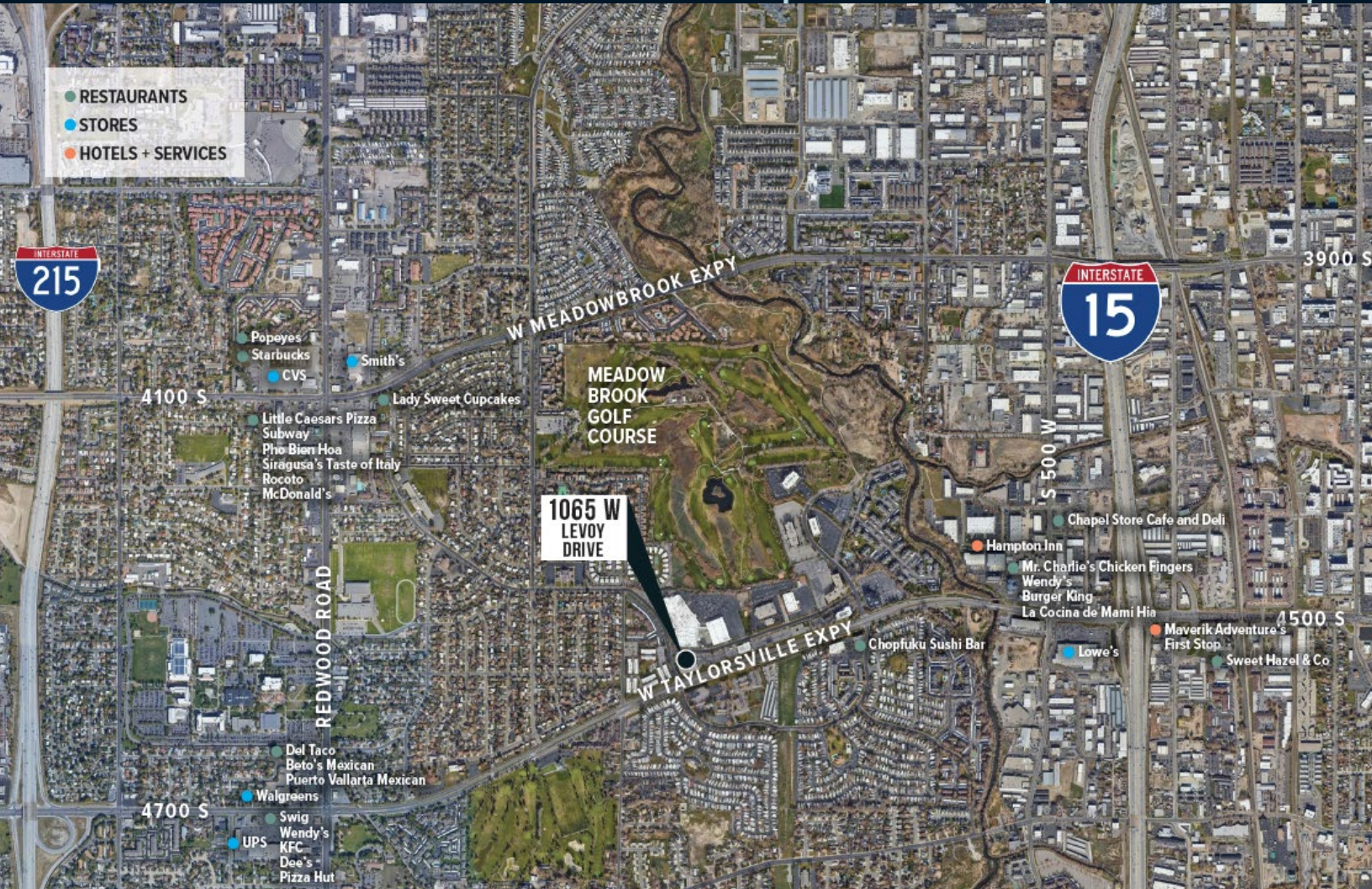

David Nixon

+1 801 456 9518

David.nixon@jll.com

Jillian Johnson Hanks

+1 801 456 9517

Jillian.johnson@jll.com