



4700
WEST
DAYBREAK
PARKWAY

For Lease

A revolution in suburban office space



Jones Lang LaSalle
Brokerage, Inc.

Culture. Community. Convenience.



Welcome to Daybreak

Daybreak is a master planned, mixed-use community located in the City of South Jordan, which is in the southwest corner of the Salt Lake Valley. Within the community you will find parks, schools, office space, and retail amenities. The community is also serviced by a light rail station.

South Jordan is **ranked #4 Small City for Entrepreneurs.** (2019 Inc.com)



Population: **245,624**
Median Age: **30.2**



Households: **65,990**
80.4% Owner Occupied

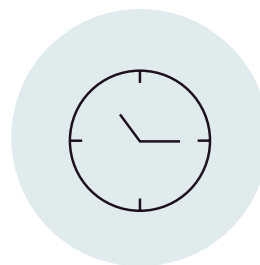

25 Minutes to
Downtown and Silicon Slopes



Daybreak Parkway Station
UTA Trax Station: 0.8 Miles



12th fastest growing city
in the United States
(2019 U.S. Census Bureau)



2 Miles to
Mountain View Corridor

Stunning Views



2,675 - 8,106 RSF available



\$27.00 SF Full Service



Available Now



Located within Daybreak Community, with access to Oquirrh Lake and many retail amenities



Designated LEED Platinum in 2008



Open layout floorplan with high exposed ceilings



Furniture included



Common Kitchen



Access to rooftop patio



Covered parking



Onsite security



Property Highlights



8,106 RSF Available



Floor 2 8,106 RSF

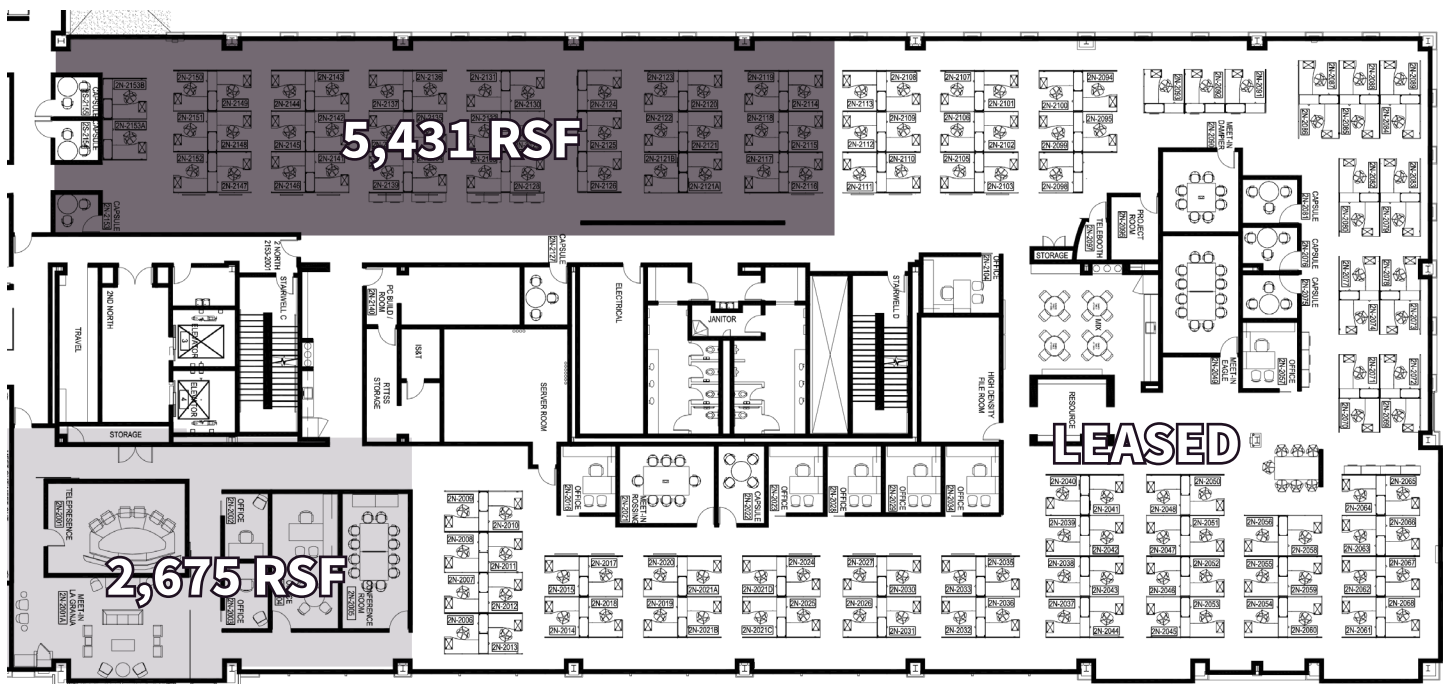

5,431 RSF



2,675 RSF





Drive times



4700 WEST DAYBREAK PARKWAY

For more information, contact:

David Nixon
+1 801 456 9518
david.nixon@jll.com

Jillian Johnson Hanks
+1 801 456 9517
jillian.johnson@jll.com



Jones Lang LaSalle Brokerage, Inc.

©2025 Jones Lang LaSalle LP, Inc. All rights reserved. All information contained herein is from sources deemed reliable; however, no representation or warranty is made to the accuracy thereof.