

# 1057 ATLANTIC AVENUE



## BROOKLYN RETAIL OPPORTUNITY

NEW CONSTRUCTION WITH OVER 227 FEET OF FRONTAGE,  
LOCATED AT THE INTERSECTION OF CLINTON HILL, BEDFORD  
STUYVESANT & CROWN HEIGHTS



# 1057 ATLANTIC AVENUE

Over 30,000 SF at the base of a new 456-unit residential building that offers commercial tenants the sought-after aspects of new construction, including efficient layout, a dedicated loading dock, and oversized windows for maximum exposure.

Scheduled to be completed in 2026, 1057 Atlantic Avenue is located in the recently rezoned portion of Atlantic Avenue in beautiful Bedford Stuyvesant, a quintessential brownstone Brooklyn neighborhood.

With Franklin Avenue Station nearby and up to 126 parking spaces on-site, this retail location offers accessibility from all parts of New York City.



## LOCATION

1057 Atlantic Avenue  
Between Classon and Franklin Avenues

## AVAILABLE SPACE

**Ground Floor**  
30,645 SF

**Frontage**  
227' on Atlantic Avenue

## CEILING HEIGHT

**Ground Floor**  
11'5" - 13'6"

## POSSESSION

Q3 2025

## NEIGHBORING TENANTS

**blink** FITNESS



**SHAKE SHACK**

## LOCATION



## AREA DEVELOPMENT

AREA SUBJECT TO CITY PROPOSED ATLANTIC AVENUE MIXED USE PLAN REZONING

RESIDENTIAL RECENTLY BUILT/ CURRENTLY IN CONSTRUCTION

NEW RESIDENTIAL PLANNED OR UNDER CONSTRUCTION



# 1057 ATLANTIC AVENUE

NEARBY ANNUAL SUBWAY RIDERSHIP  
SOURCE: MTA 2023

## ACCESS



## GROUND FLOOR

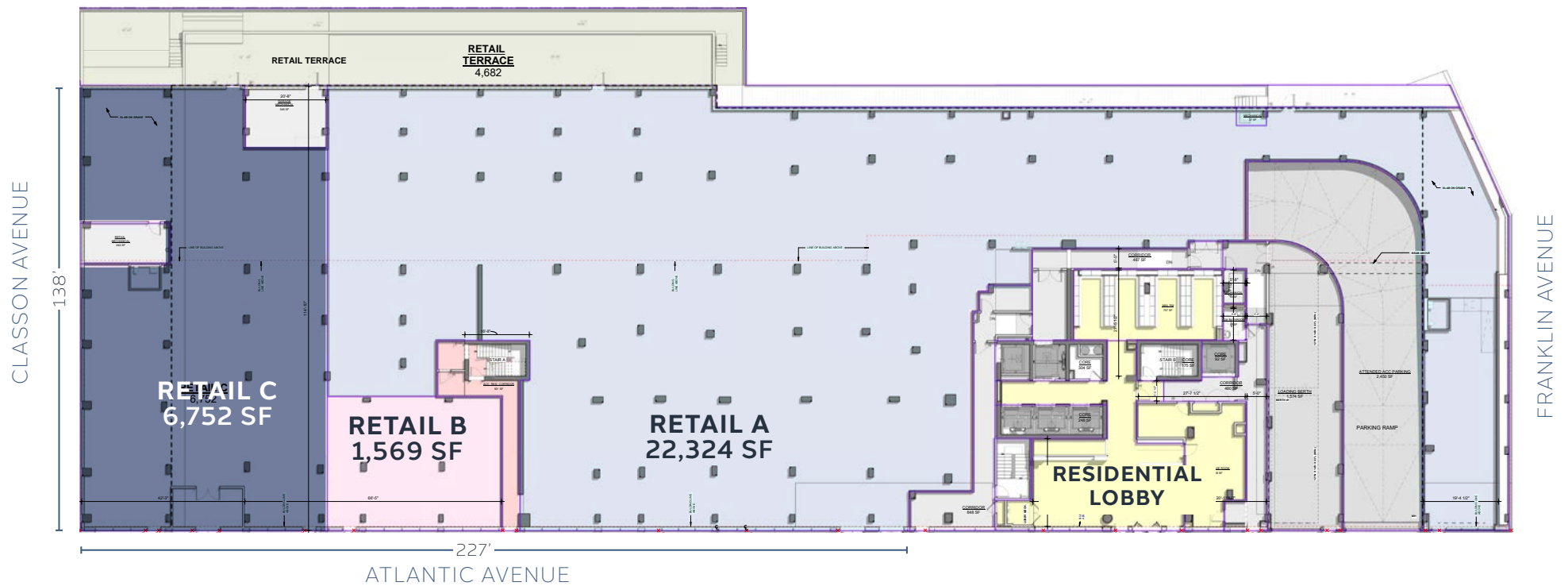

NOTE: SPACES CAN BE COMBINED

# 1057 ATLANTIC AVENUE



**RYAN P. CONDREN**  
+1 212 220 4117  
[RYAN.CONDREN@JLL.COM](mailto:RYAN.CONDREN@JLL.COM)

**GEORGE DANUT**  
+1 212 220 4121  
[GEORGE.DANUT@JLL.COM](mailto:GEORGE.DANUT@JLL.COM)

Jones Lang LaSalle Brokerage, Inc. | 330 Madison Avenue New York, NY 10017

DISCLAIMER Although information has been obtained from sources deemed reliable, neither Owner nor JLL makes any guarantees, warranties or representations, express or implied, as to the completeness or accuracy as to the information contained herein. Any projections, opinions, assumptions or estimates used are for example only. There may be differences between projected and actual results, and those differences may be material. The Property may be withdrawn without notice. Neither Owner nor JLL accepts any liability for any loss or damage suffered by any party resulting from reliance on this information. If the recipient of this information has signed a confidentiality agreement regarding this matter, this information is subject to the terms of that agreement. ©2025 Jones Lang LaSalle IP, Inc. All rights reserved.

## CONTACT

