

FOR SUBLEASE

±18,792 SF Cold Storage Distribution Facility

220 Bingham Drive
San Marcos, CA



Jackson Childers

+1 858 352 2905

jackson.childers@jll.com

CA License #02224366

Greg Lewis

+1 858 410 1251

greg.lewis@jll.com

CA License #01365602

Andy Irwin

+1 858 410 6376

andy.irwin@jll.com

CA License #01302674



Jones Lang LaSalle Americas, Inc.
License #: 01856260

SITE

- ±18,792 SF
- Divisible to ±6,264 SF
- ±15% Office
- Lease Term through 07/31/2025 *
- 5 Dock High Doors
- 4 Grade Level Doors
- 18' - 20' Clear Height

* Longer term available on a direct basis with Landlord

CONTACT BROKER FOR PRICING

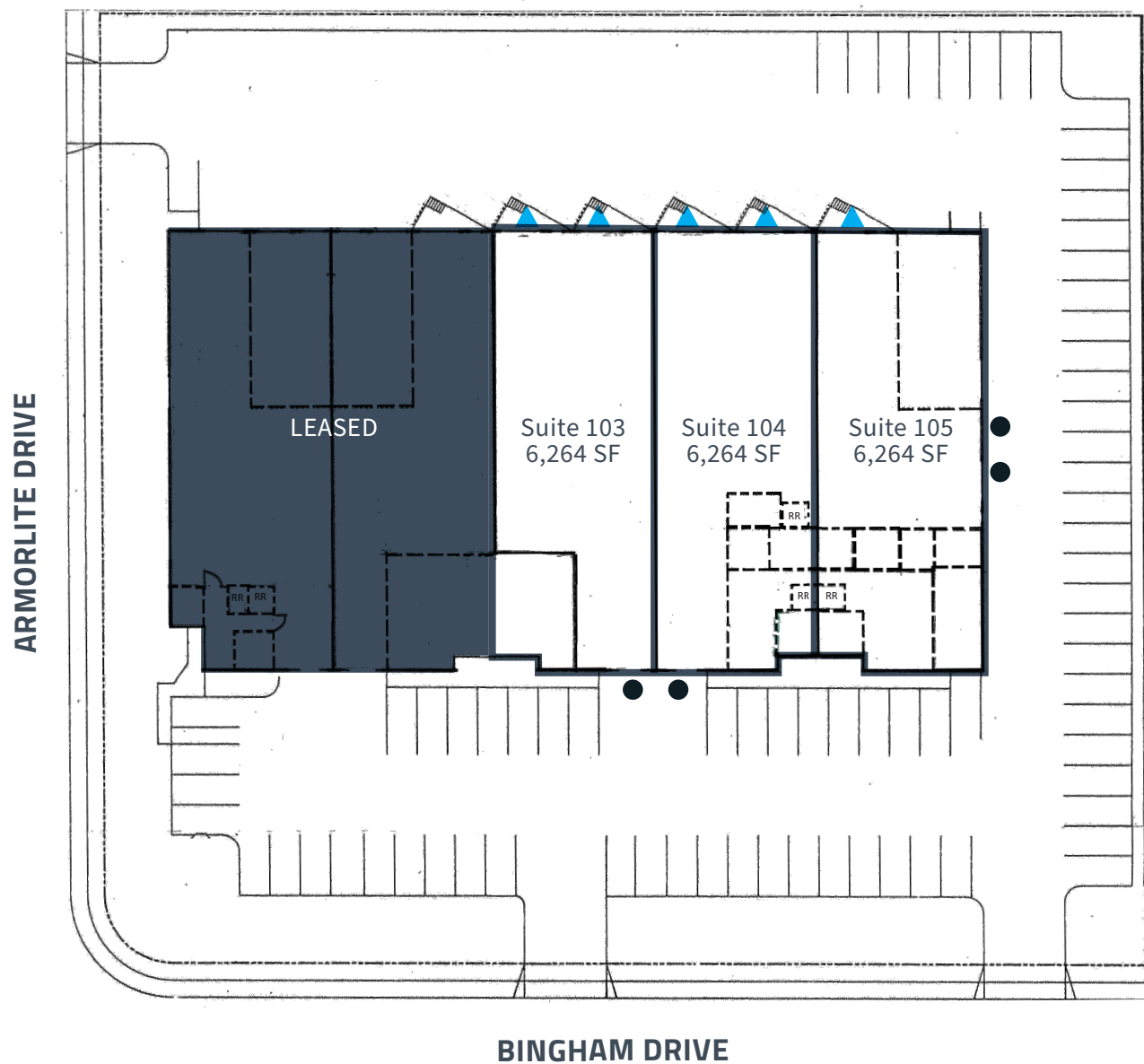

- ▲ DOCK DOORS
- 2 GRADE LEVEL DOORS

SUITE 103

- ±6,264 SF
- ±15% Office
- Lease Term through 07/31/2025 *
- 2 Dock High Doors
- 1 Grade Level Doors
- 18' - 20' Clear Height
- Dry Storage Only

SUITE 104

- ±6,264 SF
- ±15% Office
- Lease Term through 07/31/2025 *
- 2 Dock High Doors
- 1 Grade Level Doors
- 18' - 20' Clear Height
- 15'x20' Freezer
- 40'x15' Cold Room

SUITE 105

- ±6,264 SF
- ±15% Office
- Lease Term through 07/31/2025 *
- 1 Dock High Doors
- 2 Grade Level Doors
- 18' - 20' Clear Height
- 30'x60' Cold Room



* Longer lease term available on a direct basis with Landlord

CONTACT

Jackson Childers

+1 858 352 2905

jackson.childers@jll.com

CA License #02224366

Greg Lewis

+1 858 410 1251

greg.lewis@jll.com

CA License #01365602

Andy Irwin

+1 858 410 6376

andy.irwin@jll.com

CA License #01302674



Although information has been obtained from sources deemed reliable, neither Owner nor JLL makes any guarantees, warranties or representations, express or implied, as to the completeness or accuracy as to the information contained herein. Any projections, opinions, assumptions or estimates used are for example only. There may be differences between projected and actual results, and those differences may be material. The Property may be withdrawn without notice. Neither Owner nor JLL accepts any liability for any loss or damage suffered by any party resulting from reliance on this information. If the recipient of this information has signed a confidentiality agreement regarding this matter, this information is subject to the terms of that agreement. ©2025 Jones Lang LaSalle IP, Inc. All rights reserved.

