



# 801 GRAND

801 Grand Ave, Des Moines, IA 50309





*Over \$20M in capital  
improvements*

## A Perfect Fusion of Traditional Charm & Modern Convenience

In the heart of Des Moines, with its timeless design and elegant detailing, this building pays homage to the rich heritage of its surroundings. The exterior facade showcases intricate craftsmanship, while the interior spaces seamlessly blend historic accents with contemporary elements. Within its walls, state-of-the-art amenities and innovative technologies elevate the experience of today's professionals.







WELLMARK

PRINCIPAL  
FINANCIAL  
GROUP

LUMEN



801 GRAND

RUAN  
CENTER

EQUITABLE  
BUILDING

MARRIOTT

DES LUX  
HOTEL

HUB  
TOWER

FINANCIAL  
CENTER

EMC

NATIONWIDE,  
AMERICAN EQUITY,  
MAVERICKS

AMERICANA

FORD &  
GARLAND

CENTRAL  
LIBRARY

901 PARKING  
GARAGE

UNIVERSITY OF IOWA TIPPIE  
COLLEGE OF BUSINESS - DSM

**The Power of Proximity:**  
The Value of Corporate  
Neighbors



# Tailored for Success

This building possesses remarkable adaptability, enabling it to be easily customized to align with the distinct goals and priorities of any organization.

From open-concept workspaces to collaborative lounges, every area is thoughtfully designed to optimize productivity and foster a sense of community. This truly unique office building offers a captivating and inspiring environment that captures the imagination and invites businesses to thrive in a perfect synergy of past and present.

 **1989-1991 / 2018**  
YEAR BUILT / REMODEL

 **41-Story, Class A**  
BUILDING TYPE

 **±3,671 - ±23,145 RSF**  
UP TO ±115,725 RSF (CONTIGUOUS)

 **2017**  
LEED CERTIFIED

## BUILDING AMENITIES

- Spacious 52-seat conference center and 12 seat conference room.
- Pre-function hospitality room including catering kitchen to welcome guests prior to your event.
- Outdoor patio for social gatherings.
- Luxurious lounge area, offering a sophisticated retreat for relaxation and socializing.
- Four miles of skywalk access puts all of downtown's amenities steps away.
- **NEW** Recently completed fitness center (2024).
- Private and city owned parking garages and flat lots nearby, offering tenants an economical options for parking.
- 24-hr staffed building security. Key card access to floors 4-41. Guests must check-in with security to access tenant spaces.
- On-site and full-time JLL dedicated property management team.
- On-site restaurants: **801 Chophouse, Basil Properi, Main Street Cafe, Fresh Fit Meals.**

**40<sup>th</sup> Floor:** ±5,259 RSF

**39<sup>th</sup> Floor:** ±3,451 RSF

**38<sup>th</sup> Floor:** ±18,002 RSF

**35<sup>th</sup> Floor:** ±6,364 RSF

**31<sup>st</sup> Floor:** ±5,791 RSF

**30<sup>th</sup> Floor:** ±19,587 RSF

**29<sup>th</sup> Floor:** ±20,922.58

**\*7,751 RSF**

**\*9,543 RSF**

**23<sup>rd</sup> Floor:** ± 23,145 RSF

**22<sup>nd</sup> Floor:** ± 23,145 RSF

**21<sup>st</sup> Floor:** ± 23,145 RSF

**20<sup>th</sup> Floor:** ± 23,145 RSF

**▼ 3<sup>rd</sup> Floor:** ±2,734 RSF  
±1,974 RSF



# Embrace the Versatility

Our customizable floorplates can be tailor-made to suit the specific needs and requirements of businesses, ensuring the efficient use of space and optimal workflow.

Tenants have the freedom to design their ideal workspace, incorporating features such as private offices, collaborative areas, conference rooms, and amenities. This enables businesses to create an environment that fosters productivity, collaboration, and employee satisfaction.

Typical Floorplate  
**± 23,145 RSF | ± 96 Workstations**

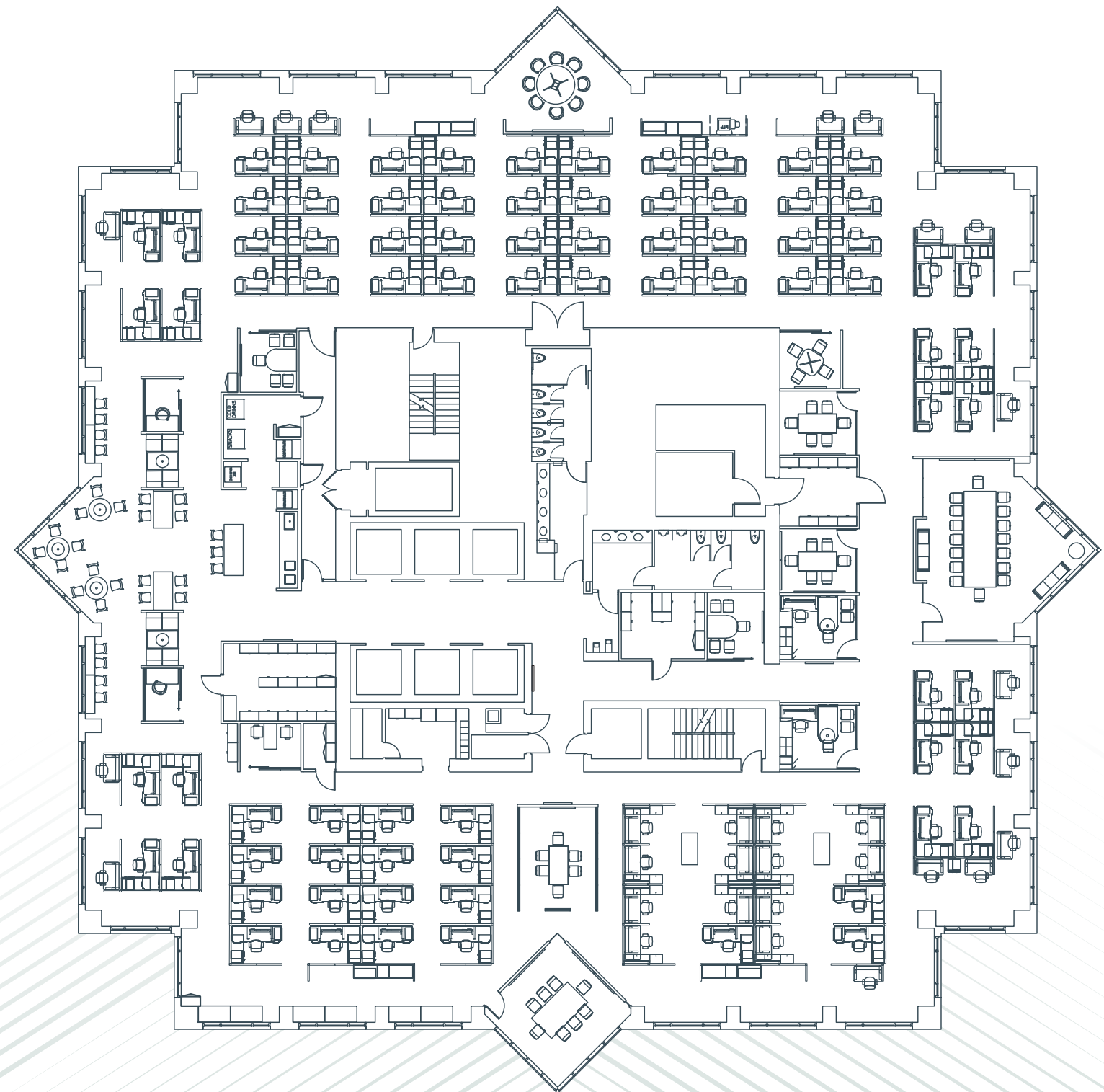



# Des Moines' Central Hub of Amenities

801 Grand offers an abundance of nearby amenities that cater to every need and desire.

From a dazzling array of restaurants, cafes, and entertainment venues to a diverse range of retail shops, fitness centers, and recreational facilities, this location ensures that convenience and enjoyment are always within reach. With an extraordinary selection of amenities just a stone's throw away, 801 Grand provides an unrivaled experience where every aspect of work, life, and leisure coalesce seamlessly.

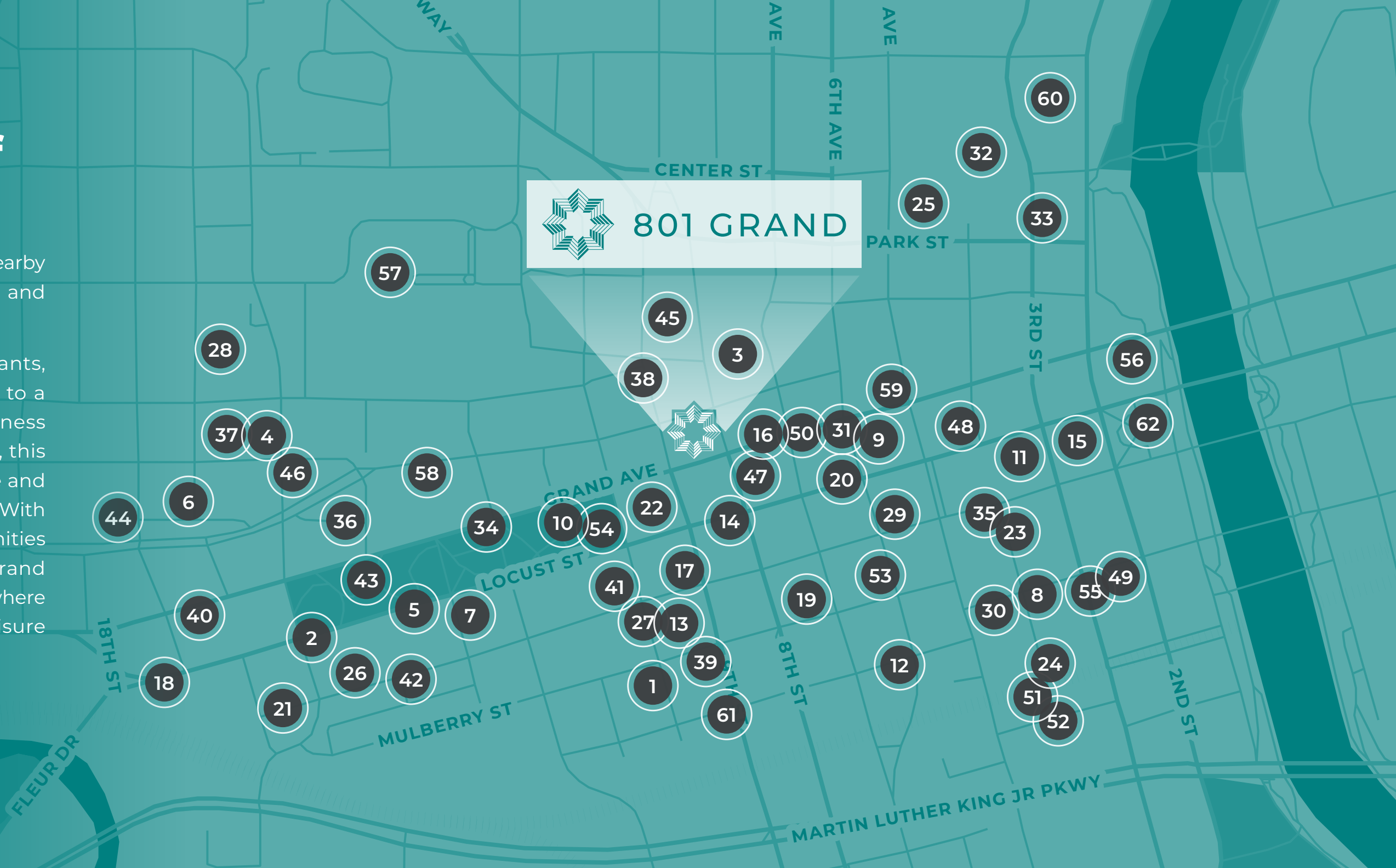

- |   |  |   |  |  |   |
|---|--|---|--|--|---|
| 1. 10th Street Lofts                      | 12. DART Central Station                       | 22. FHLB  | 32. Iowa Events Center                       | 43. Pappajohn Sculpture Park                 | 54. Temple for Performing Arts/Centro                 |
| 2. 14Forty                                | 13. Dentons Davis Brown/Akebono 515            | 23. Fong's Pizza/The Royal Mile/Insomnia Cookies/Pho Real Kitchen & Bar | 33. Jethro's BBQ All Stars                   | 44. Power Life Yoga Barre Fitness - Downtown | 55. The CC / Stuffed Olive                            |
| 3. 801 Chophouse/Basil's/Main Street Cafe | 14. Des Lux Hotel                              | 24. Hessen Haus   | 34. John and Mary Pappajohn Education Center | 45. Principal Financial Group                | 56. U.S. Federal Courthouse                           |
| 4. A Dong Restaurant                      | 15. Des Moines Civic Center                    | 25. Hilton Des Moines Downtown  | 35. Kirkwood Lofts/Wasabi Tao                | 46. QuikTrip                                 | 57. UnityPoint Health - Iowa Methodist Medical Center |
| 5. Americana                              | 16. Des Moines Marriott Downtown               | 26. Horizon Line Coffee   | 36. Krause Gateway Center                    | 47. R&T Lofts/Hello Marjorie                 | 58. Wellmark Blue Cross and Blue Shield               |
| 6. Big Grove Brewery & Taproom            | 17. Des Moines Public Schools                  | 27. Hotel Fort Des Moines   | 37. Lua Brewing                              | 48. Renaissance Des Moines Savery Hotel      | 59. Wellmark YMCA                                     |
| 7. Blu Thai Food and Sushi                | 18. Dot-Dash (formerly Meredith Corp.)         | 28. Hoyt Sherman Place  | 38. Lumen                                    | 49. RoCA                                     | 60. Wells Fargo Arena                                 |
| 8. Blue Sushi Sake Grill                  | 19. EMC Insurance Companies Headquarters       | 29. Hub Tower   | 39. Malo                                     | 50. Ruan Center                              | 61. West End Architectural Salvage                    |
| 9. Capital Square                         | 20. Equitable Building/Pot Belly Sandwich Shop | 30. Hy-Vee Grocery Store  | 40. Mid-American Energy                      | 51. Rumely Lofts                             | 62. World Food Prize Hall of Laureates                |
| 10. Central Library                       | 21. Exile Brewing Company                      | 31. Hyatt Place Des Moines/Downtown                                     | 41. Nationwide                               | 52. Science Center of Iowa                   |   |
| 11. Cowles Commons                        |  |   | 42. Noce                                     | 53. Surety Hotel                             |   |





# 801 GRAND

For Leasing:

**Justin Lossner, CCIM, SIOR**

Senior Managing Director

+1 515 371 0846

[justin.lossner@jll.com](mailto:justin.lossner@jll.com)

**Lucas Hedstrom**

Vice President

+1 515 564 9269

[lucas.hedstrom@jll.com](mailto:lucas.hedstrom@jll.com)



Although information has been obtained from sources deemed reliable, neither Owner nor JLL makes any guarantees, warranties or representations, express or implied, as to the completeness or accuracy as to the information contained herein. Any projections, opinions, assumptions or estimates used are for example only. There may be differences between projected and actual results, and those differences may be material. The Property may be withdrawn without notice. Neither Owner nor JLL accepts any liability for any loss or damage suffered by any party resulting from reliance on this information. If the recipient of this information has signed a confidentiality agreement regarding this matter, this information is subject to the terms of that agreement. ©2024 Jones Lang LaSalle IP, Inc. All rights reserved.