

203A Lawrence Drive, Livermore, CA



For sublease

±28,400 SF Industrial / Manufacturing Space



Greg Matter
CA RE Lic# 01380731
+1 650 480 2220
greg.matter@jll.com

Patrick Metzger
CA RE Lic# 01888895
+1 510 285 5362
patrickj.metzger@jll.com

Ada Wong
CA RE Lic# 02024607
+1 415 395 7277
aday.wong@jll.com

Ivana Maldonado
CA RE Lic# 02230780
+1 510 285 5376
ivana.maldonado@jll.com

Space highlights

Sublease - *direct deal possible*

- Lease Exp: 10/31/2028
- Available now
- Lease Rate: \$1.20 NNN (\$0.23 est OpEx)

Suite A features

- ±9,500 SF of office space
- ±3,000 SF clean room
- Gated yard space
- 2.2/1,000 parking ratio
- HVAC throughout most of the premises
- Gas, air lines and good electrical distribution
- Significant glass line



6 dock high doors
3 grade level doors



22' clear height



600a, 277/480v



0.6gpm/3,000 sf
sprinklers

Floor plan

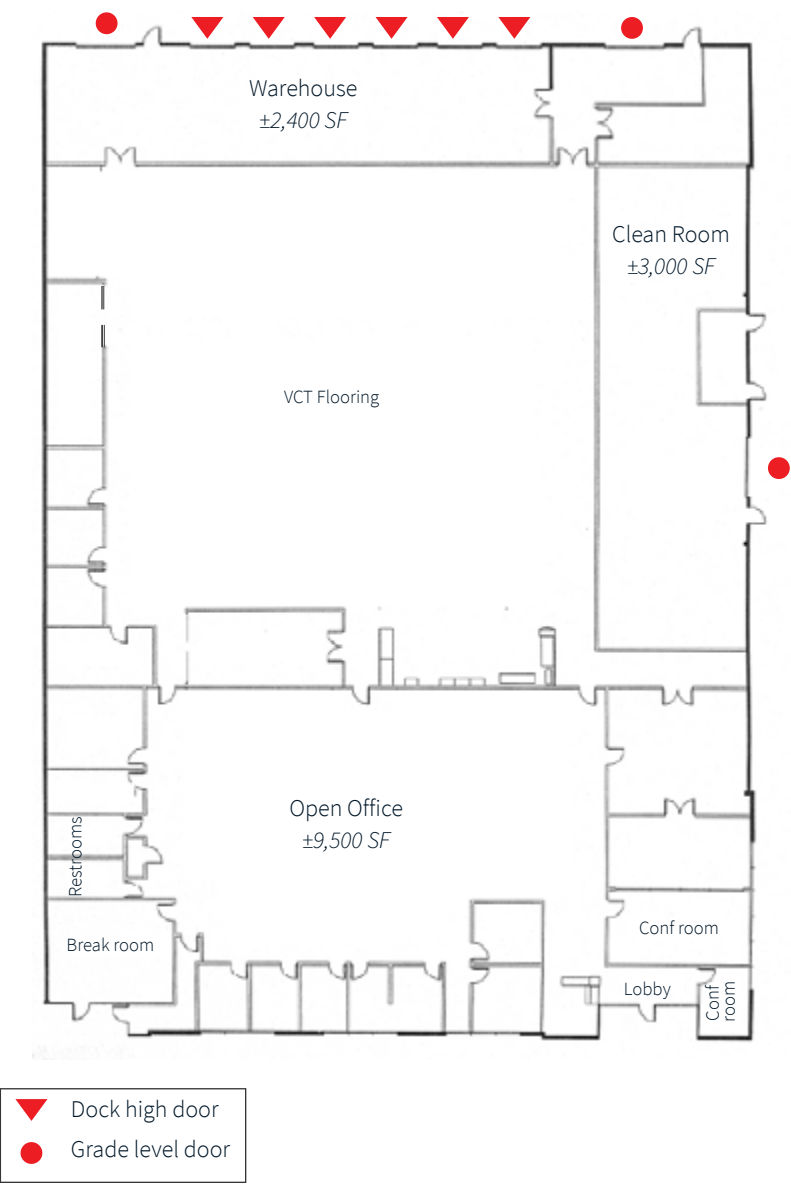

Site plan

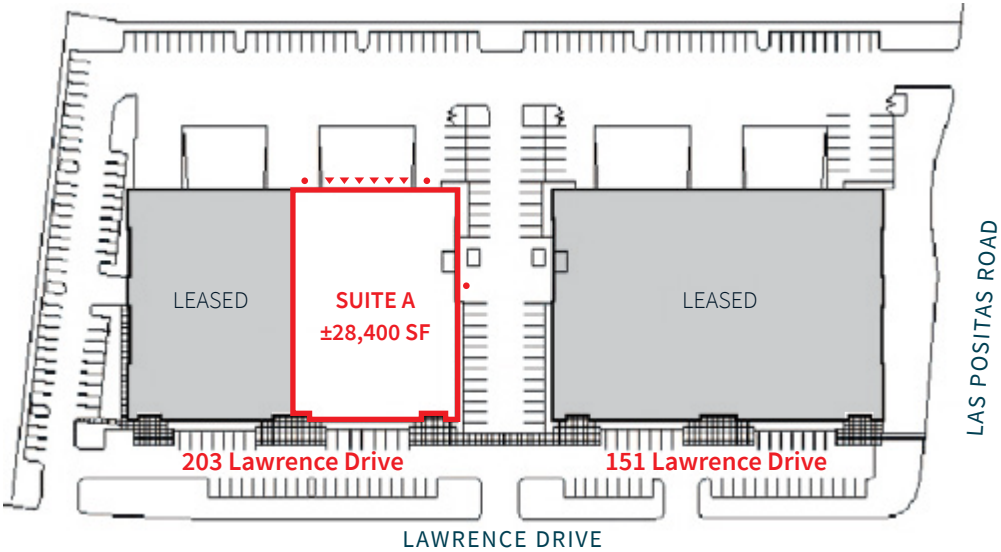

203 Lawrence Drive
Livermore, CA



Drive Times

Downtown Livermore...3 miles (8 minutes)
Oakland.....36 miles (40 minutes)
San Francisco.....48 miles (55 minutes)
San Jose.....40 miles (45 minutes)
Stockton.....37 miles (36 minutes)

Greg Matter
CA RE Lic# 01380731
+1 650 480 2220
greg.matter@jll.com

Patrick Metzger
CA RE Lic# 01888895
+1 510 285 5362
patrickj.metzger@jll.com

Ada Wong
CA RE Lic# 02024607
+1 415 395 7277
aday.wong@jll.com

Ivana Maldonado
CA RE Lic# 02230780
+1 510 285 5376
ivana.maldonado@jll.com

Jones Lang LaSalle Brokerage, Inc.
RE Lic# 01856260

