

# former bank space available for lease



## 1407 broadway

### midtown west retail

**Southwest corner of Broadway & W. 39th Street** available at the base of a 1,100,000 sf office tower, centrally situated between NYC's busiest hubs: **Times Square, Bryant Park, Herald Square, Penn Station & Port Authority**

#### Size

Ground Floor: 4,473 SF  
Lower Level: 564 SF

#### Frontage

Approx. 60'  
wraparound

#### Status

Formerly Capital  
One Bank

#### Possession

Immediate

#### Comments

- Highly-trafficked pedestrian corridor
- 24-hour location that benefits from an extensive amenity base

#### Join best in class F&B concepts:

- Mighty Quinn's Barbeque
- Inday
- Luke's Lobster
- Juice Generation
- Dig
- Salswee
- Heytea

#### Area office tenants include:

- |                   |                     |
|-------------------|---------------------|
| - WeWork          | - Ralph Lauren      |
| - Macy's          | - Signature Bank    |
| - Bank of America | - Kohl's Corp.      |
| - HBO             | - Ernst & Young     |
| - Ann Inc.        | - Victoria's Secret |
| - Bank of China   | - Verizon           |
| - Salesforce      | - GrubHub           |
| - PVH             | - Comcast           |
| - Knotel          |                     |

**Corey J. Zolcinski**

212.812.5707 | corey.zolcinski@jll.com

**Matin Bikdeli**

212.219.2955 | martin.bikdeli@jll.com





# 1407 broadway

## ground floor

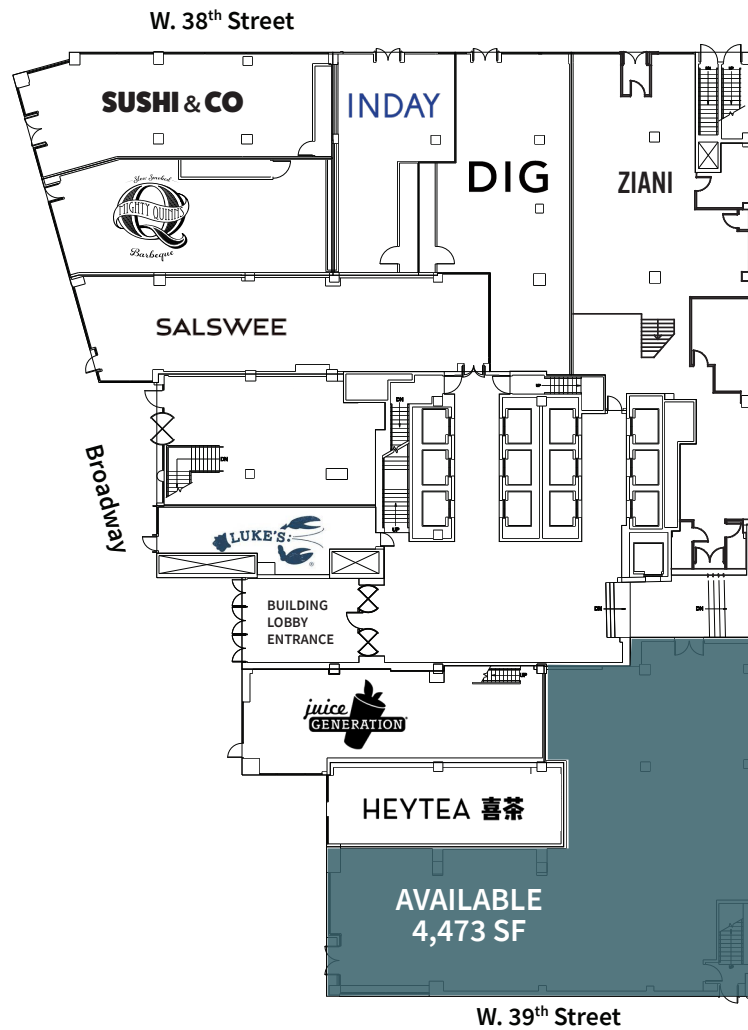

# 1407 broadway

## area retail



AVENUE OF THE AMERICAS

B D F M 7  
16,056,128 annual riders



OLE & STEEN LPQ  
ANGELINA  
STARBUCKS  
VALLEY NATIONAL BANK

With access to 15 subway lines, a dozen bus lines, plus NJ Transit, Amtrak, and PATH, 1407 Broadway is a high traffic location in the heart of Midtown.



**120,228,096**  
total area  
subway ridership



**46,911,644**  
sf of office space



**166,531**  
area employees



**247,312**  
pedestrians weekly



**7,000**  
hotel rooms

\*within a 1/4 mile

