

737 Fourth Avenue

Sunset Park, Brooklyn Retail Spaces for Lease

Between 24th and 25th Streets

| Premises | Size | Frontage | Ceiling Height | Possession | Transportation |
|----------|----------|-------------|----------------|------------|--|
| Retail A | 2,008 sf | Approx. 43' | +/- 13'0" | 3Q 2025 | Across the street from R-train at 25th Street |
| Retail B | 769 sf | Approx. 40' | +/- 14'6" | | |
| Retail C | 2,144 sf | Approx. 38' | +/- 13'6" | | |

Comments

- Prime new construction retail at the base of a 187-unit residential building
- Open to logical divisions
- All uses to be considered
- Dunkin Donuts recently signed in the building



Ryan P. Condren
+1 212 220 4117
ryan.condren@jll.com

George Danut
+1 212 220 4121
george.danut@jll.com

Keat Chew
+1 347 571 3338
keat@kineticreg.com





Ground Floor

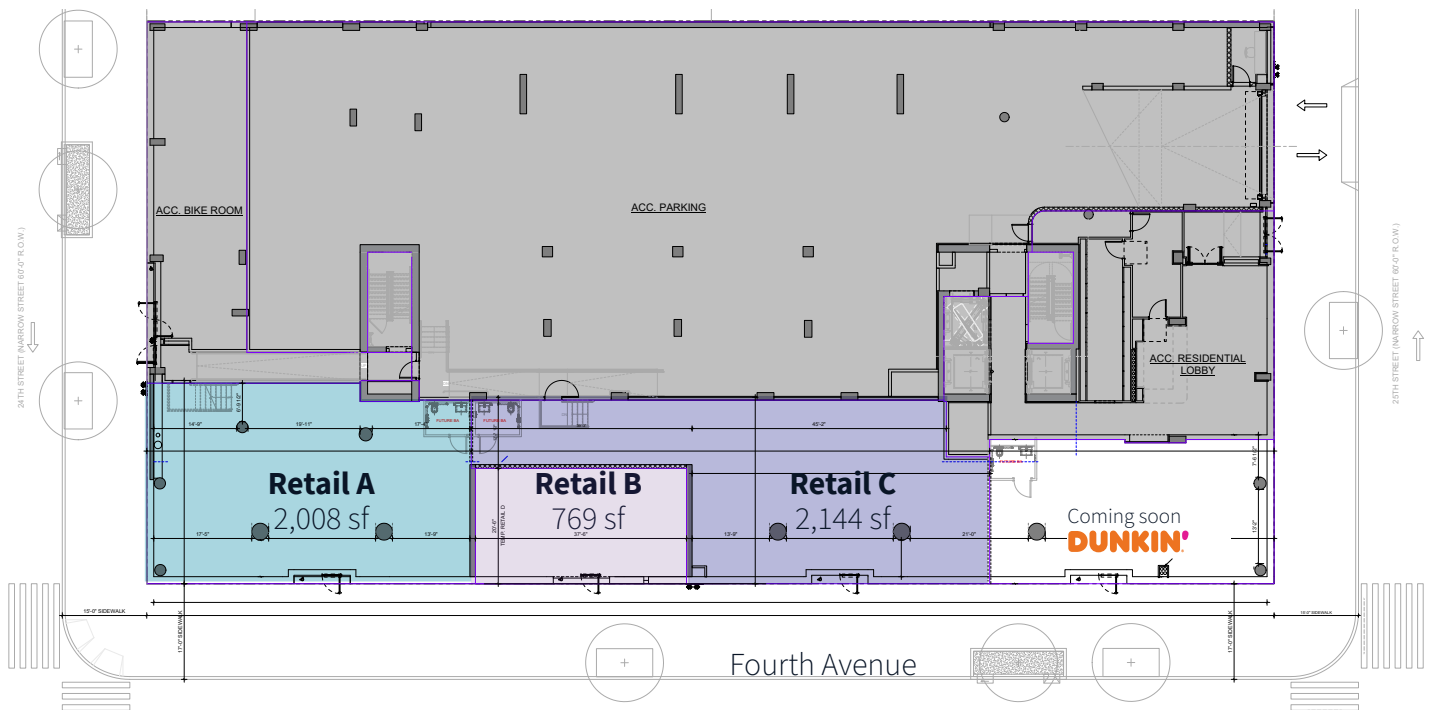

Jones Lang LaSalle Brokerage, Inc.
330 Madison Avenue New York, NY 10017
DISCLAIMER

Although information has been obtained from sources deemed reliable, neither Owner nor JLL makes any guarantees, warranties or representations, express or implied, as to the completeness or accuracy as to the information contained herein. Any projections, opinions, assumptions or estimates used are for example only. There may be differences between projected and actual results, and those differences may be material. The Property may be withdrawn without notice. Neither Owner nor JLL accepts any liability for any loss or damage suffered by any party resulting from reliance on this information. If the recipient of this information has signed a confidentiality agreement regarding this matter, this information is subject to the terms of that agreement. © 2025 Jones Lang LaSalle IP, Inc. All rights reserved.