

..... SOUTHPARK COMMERCE CENTER V

±20,754 RSF FOR SUBLEASE

AVAILABLE 5/1/2025 - 10/31/2027



Jones Lang LaSalle Brokerage, Inc. Real Estate License #01856260

PROPERTY OVERVIEW

PROPERTY ADDRESS	4500 S Pleasant Valley Rd, Suite 205, Austin, TX 78744
PROPERTY DESCRIPTION	100% HVAC
TOTAL SQUARE FEET	±20,754 RSF
POWER	Heavy Power
CLEAR HEIGHT	±28'
DOCKS	6 Dock High Doors
SPRINKLERS	ESFR
PARKING	1.5:1000
SUBLEASE EXPIRATION	October 31, 2027

CONTACT BROKERS TO SCHEDULE TOUR
**SOUTHPARK COMMERCE
CENTER V**

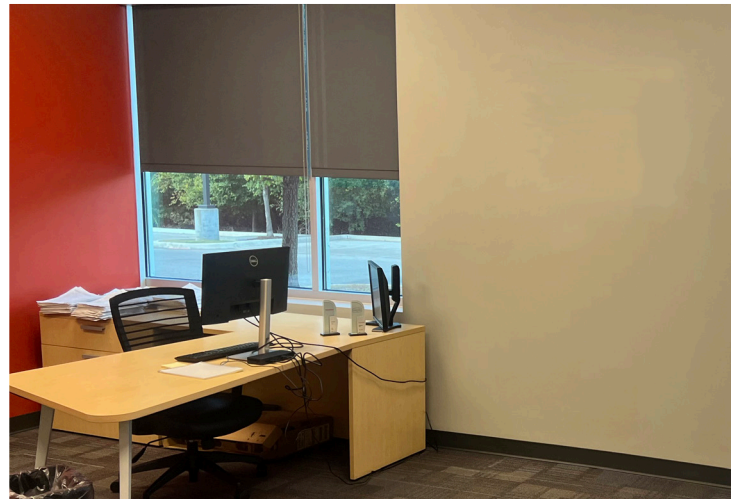

FLOOR PLAN

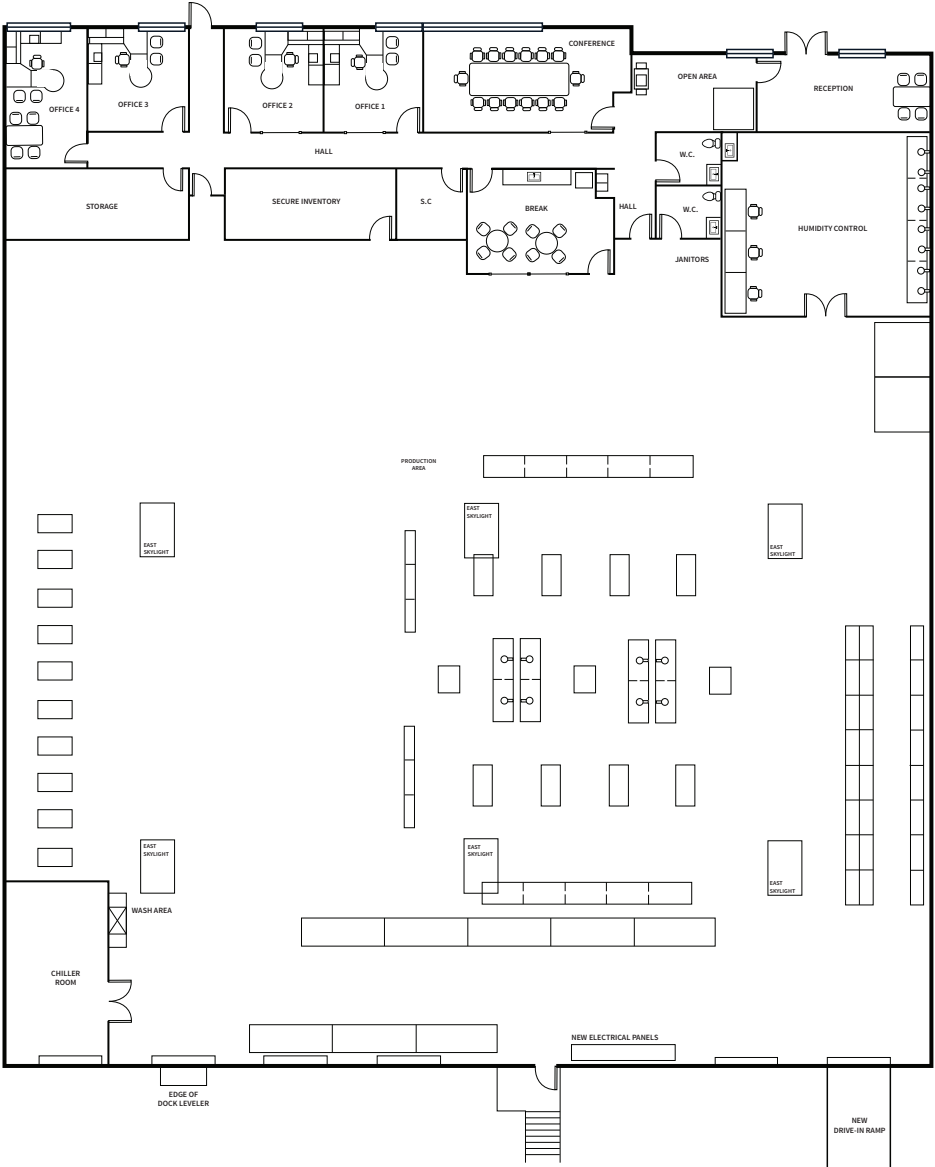

SITE PLAN

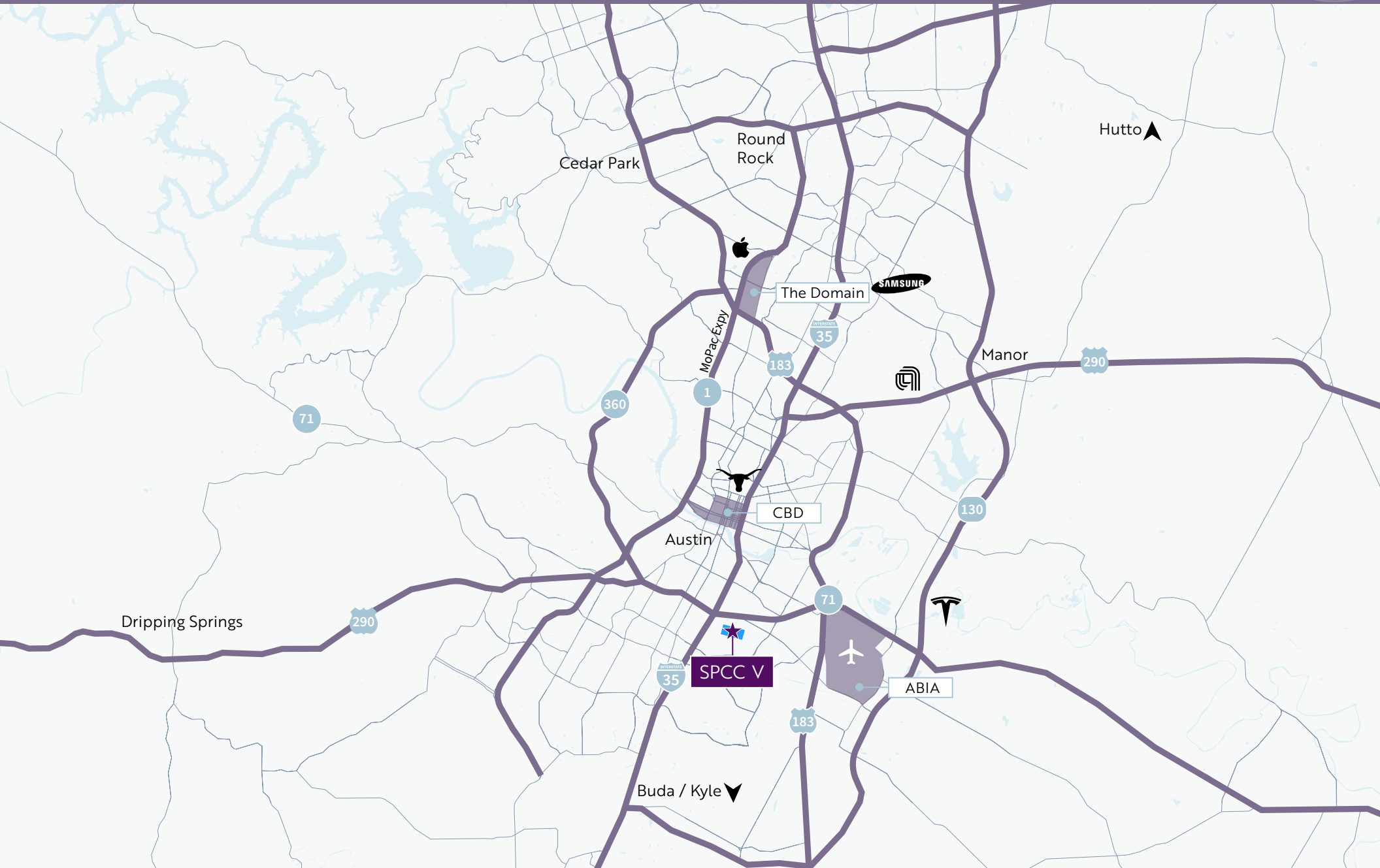

4500

S PLEASANT VALLEY ROAD,
SUITE 205, AUSTIN, TX 78744



FOR MORE INFORMATION, CONTACT

ALEXX MONTANEZ

+1 916 812 7135

alex.montanez@jll.com

ZANE COLE

+1 512 636 1657

zane.cole@jll.com

Although information has been obtained from sources deemed reliable, JLL does not make any guarantees, warranties or representations, express or implied, as to the completeness or accuracy as to the information contained herein. Any projections, opinions, assumptions or estimates used are for example only. There may be differences between projected and actual results, and those differences may be material. JLL does not accept any liability for any loss or damage suffered by any party resulting from reliance on this information. If the recipient of this information has signed a confidentiality agreement with JLL regarding this matter, this information is subject to the terms of that agreement. ©2025 Jones Lang LaSalle Brokerage, Inc. All rights reserved.