

# 255 Utah Avenue

S. San Francisco, CA



**For Sublease**

**LED: 6/30/2028**

**+/-12,104 SF Total (Suite 150-175)**



**Jason Cranston**  
Senior Managing Director  
+1 650 480 2100  
[jason.cranston@jll.com](mailto:jason.cranston@jll.com)

**Anthony Deggelman**  
Vice President  
+1 925 786 1403  
[anthony.deggelman@jll.com](mailto:anthony.deggelman@jll.com)

Although information has been obtained from sources deemed reliable, JLL does not make any guarantees, warranties or representations, express or implied, as to the completeness or accuracy as to the information contained herein. Any projections, opinions, assumptions or estimates used are for example only. There may be differences between projected and actual results, and those differences may be material. JLL does not accept any liability for any loss or damage suffered by any party resulting from reliance on this information. If the recipient of this information has signed a confidentiality agreement with JLL regarding this matter, this information is subject to the terms of that agreement. ©2023, Jones Lang LaSalle IP, Inc. All rights reserved.

**jll.com**

# FLOOR PLAN



## Industrial space for Sublease

### Property highlights

- +/-12,104 SF Total
- +/-1,416 SF office (3 privates, conference room, open area, kitchenette and 2 restrooms)
- Two (2) Grade-level doors
- Clear Height: 16' – 18'
- Power: Two 100AMP/240V single phase panels and one 200AMP/240V 3-phase
- Fire Sprinklers
- Skylights
- Parking: +/- 9 unreserved stalls
- Sublease Term through 6/30/2028
- Rate: 1.50 NNN (OPEX est. \$0.56/SF)
- *Whole building of +/-33,112 SF is Available on a Direct Basis*

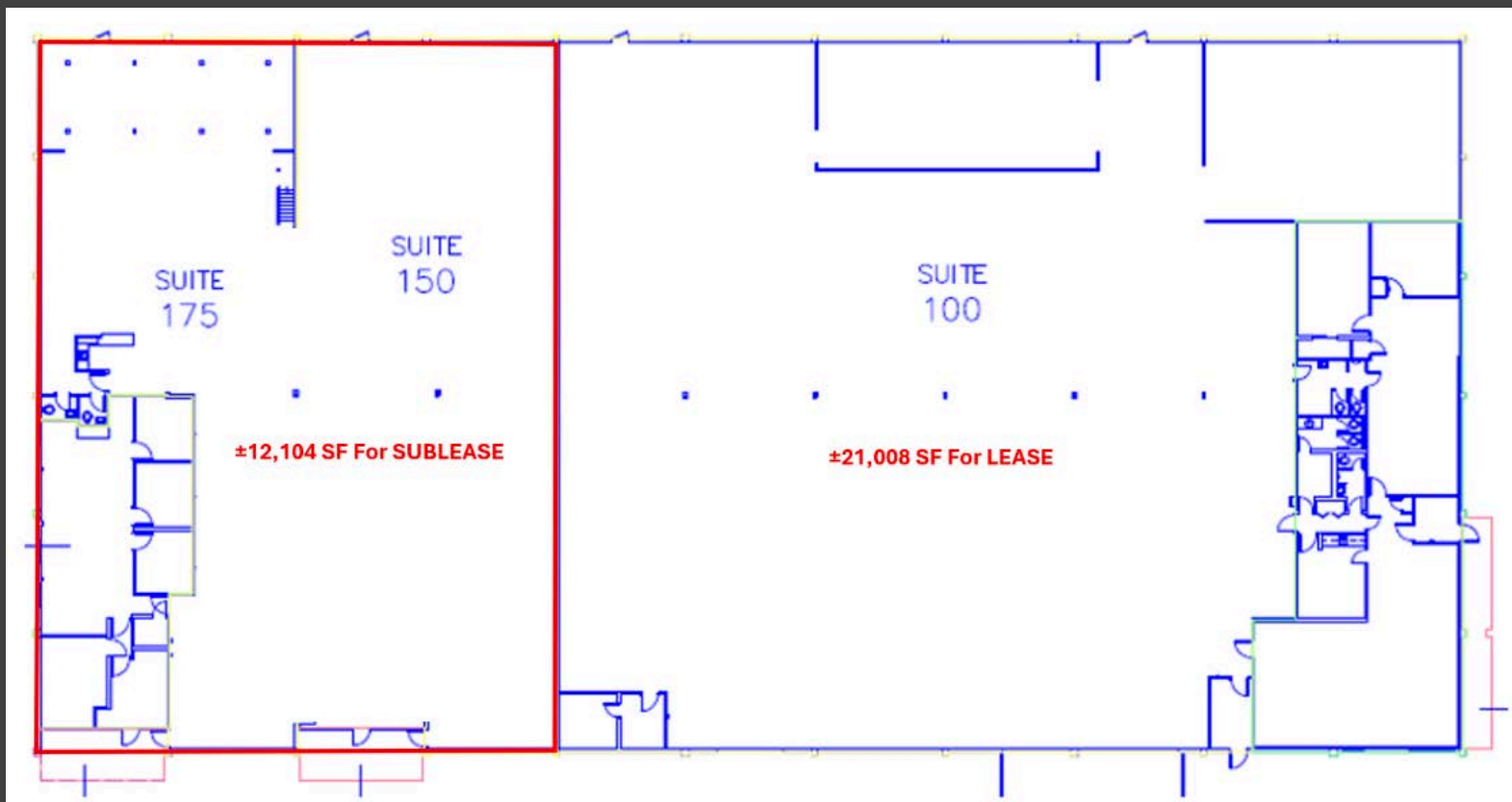



# CONTACT INFO

**Jones Lang LaSalle Brokerage, Inc.**



## Contact broker for pricing information:

**Jason Cranston**

Senior Managing Director

+1 650 480 2100

[jason.cranston@jll.com](mailto:jason.cranston@jll.com)

**Anthony Deggelman**

Vice President

+1 925 786 1403

[anthony.deggelman@jll.com](mailto:anthony.deggelman@jll.com)

Although information has been obtained from sources deemed reliable, neither Owner nor JLL makes any guarantees, warranties or representations, express or implied, as to the completeness or accuracy as to the information contained herein. Any projections, opinions, assumptions or estimates used are for example only. There may be differences between projected and actual results, and those differences may be material. The Property may be withdrawn without notice. Neither Owner nor JLL accepts any liability for any loss or damage suffered by any party resulting from reliance on this information. If the recipient of this information has signed a confidentiality agreement regarding this matter, this information is subject to the terms of that agreement. © 2023 Jones Lang LaSalle IP, Inc. All rights reserved.