

2121 K Street NW

WASHINGTON, DC

2nd generation restaurants with full vent in place and tremendous outdoor seating.

3,933 SF

HOMEslyce
Leased

K ST NW - 31,200 VPD

Andy Corno
Managing Director
O: 202 719 6137
M: 301 520 2620
Andy.Corno@jll.com

Thomas Jackman
Managing Director
O: 202 719 5624
M: 301 580 1512
Thomas.Jackman@jll.com



Trade Area

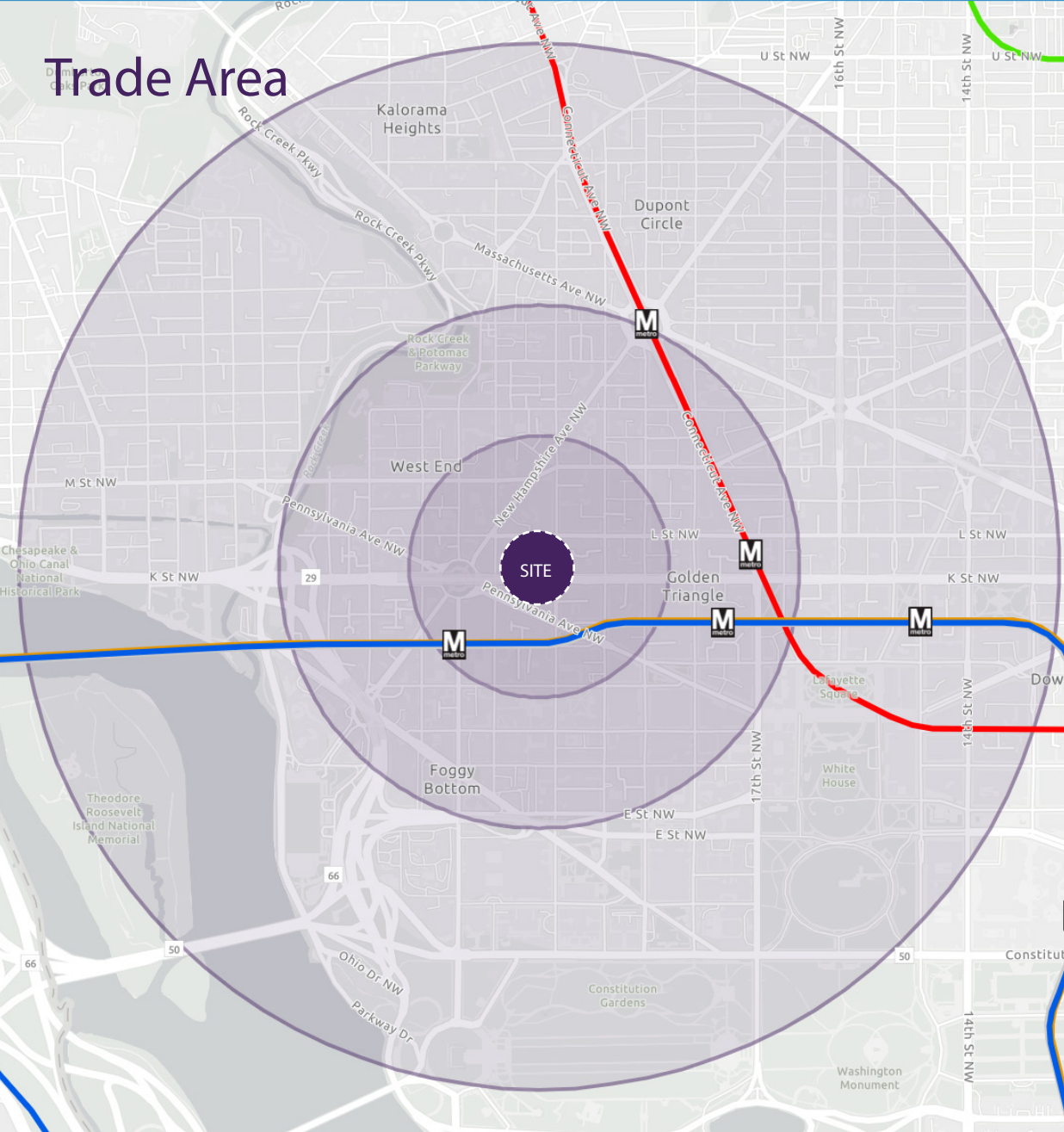

HIGHLIGHTS

- 3,933 SF available for lease
- Second generation restaurant space with tremendous outdoor seating available
- Located on the ground floor of a 190,000 SF Class A office building
- Profound demographics at the intersections of where West End meets CBD and Foggy Bottom
 - 6,578 residential units within .5 miles
 - 43.5M SF office space within .5 miles
 - 6,066 hotel rooms within .5 miles
- Close proximity to George Washington University with approximately 26,000 students
- Amenity rich location with strong national and local retailers

DEMOGRAPHICS

(Radius of .25 mile, .5 mile, and 1 mile)

Population

3,331	21,432	51,708
-------	--------	--------

Average HH Income

\$112,403	\$137,799	\$167,087
-----------	-----------	-----------

Households

1,179	9,997	28,947
-------	-------	--------

Employees

41,008	154,329	318,199
--------	---------	---------

Median Age

23.2	26.7	33.2
------	------	------

Andy Corno
Managing Director
O: 202 719 6137
M: 301 520 2620
Andy.Corno@jll.com

Thomas Jackman
Managing Director
O: 202 719 5624
M: 301 580 1512
Thomas.Jackman@jll.com



TFC



Co-Tenancy



Andy Corno
 Managing Director
 O: 202 719 6137
 M: 301 520 2620
 Andy.Corno@jll.com

Thomas Jackman
 Managing Director
 O: 202 719 5624
 M: 301 580 1512
 Thomas.Jackman@jll.com



TFC



floorplan

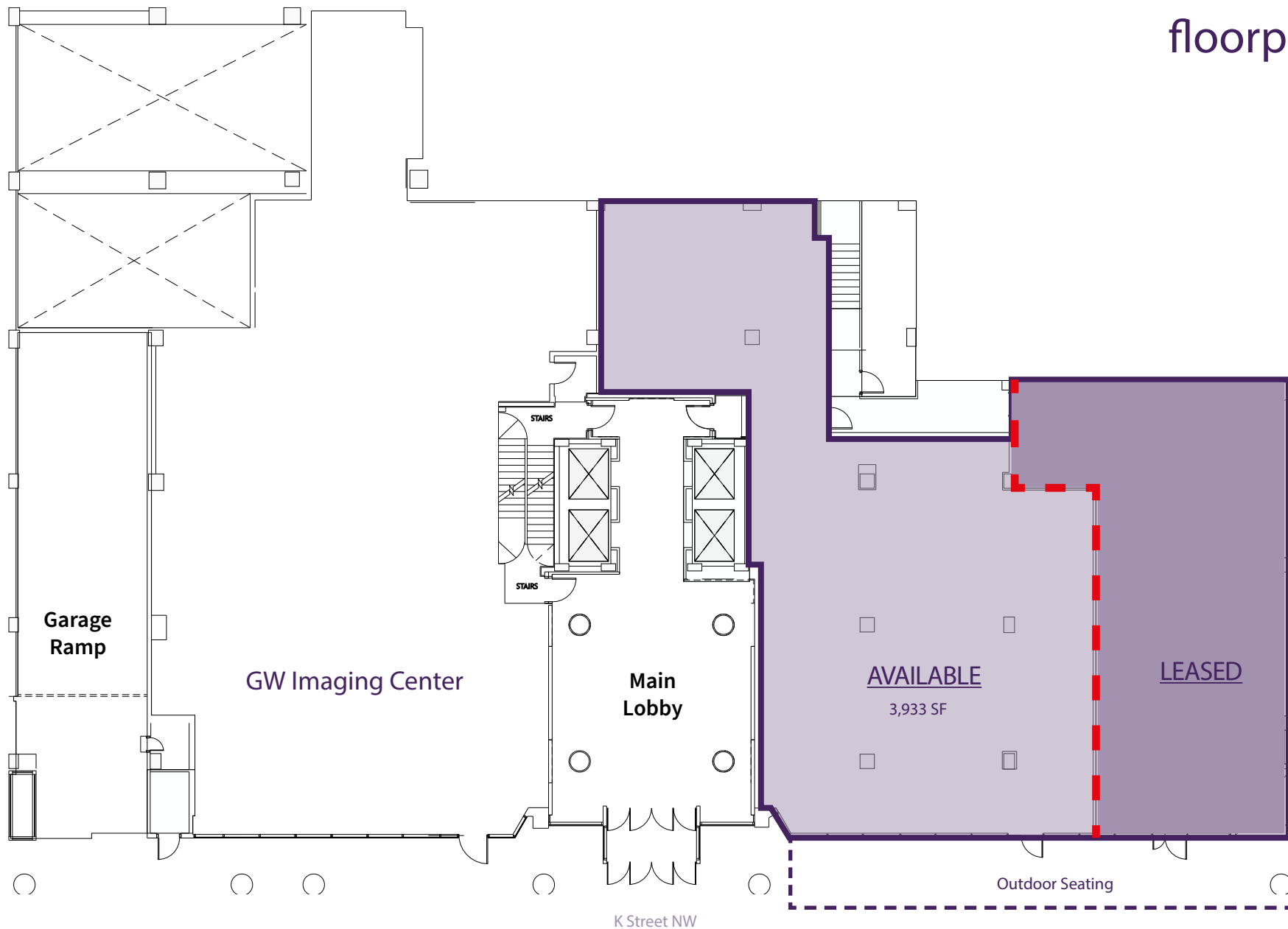

Andy Corno
Managing Director
O: 202 719 6137
M: 301 520 2620
Andy.Corno@jll.com

Thomas Jackman
Managing Director
O: 202 719 5624
M: 301 580 1512
Thomas.Jackman@jll.com



TFC

