

# RETAIL SPACES FOR LEASE

**SUITE A**  
**Up to 1,452 SF**  
Warm shell

**SUITE B**  
**566 SF**  
2nd gen QSR

## Prime Eye Street retail opportunities

### Opportunity highlights

- Suite A: 1,000-1,452 SF, warm shell condition
- Suite B: 566 SF; 2nd generation QSR space
- Potential outdoor seating opportunity
- Excellent location across from Farragut West Metro Station - blue, orange and silver metro lines
- 22,374 riders at Farragut West Metro per weekday
- Tremendous daytime population with over 9 million square feet of office space within 2 blocks

### CBD highlights

- The heart of DC's business district
- 85,000 professionals
- 124,477 metro entrances
- 1,608 trips made by metro bus

## 1808 Eye Street NW Washington, DC

### **Andy Corno**

202 719 6137  
[andy.corno@jll.com](mailto:andy.corno@jll.com)

### **Thomas Jackman**

202 719 5624  
[thomas.jackman@jll.com](mailto:thomas.jackman@jll.com)

### **Simms Henschel**

202 533 2529  
[simms.henschel@jll.com](mailto:simms.henschel@jll.com)





# Washington, DC by the numbers



## Demographics from subject site

	1 mi	3 mi	5 mi
Population	51,134	380,291	696,828
Average HH Income	\$141,277	\$147,374	\$140,416
Households	28,718	195,380	365,533
Employees	244,791	581,010	742,725
Businesses	14,498	30,651	42,804

**9.3M**  
Greater DC area population

**670,000**  
District Population

**250+**  
Museums and monuments

**65**  
Professional theaters

**5**  
Major sports team

**\$6.7B**  
Annual visitor spending

**20M+**  
Annual visitors

## Surrounding retail



19th Street  
11,400

I Street  
14,400

18th Street  
14,300

 VEHICLES  
PER DAY



1808 Eye Street, NW



# The space

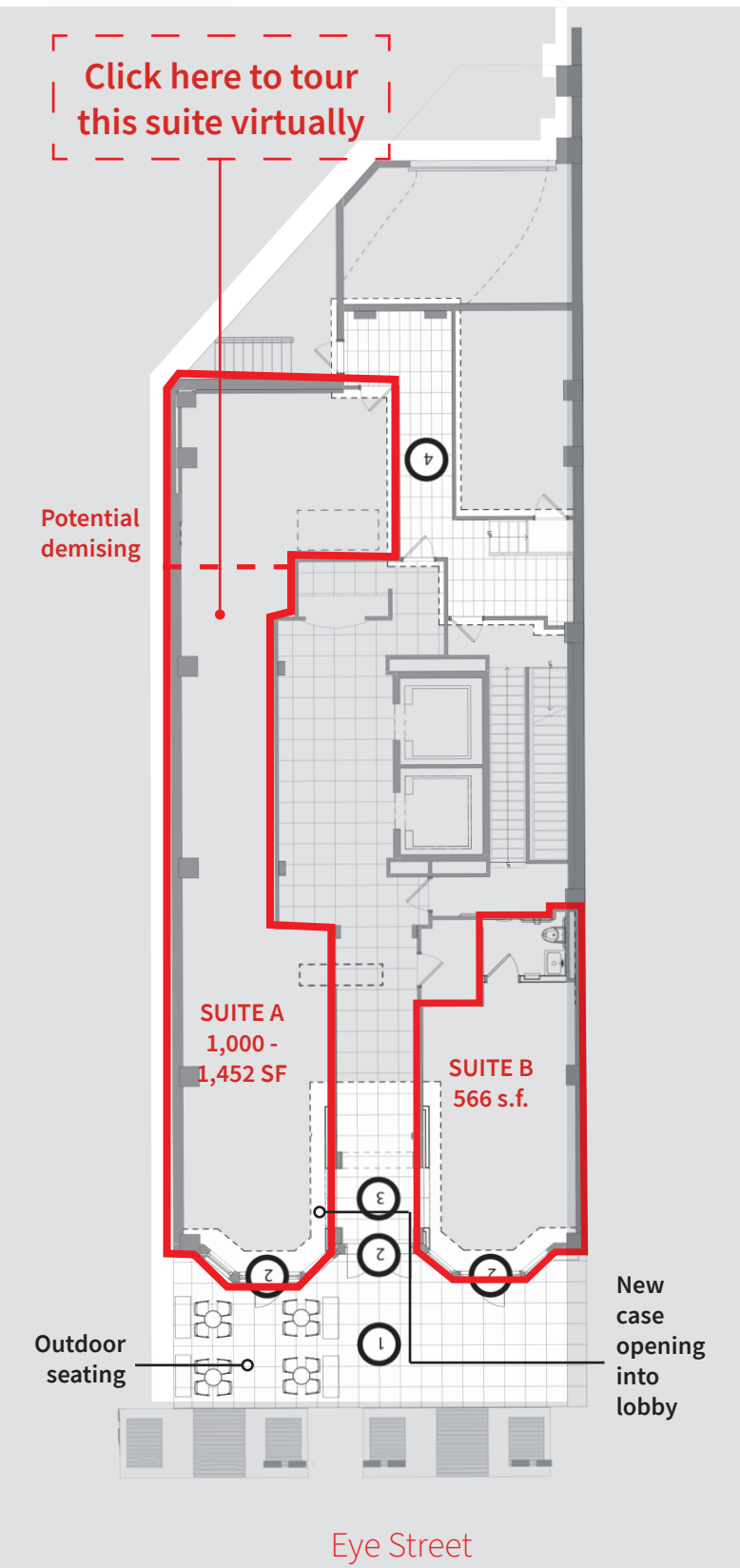

For more information, please contact:

**Andy Corno**

202 719 5000

[andy.corno@jll.com](mailto:andy.corno@jll.com)

**Thomas Jackman**

202 719 5000

[thomas.jackman@jll.com](mailto:thomas.jackman@jll.com)

**Simms Henschel**

202 533 2529

[simms.henschel@jll.com](mailto:simms.henschel@jll.com)

