



## CHANDLER FREEWAY CROSSING

2625 W Geronimo Place, Chandler, AZ

**±156,823 SF**

THREE-STORY CLASS A, OFFICE BUILDING



# YOUR NEXT CORPORATE HOME

Located in the heart of the Price Road Corridor, 2625 at Chandler Freeway Crossing (2625 West Geronimo Place) is the ideal opportunity for a user seeking a corporate campus environment.

 [Click Here for Property Virtual Tour](#)

## AVAILABLE IMMEDIATELY

-  ±6,193 SF spec suite available
-  Easy access to Loop 101 and 202 freeways
-  1/2 mile freeway frontage
-  60' tall freeway monument sign
-  6.5/1,000 parking  
Surface and garage parking
-  Access to gorgeous rooftop amenity deck
-  Direct bridge access from parking to building
-  Ground floor seating area adjacent to food truck court

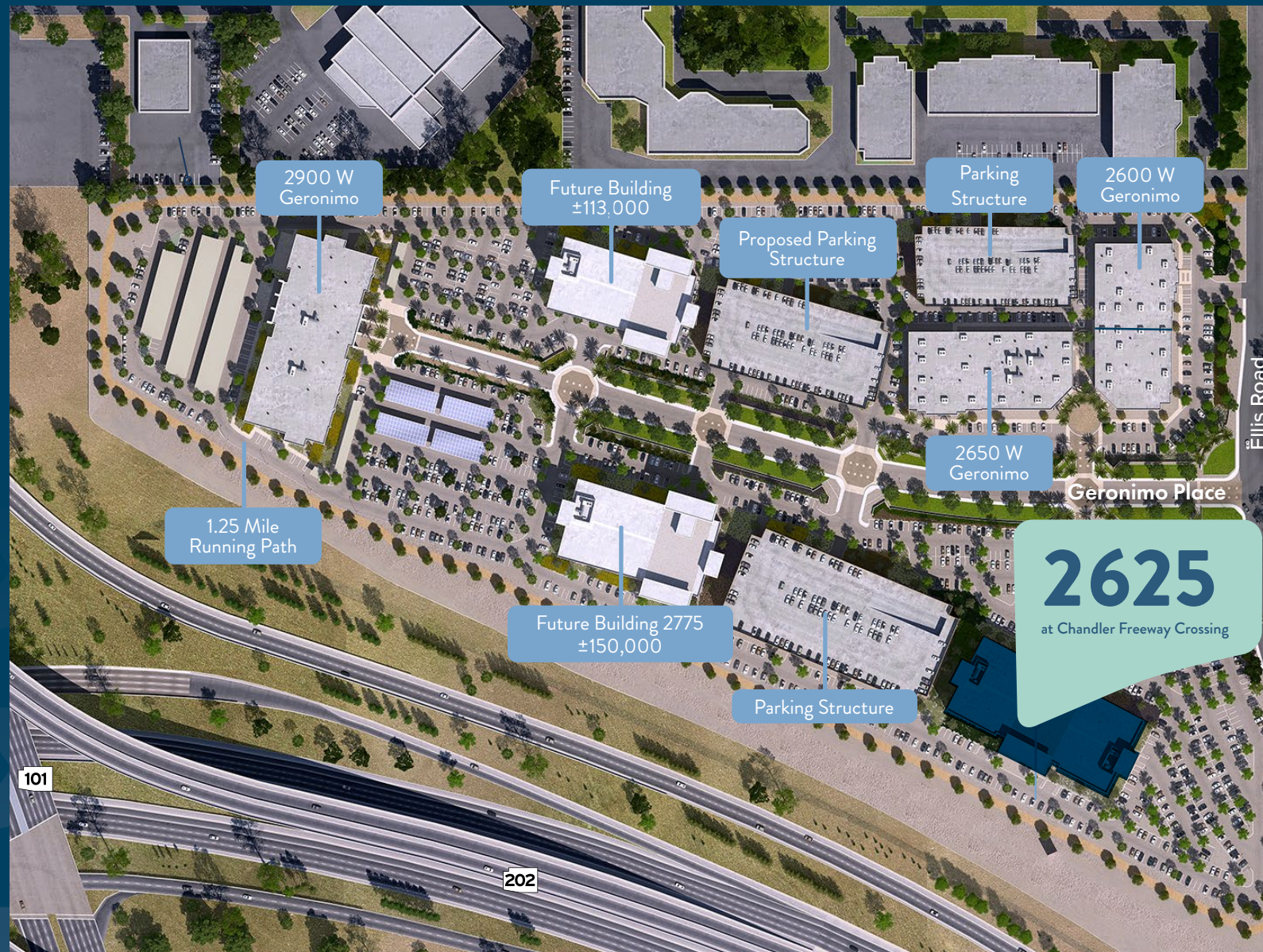



# MORE USER EFFICIENCY

Built to LEED certifiable standards with:



± 156,823 SF  
Three-story  
class a  
office building



±52,000 SF wide  
open floor plates



16' Slab to deck  
clear height



Roof deck for  
tenant use



±6,193 SF spec  
suite available



# FLOOR PLANS

## 3RD FLOOR SPEC PLAN

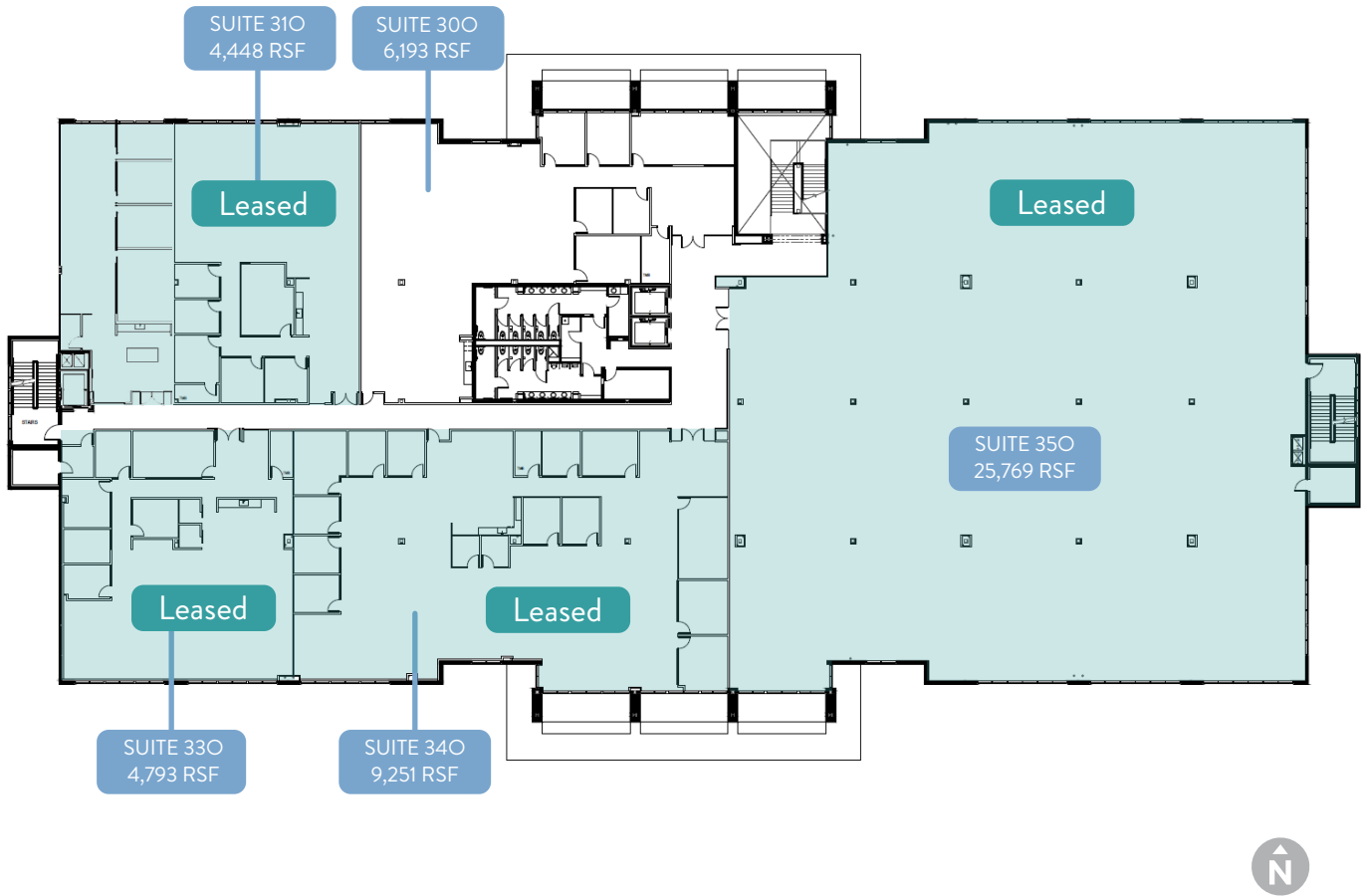



# PUT YOUR FEET UP AND RELAX...



## Chandler's only rooftop amenity deck

Venture upstairs for an outdoor meeting in the fresh air, play a few games on the lawn, or host a cocktail party.

**The Chandler Freeway Crossing rooftop amenity deck features:**

2 Covered patios

Heaters & ceiling fans

Firepits

BBQ area

Expansive multi-purpose grass area

Accommodates groups up to 300

Restrooms



[Click Here for Rooftop Virtual Tour](#)



# THE POWER OF THE SOUTHEAST VALLEY

The Price Road Corridor is an ideal location for leading-edge technology companies and serves as regional headquarters for several notable companies.



**1,840,741** residents within a 30-minute drive time  
**919,482** residents within a 20-minute drive time



**47% population with a college degree** within a 10-mile radius (Age 25+)



Close proximity to ASU's **75,000 students** (Tempe campus)



Over **240 retail and dining amenities**



Within an approximate **18-minute drive time**



**6 hotels** within a 1-mile radius



**NATIONWIDE COMMUNITY RANKINGS\* (2023) INCLUDE:**  
(Rankings by Stacker, Zumper & Niche)



**No. 1** Places to Live in Arizona



**No. 2** Places with Best Schools in Phoenix



**No. 5** Best Cities to Rent in America

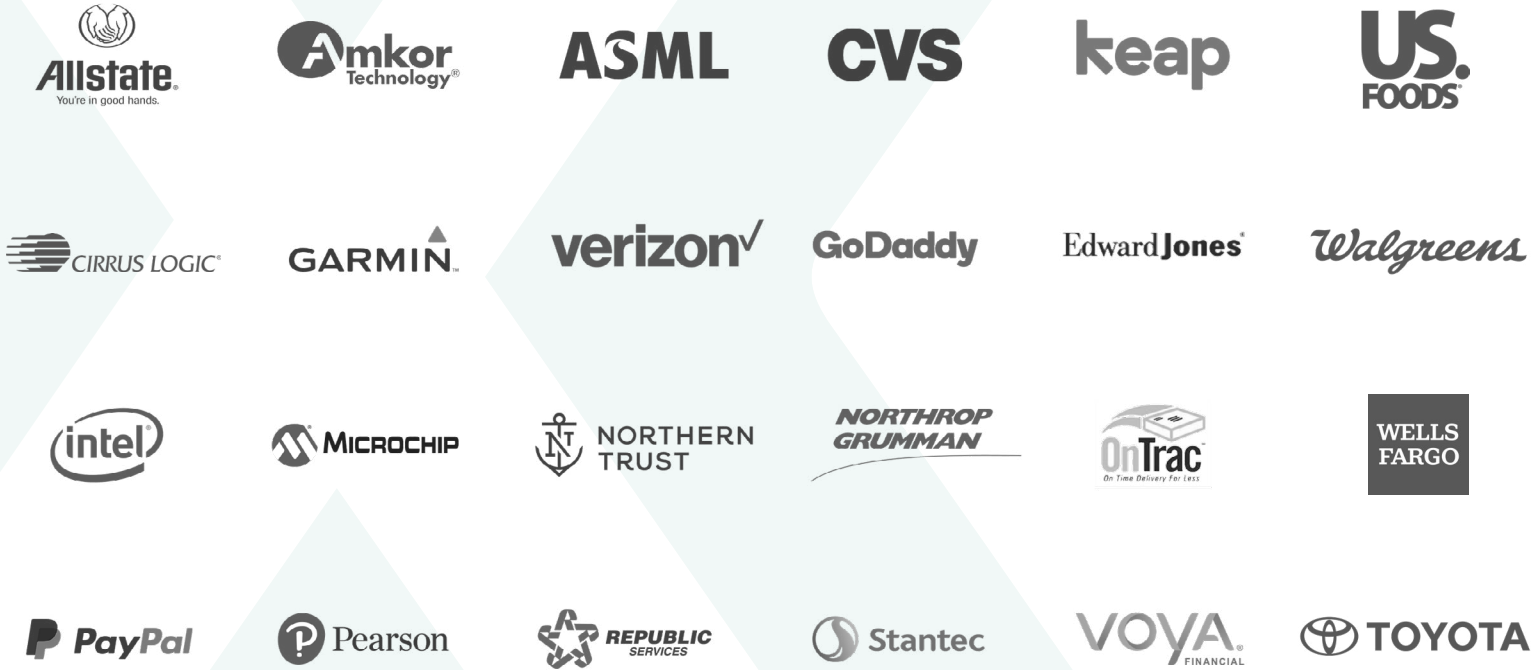

5

 Freeway interchanges within two miles

8

 Minutes to Downtown Chandler

18

 Minutes to Phoenix Sky Harbor Airport

20

 Minutes to ASU & Downtown Tempe

25

 Minutes to Scottsdale



# AMENITIES WITHIN TWO MILES

## Restaurants

- |                            |                                        |                        |                             |
|----------------------------|----------------------------------------|------------------------|-----------------------------|
| Abuelo's                   | Cyclo                                  | Los Taquitos           | Red Robin                   |
| Asian Corner Café          | Dairy Queen                            | Lucky Lou's Grill      | Rocket Burger & Subs        |
| Auntie Anne's              | Doughlicious Desserts                  | Majerle's Sports Grill | Rosati's Pizza              |
| Barro's Pizza              | Doughnuttery                           | McDonald's             | Rubio's                     |
| Beijing Restaurant         | Dunkin' Donuts                         | Meridiem Kitchen       | Starbucks                   |
| Benihana                   | Famous Dave's                          | Mimi's Café            | Steak Escape                |
| Biscuits Café              | Filiberto's                            | Nando's Mexican Café   | Subway                      |
| BJ's Restaurant            | Firebirds                              | Nekter Juice Bar       | Sunny's                     |
| Black Angus                | Fired Pie                              | NYPD Pizza             | Tacos and Tequila           |
| BLD Chandler               | Five Guys                              | Olive Garden           | Thai Express                |
| Boba Tea Company           | Freddy's Frozen Custard & Steakburgers | Oregano's              | Thai Rama                   |
| Buffalo Wild Wings         | Fuzziwig's Candy Factory               | P.F. Chang's           | The Bistro                  |
| Burger King                | Godiva                                 | Panda Express          | The Cheesecake Factory      |
| Café Rio Mexican           | Gyros Express                          | Pastries N Chaat       | The Hungry Monk             |
| Café Zupas                 | Haagen-Dazs                            | Peter Piper Pizza      | The Ivy                     |
| California Pizza Kitchen   | Hibachi-San                            | Pieology Pizza         | The Keg                     |
| Carlo & Emilie's Deli      | In-N-Out Burger                        | Pita Heaven            | The Old Spaghetti Factory   |
| Cheddar's                  | Jack in the Box                        | Pitta Souvli           | Villa Fresh Italian Kitchen |
| Chick-fil-A                | Jamba juice                            | Pizza Hut              | Wendy's                     |
| Chili's                    | Jersey Mike's                          | Planet Sub             | Wetzel's Pretzels           |
| Chipotle Mexican Grill     | Jimmy John's                           | Poke Bar               | Wildflower Bread Co.        |
| Cinnabon                   | KFC                                    | Pokiluv                | Woops! Macarons             |
| Cold Beers & Cheeseburgers | La Hacienda                            | Pokitrition            | Yogi's Grill                |
| Crème & Chocolats          | Los Favoritos Tacos                    | Potato Corner          | Yogurtland                  |
| Culver's                   |                                        | Quizno's               |                             |

## Retail

- |                     |                  |                |             |
|---------------------|------------------|----------------|-------------|
| Abercrombie & Fitch | Best Buy         | Lowe's         | PetsMart    |
| Ann Taylor          | Coach            | Lucky Brand    | Sephora     |
| Anthropologie       | Costco           | Lululemon      | Target      |
| Apple Store         | Dillard's        | Macy's         | ULTA Beauty |
| BareMinerals        | Disney           | Michael Kors   |             |
| Barnes & Noble      | Harkins Theatres | Nordstrom      |             |
| Bath & Body Works   | Hollister        | Nordstrom Rack |             |

## Banks

- |                          |                 |             |                    |
|--------------------------|-----------------|-------------|--------------------|
| Alliance Bank of Arizona | Bank of America | Chase Bank  | Western State Bank |
| AmTrust Bank             | BBVA Bank       | First Bank  |                    |
| Arizona Bank & Trust     | BMO Harris Bank | Wells Fargo |                    |

## Hotels

- |                       |                         |                           |                               |
|-----------------------|-------------------------|---------------------------|-------------------------------|
| Cambria Hotel         | Extended Stay America   | Homewood Suites           | SpringHill Suites by Marriott |
| Chandler Inn          | Fairfield Inn           | Hyatt Place               | Staybridge Suites             |
| Courtyard by Marriott | Hampton Inn & Suites    | Marriott Phoenix Chandler | TownePlace Suites by Marriott |
| Drury Inn & Suites    | Hilton Phoenix Chandler | Residence Inn by Marriott |                               |

## Gyms

- |                              |                             |               |                                |
|------------------------------|-----------------------------|---------------|--------------------------------|
| Anytime Fitness              | Mountainside Fitness Center | Prime Fitness | The Fitness Center at Chandler |
| Chandler/Gilbert Family YMCA | Orangetheory Fitness        | STA Fit       | Triplex Training               |
| F45 Training Chandler North  |                             |               |                                |





**For Leasing Information,  
Contact:**

**Mark Gustin,** SIOR, CCIM  
+1 602 282 6316  
mark.gustin@jll.com

**Jimmy Cornish**  
+1 602 282 6363  
jimmy.cornish@jll.com



MARK  CAPITAL

Although information has been obtained from sources deemed reliable, JLL does not make any guarantees, warranties or representations, express or implied, as to the completeness or accuracy as to the information contained herein. Any projections, opinions, assumptions or estimates used are for example only. There may be differences between projected and actual results, and those differences may be material. JLL does not accept any liability for any loss or damage suffered by any party resulting from reliance on this information. If the recipient of this information has signed a confidentiality agreement with JLL regarding this matter, this information is subject to the terms of that. ©2024 Jones Lang LaSalle Brokerage, Inc. All rights reserved.

