

FOR LEASE

Owned and Operated by  **LINK**

Woodland Business Park

3401 Woodpark Blvd, Charlotte, NC 28206

±15,040 - 44,480 SF



**LEASING INFO
& CONTACT**

Brad Cherry, CCIM, SIOR
Natalie Ceva
Rich Grieder

(704) 927 3013 / brad.cherry@jll.com
(704) 804 5757 / natalie.ceva@jll.com
(704) 804 5783 / rich.grieder@jll.com



This is not an offer or acceptance of an offer to lease space. A lease will only be offered or made in a written agreement signed by landlord. No representation or warranty of any kind is made by landlord unless set forth in a written definitive lease executed by the landlord.

FLOOR PLAN: OPTION #1

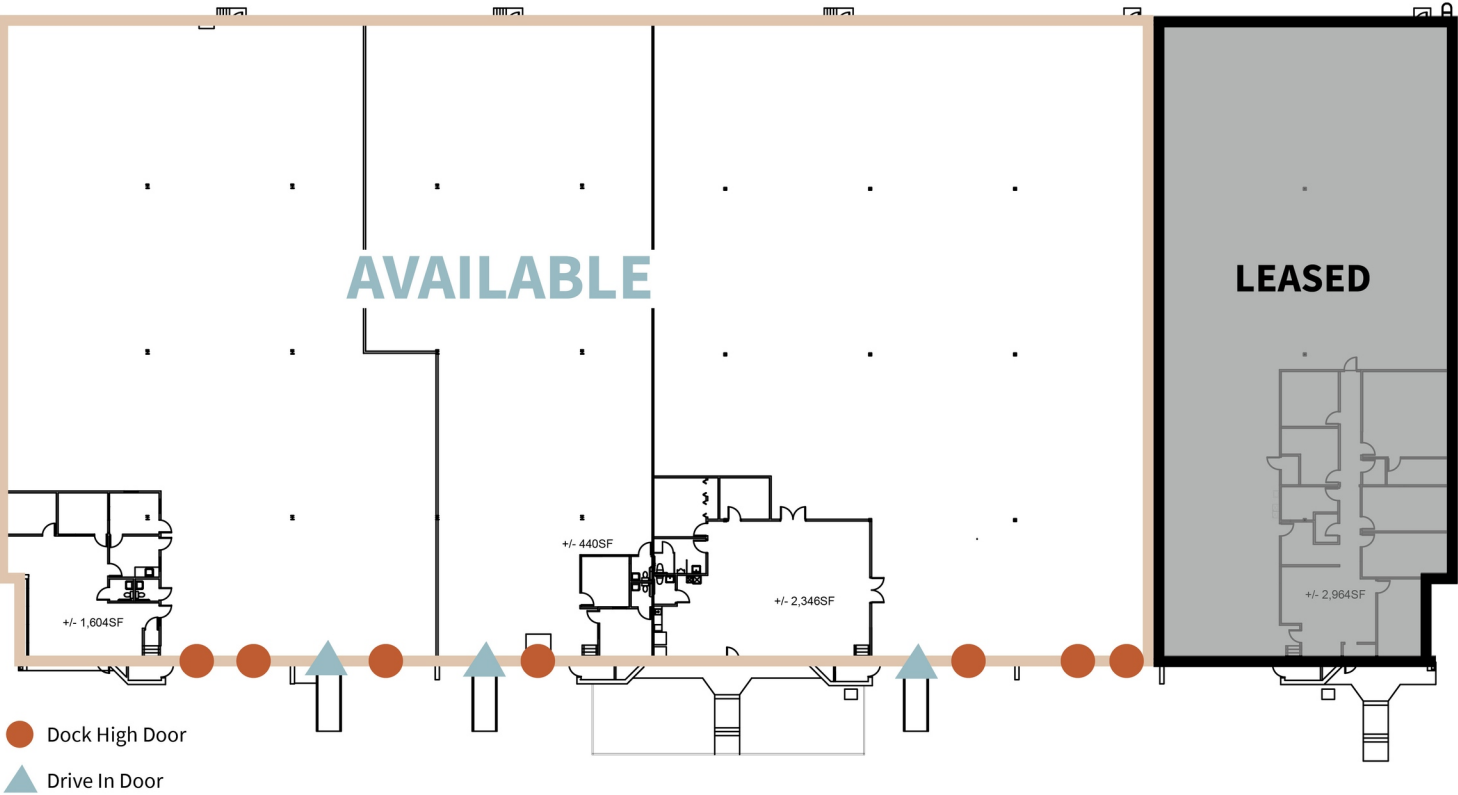

PROPERTY SPECIFICATIONS

Total SF	± 44,480 SF
Office SF	± 4,390 SF
Clear Height	18'
Dock High Doors	7
Drive In Doors	3
Sprinklers	Wet
Zoning	ML-2
Available	11/1/2025



FLOOR PLAN: OPTION #2

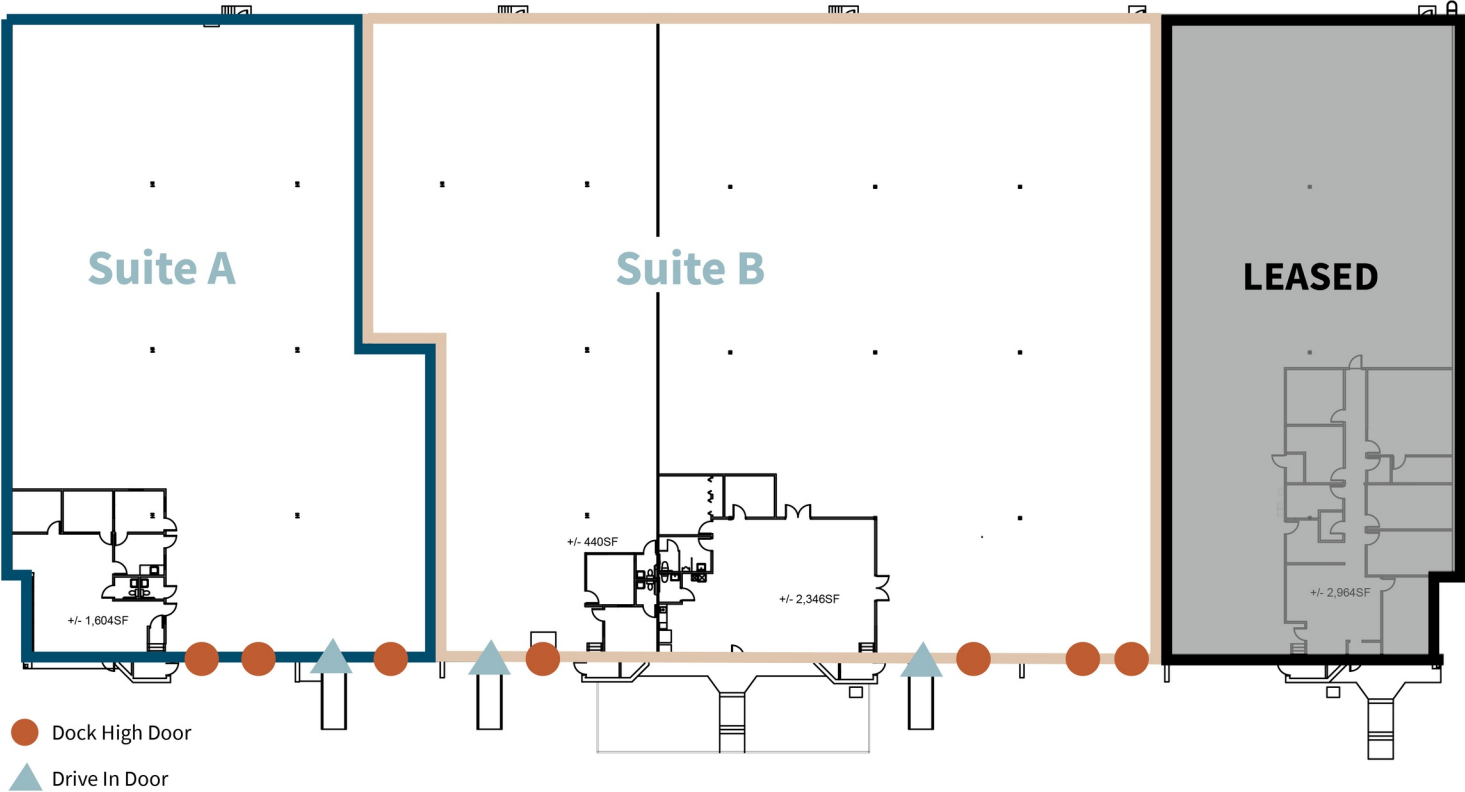

PROPERTY SPECIFICATIONS

Suite A	± 15,400 SF
Office SF	± 1,604 SF
Clear Height	18'
Dock High Doors	3
Drive In Doors	1
Sprinklers	Wet
Zoning	ML-2

AVAILABLE 11/1/2025

Suite B	± 29,080 SF
Office SF	± 2,786 SF
Clear Height	18'
Dock High Doors	4
Drive In Doors	2
Sprinklers	Wet
Zoning	ML-2

DISTANCES

Interstate-77	± 2.0 miles	Charlotte Douglas Airport	± 9.0 miles
Interstate-485	± 9.4 miles	Uptown Charlotte	± 4.5 miles
Interstate-85	± 1.7 miles		

