

# Harrison Plaza

400-460 Bergen Street Harrison, NJ



## 1,200 SF Available for Lease

Located at Harrison's only true shopping center

David Townes  
Managing Director  
+1 917 993 5515  
[david.townes@jll.com](mailto:david.townes@jll.com)

Alana Friedman  
Vice President  
+1 201 741 0990  
[alana.friedman@jll.com](mailto:alana.friedman@jll.com)



## Property Highlights

- » 1,200 SF for lease at Harrison's only true shopping center with abundant parking
- » 2 blocks from the newly renovated PATH station with direct access to NYC
- » Great visibility from Route 280
- » In close proximity to over 6,000 units of residential development
- » Located at a signalized intersection of Frank E. Rodgers Boulevard and Bergen Street
- » Nearby highways Route 280, GSP and the NJ Turnpike

### Asking Price

- » Upon Request
- » \$10.50 PSF NNN



## Trade Area Tenants



## | Floor Plan

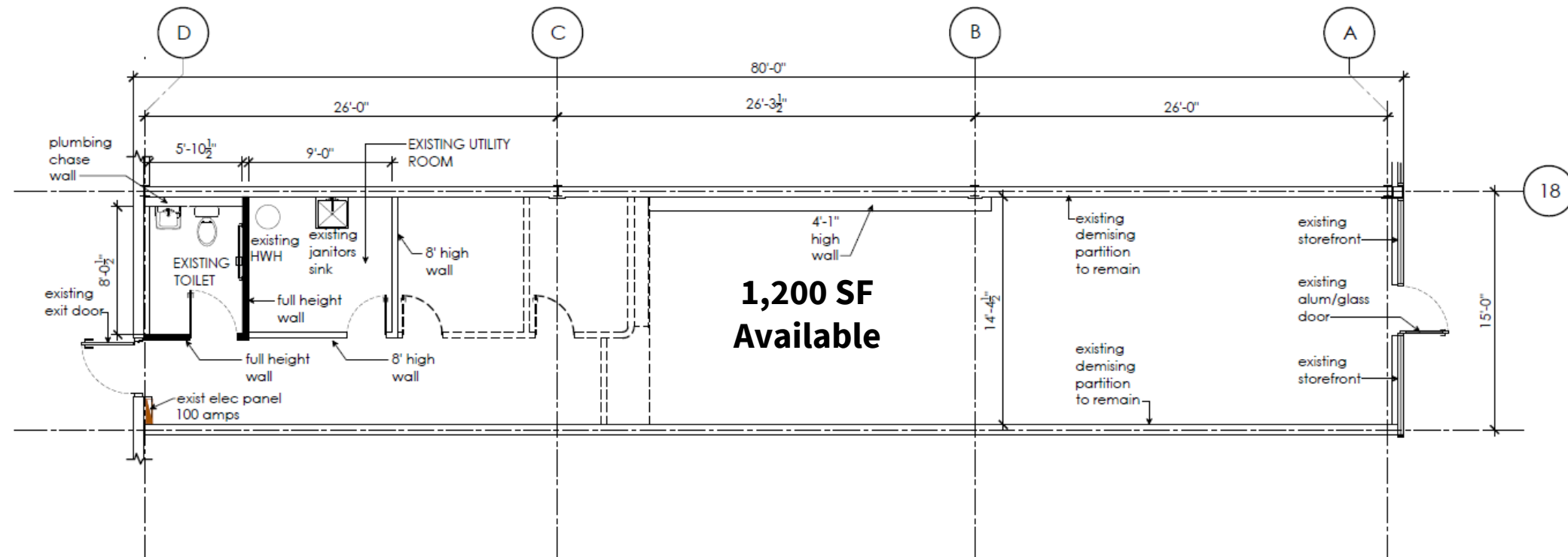

1 FLOOR PLAN (FORMER PLAZA NAIL)  
1/8" = 1'-0"



# Site Plan



[illegible]

» Visibility from I-280 (80,434 cars per day)



# Market **Aerial**



For more information contact:

David Townes  
Managing Director  
+1 917 993 5515  
[david.townes@jll.com](mailto:david.townes@jll.com)

Alana Friedman  
Vice President  
+1 201 741 0990  
[alana.friedman@jll.com](mailto:alana.friedman@jll.com)

## Demographics



**296,478**  
Population



**\$47,963**  
Med. HH Income



**168,714**  
Employees



**11,046**  
Businesses

Demographics taken within 3 miles Source: ESRI, 2022