



For sublease

**10,125 SF available through  
October 2026**

### Specifications

#### Unit 1

- 4,500 SF office/restrooms, ± 5,625 SF warehouse
- Two gas heaters
- Two 8' W x 8' H dock with levelers
- One 12' W x 14' H drive-in
- 21' clear height
- LED lighting

**421 Fehleley Drive  
King of Prussia | NJ**

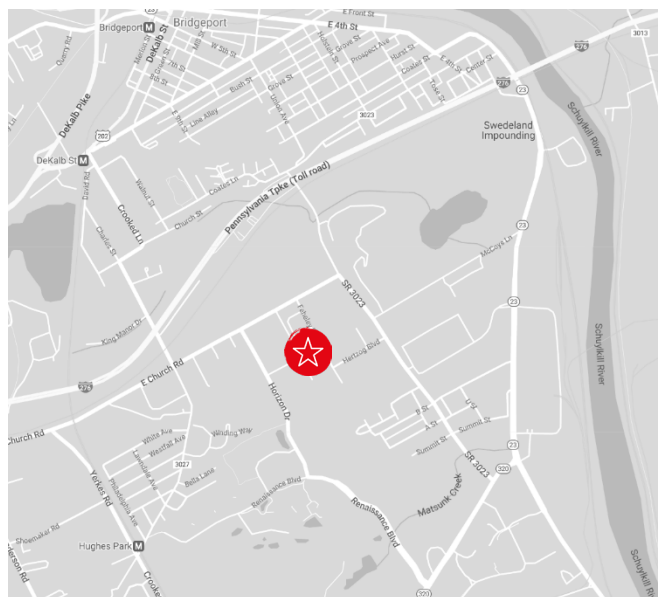



## 10,125 SF available for sublease

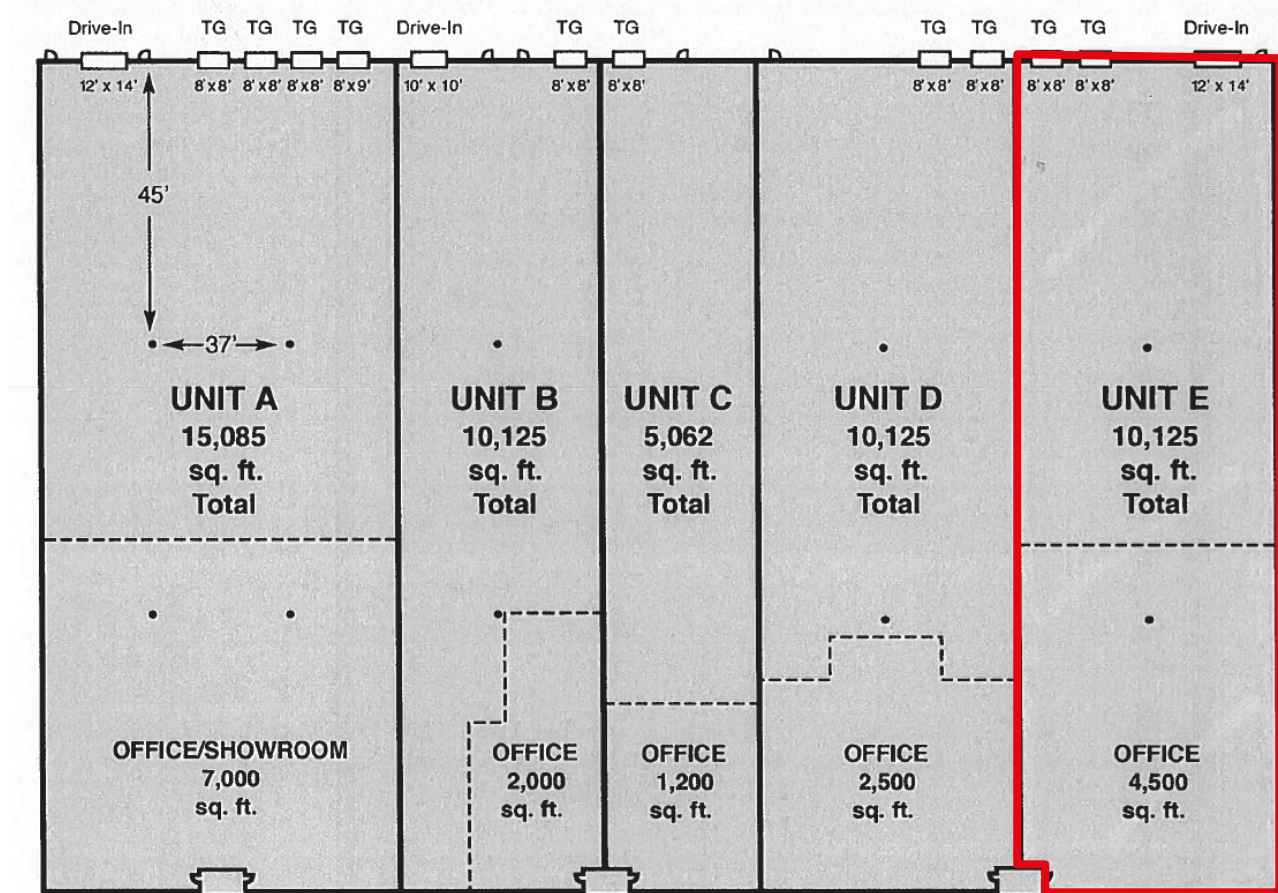

### Office



### Warehouse



Tyler Vandergrift  
+1 215 399 1828  
[tyler.vandergrift@jll.com](mailto:tyler.vandergrift@jll.com)

Austin Weitz  
+1 609 221 5848  
[austin.weitz@jll.com](mailto:austin.weitz@jll.com)