



For lease

3100 Copper Avenue, Fenton, MI

60,000 SF Available November 1, 2025

Building Information

Property Highlights

- 60,000 SF
- Available November 1, 2025
- Expansion opportunity to 120,000 SF
- Crane building (6)
- Ability to add (4) truckwells
- \$7.95 PSF NNN

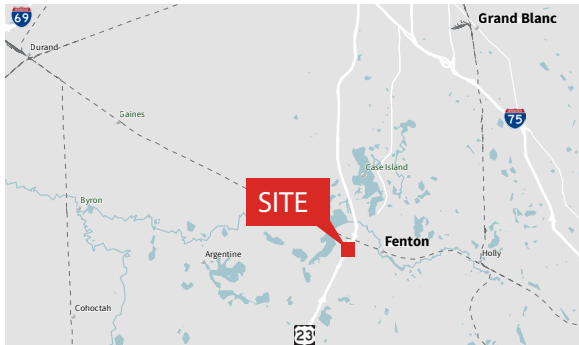

| | |
|-------------------------|--------------------------|
| Classification | Manufacturing /Warehouse |
| Office SF | 5,000 SF |
| Tax ID No. | 53-35-200-010 |
| Freeway Distance | .3 miles (US 23) |
| Railsiding | No |
| Parking | 100 Free surface |
| Zoning | I-1 |
| County | Genesee |
| Rental Rate | \$7.95 PSF NNN |
| Taxes | \$2.05 SF |

| | |
|---------------------|---------------------------------|
| Total SF | 60,000 SF; 120,000 SF expansion |
| Acreage | 10.97 |
| Year Built | 1997 |
| Clear Height | 30' |
| Power | 2,000 amp / 480 volt |
| Cranes | (2) 10-ton; (4) 20-ton |
| Lights | LED |
| Grade Door | (4) 18' W x 14' H |
| Floor | 12" |
| Sprinklers | Yes |

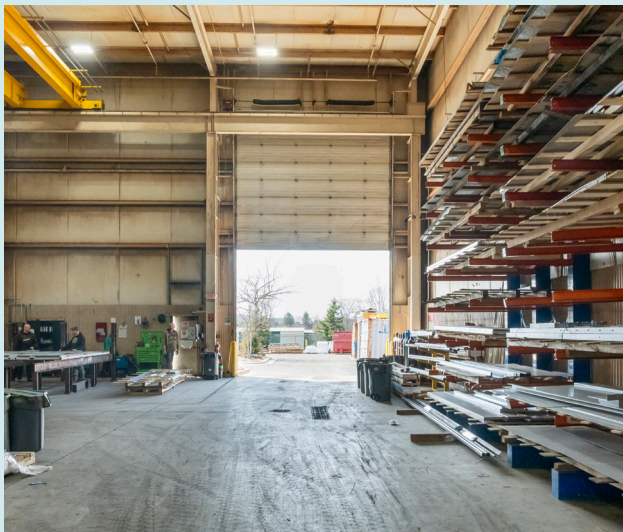

Site Plan

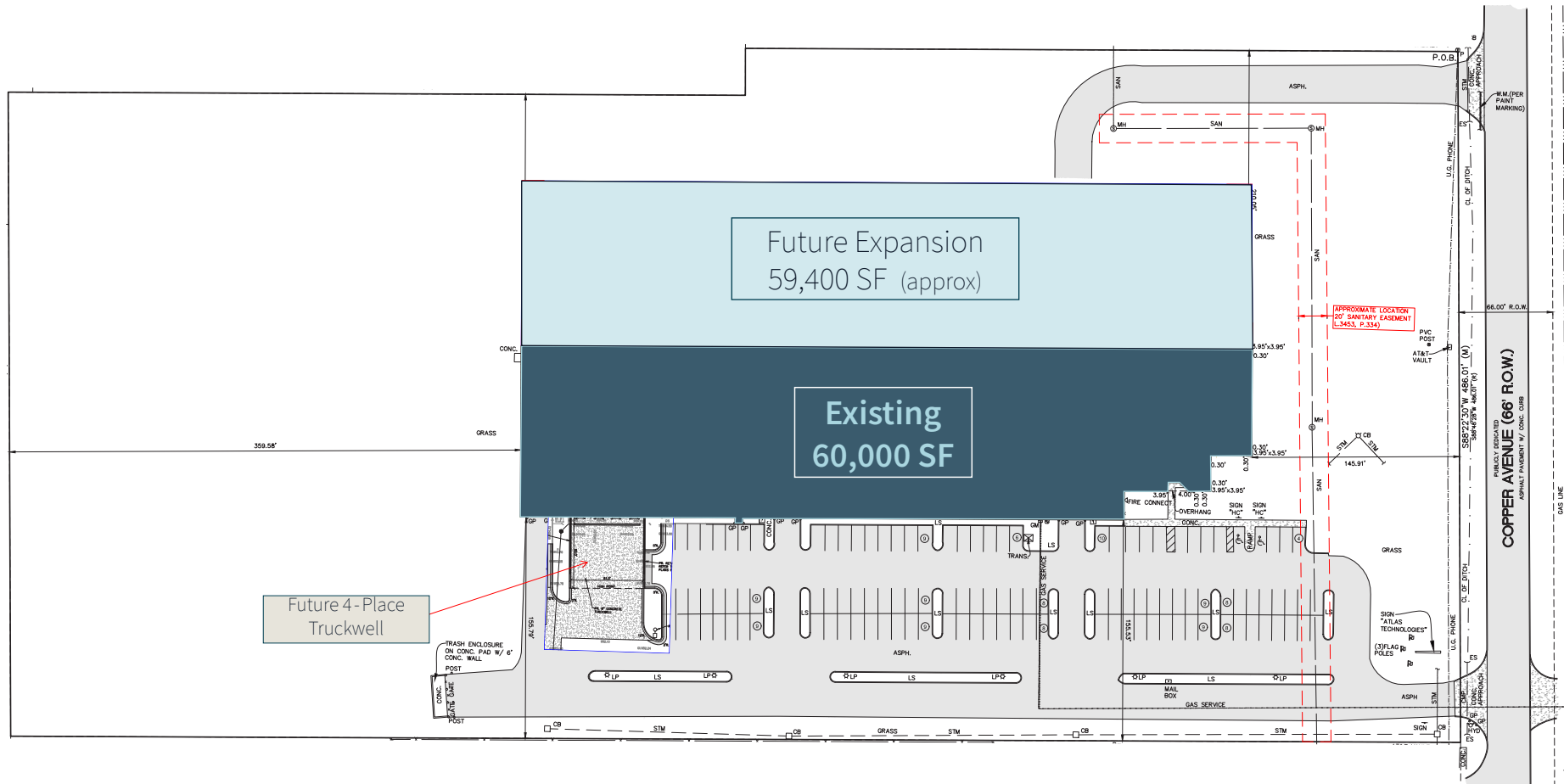

JLL

Ben Schrode

Managing Director

ben.schrode@jll.com

+1 248 581 3325

Jake Slaker

Associate

jake.slaker@jll.com

+1 248 581 3245

Although information has been obtained from sources deemed reliable, neither Owner nor JLL makes any guarantees, warranties or representations, express or implied, as to the completeness or accuracy as to the information contained herein. Any projections, opinions, assumptions or estimates used are for example only. There may be differences between projected and actual results, and those differences may be material. The Property may be withdrawn without notice. Neither Owner nor JLL accepts any liability for any loss or damage suffered by any party resulting from reliance on this information. If the recipient of this information has signed a confidentiality agreement regarding this matter, this information is subject to the terms of that agreement. © 2025 Jones Lang LaSalle IP, Inc. All rights reserved

