



**READY FOR OCCUPANCY**

6701

Jones Lang LaSalle Americas, Inc. License #: CO508577000

**±215,419 SF (divisible)**

6701 North Logistics Way  
Glendale, Arizona

**303**   
LOGISTICS  
PHASE TWO



W.M. GRACE COMPANIES  
SINCE 1966



# PROPERTY FEATURES

- 377,028 SF cross dock building on a 26.2 acre site
- 215,419 SF (divisible)
- 490' x 424' space dimensions
- 36' clear height
- 52' x 50' column spacing with 70' speed bays
- 190' concrete truck courts
- 44 dock high doors
- 2 14' x 14' grade level doors
- 55 trailer parking spaces (expandable)
- 148 auto parking spaces
- ESFR sprinkler system
- Fully gated / secure truck court
- Clerestory windows
- Panelized roof system with R-30 batt insulation
- White scrim under roof deck
- Power (APS): 800 amps; 277/480v, 3 phase existing. Additional 3,000 amps available if needed (switch gear and distribution panels already procured)
- Water/Sewer: EPCOR

## MAKE READY IMPROVEMENTS

- ✓ ± 4,000 SF spec office (in progress)
- ✓ R-11 wall insulation system at 10' to roof deck
- ✓ (10) 40k lb capacity pit levelers with locks and lights
- ✓ LED warehouse lighting at 30 foot candles on 15' whips with motion sensors
- ✓ Full warehouse HVAC system

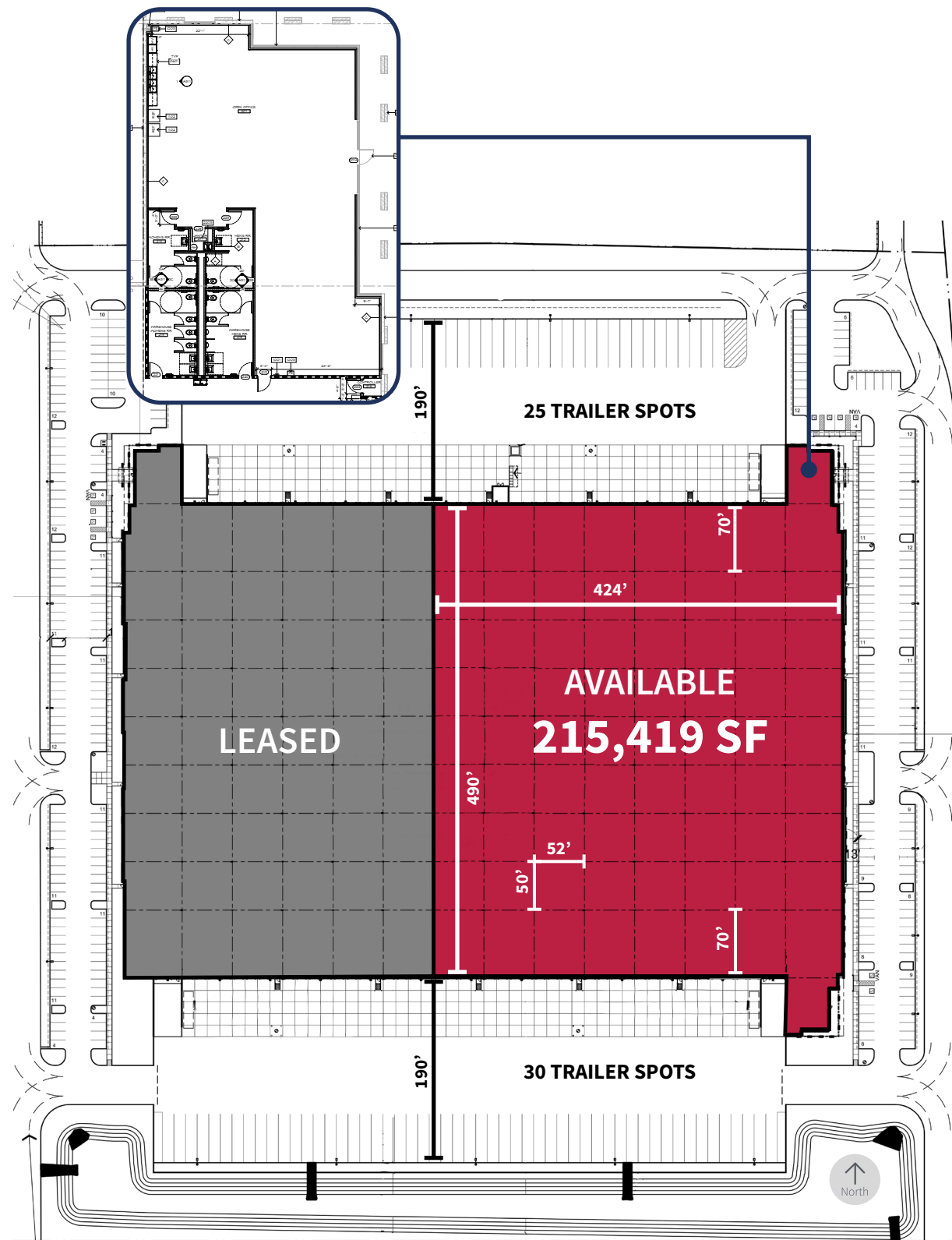



# PROJECT OVERVIEW

- 4 building Industrial park
- 1.3 million square feet total
- On-site retail amenities
- Phase I - leased
- Phase II - delivered
- Phase III - planned
- Loop 303 frontage
- Approximately 5 miles from I-10

## AREA DEMOGRAPHICS

### 30 minute drive time

Population:	<b>1,347,515</b>
Households:	<b>450,421</b>
Families:	<b>326,314</b>
Average Size:	<b>3.45</b>
Median Age:	<b>34.4</b>
Median Household Income:	<b>\$60,194</b>
Average Household Income:	<b>\$78,669</b>

### Education



College-Educated:	<b>31.6%</b>
Associate Degree:	<b>9.0%</b>
Bachelor Degree:	<b>14.7%</b>
Graduate Degree:	<b>7.9%</b>

### Trends, 5 year projected growth

Population:	<b>8.1%</b>
Households:	<b>7.8%</b>
Families:	<b>7.8%</b>
Median Household Income:	<b>9.6%</b>

### Workforce



<b>12.8%</b>	Management, business, science and arts occupations
<b>10.6%</b>	Sales and office occupations
<b>18.6%</b>	Service occupations
<b>13.1%</b>	Production, transportation & material moving occupations

### Foreign trade zone (capable)

- **72%** reduction in real property tax
- **72%** reduction in personal property (equipment) tax
- Duty Deferral
- Duty Elimination
- Reduced customs reporting entries

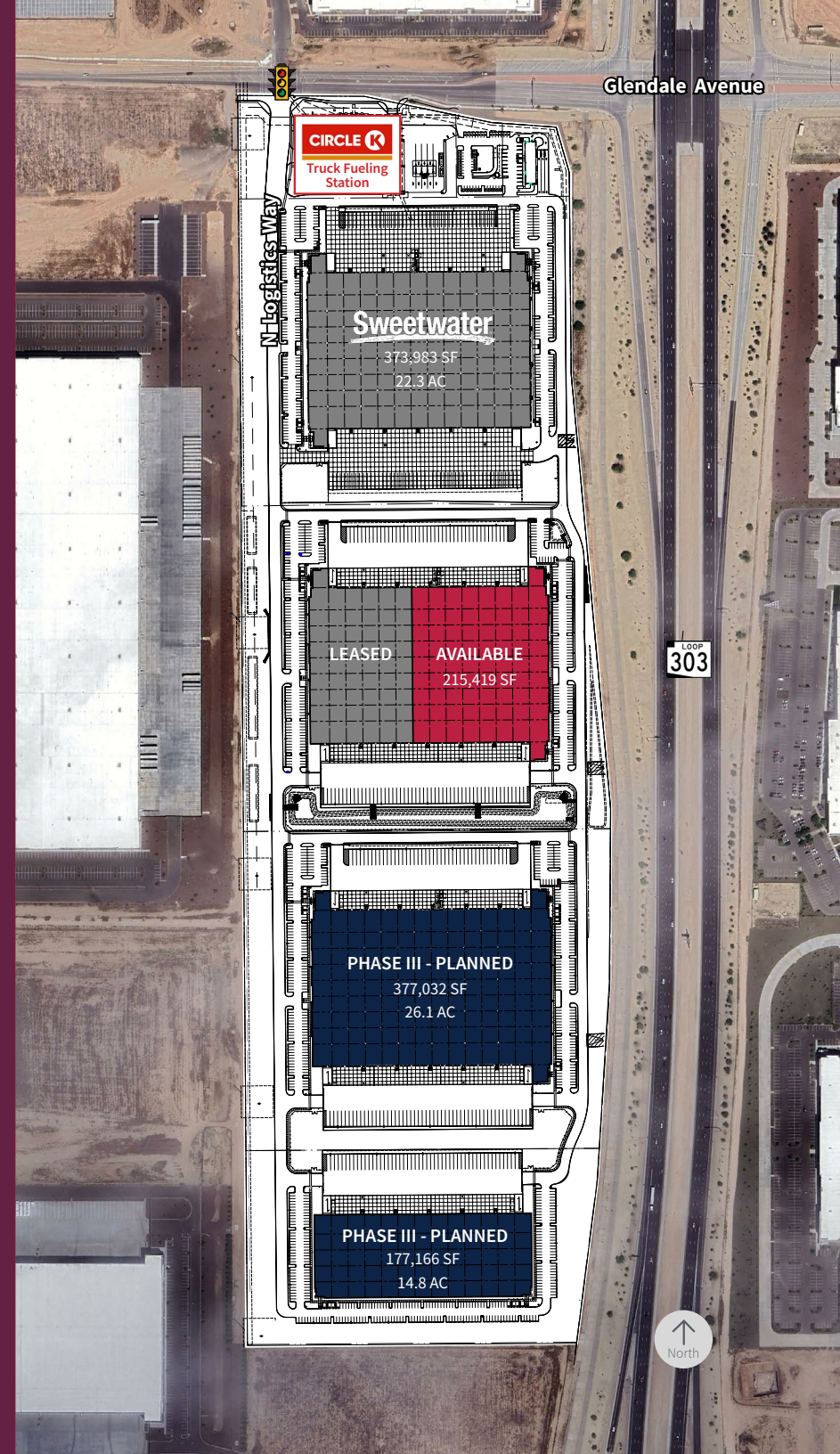





# 303

## LOGISTICS PHASE TWO

6701 North Logistics Way  
Glendale, Arizona

### The West Valley, Arizona

- **1.6 million** people live in the West Valley
- **\$62,775** is the average annual income for households in the West Valley
- **62%** of the West Valley population is workforce age
- **69%** of the West Valley workforce commutes outside of the region to work in other parts of Maricopa County
- **28%** of the manufacturing workers in Maricopa County live in the West Valley, yet only 16% of the jobs are located here
- **Top Employers include:** Banner Health, Luke Air Force Base, Amazon, PetSmart, Swift, FedEx

**Riley Gilbert, SIOR**  
Senior Managing Director  
+1 602 282 6271  
riley.gilbert@jll.com

**Marc Hertzberg, SIOR**  
Exec. Managing Director  
+1 602 282 6269  
marc.hertzberg@jll.com

**Anthony Lydon, cscmp**  
Exec. Managing Director  
+1 602 282 6268  
aj.lydon@jll.com

**Kelly Royle**  
Vice President  
+1 602 282 6258  
kelly.royle@jll.com



Although information has been obtained from sources deemed reliable, neither Owner nor JLL makes any guarantees, warranties or representations, express or implied, as to the completeness or accuracy as to the information contained herein. Any projections, opinions, assumptions or estimates used are for example only. There may be differences between projected and actual results, and those differences may be material. The Property may be withdrawn without notice. Neither Owner nor JLL accepts any liability for any loss or damage suffered by any party resulting from reliance on this information. If the recipient of this information has signed a confidentiality agreement regarding this matter, this information is subject to the terms of that agreement. © 2024 Jones Lang LaSalle IP, Inc. All rights reserved.