

**1584 Zephyr Ave**  
HAYWARD, CA

**±15,824 SF**  
**Available for Lease**



Patrick J Metzger  
RE Lic. #: 01888895  
+1 510 285 5362  
[patrickj.metzger@jll.com](mailto:patrickj.metzger@jll.com)

Thomas Mensendiek  
RE Lic. #: 02001433  
+1 925 944 2163  
[t.mensendiek@jll.com](mailto:t.mensendiek@jll.com)

Jason Ovadia  
CA Lic. #: 01742912  
+1 510 285 5360  
[jason.ovadia@jll.com](mailto:jason.ovadia@jll.com)



**EASTGROUP**  
PROPERTIES

Jones Lang LaSalle Brokerage, Inc. Real Estate  
License #: 01856260

# 1584 Zephyr Avenue

HAYWARD, CA

±15,824 SF Available

## Premises features

±15,824 SF total

±1,000 SF Office space

Adjacent unit ±47,520 SF Available for a total of ±63,344 SF

Two (2) Dock-high doors

Two (2) Grade-level door

Skylights throughout, LED warehouse lighting

±20' - ±22' minimum Clear Height

Fully sprinklered

±1 mile to I-880 via Whipple Rd

Minimum ±200 Amps @ 208 Volt 3 phase power  
(subject to confirmation)

±24' - ±60' Column Spacing

New interior and exterior paint

Available Now

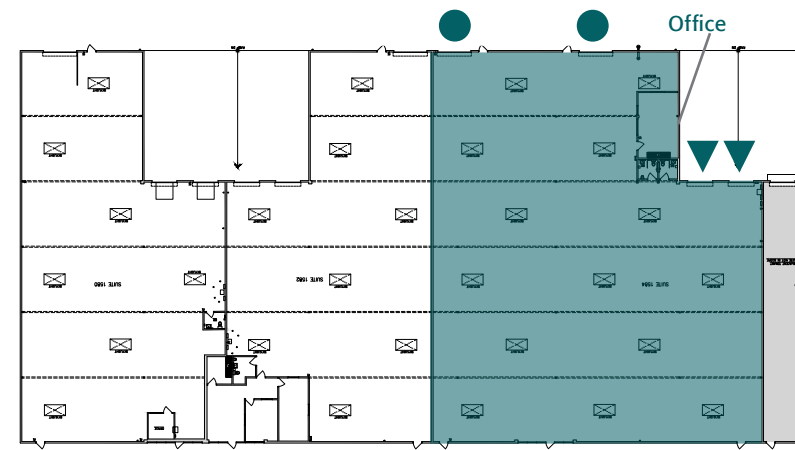

▲ Dock High Doors  
● Grade Level Doors



# 1584 Zephyr Ave

HAYWARD, CA

±15,824 SF  
Available for Lease

## Corporate Neighbors



- |                            |                            |                               |                         |
|----------------------------|----------------------------|-------------------------------|-------------------------|
| 1. Forward Air, Inc        | 8. Kuehne   Nagel          | 15. Samuel                    | 22. Autowise            |
| 2. Xcapade                 | 9. Tesla                   | 16. J.B. Hunt                 | 23. RW Garage Doors     |
| 3. Gallo Sales Company     | 10. Renewal by Andersen    | 17. Move-Pros                 | 24. Rich's              |
| 4. Allure Labs             | 11. MDC Precision          | 18. Yaneng                    | 25. Hayward Training    |
| 5. NorCal Moving & Storage | 12. Chalk                  | 19. Armenino                  | 26. Kwan Wo Ironworks   |
| 6. Semano                  | 13. Johnson Computer, Inc. | 20. Standard Event Rentals    | 27. IMT Precision, Inc. |
| 7. Keeco                   | 14. Plant Terra            | 21. American Licorice Company |                         |



# 1584 Zephyr Ave

HAYWARD, CA

±15,824 SF  
Available for Lease

## Demographics

| Access to consumers                                     | 15 minutes | 30 minutes | 45 minutes  |
|---|------------|------------|-------------|
| Total Population  | 397,930    | 1,983,498  | 5,000,685   |
| Total Households  | 122,523    | 691,141    | 1,750,595   |
| Millennial Population<br>(Born 1981 to 1998)            | 105,093    | 528,141    | 1,276,719   |
| Median Home Value                                       | \$868,960  | \$997,480  | \$1,128,694 |
| Ordered any item<br>online in last 6 months             | 235,955    | 1,222,549  | 3,166,671   |
| Spent \$500+ on<br>Internet orders in last<br>12 months | 133,433    | 724,160    | 1,912,579   |
| Median<br>Household Income                              | \$122,221  | \$124,420  | \$135,280   |
| Median<br>Disposable Income                             | \$100,910  | \$101,753  | \$106,283   |
| Household<br>Income 100K+                               | 75,691     | 419,855    | 1,107,560   |
| Manufacturing<br>Employees                              | 15,695     | 56,669     | 125,009     |
| Warehousing &<br>Distribution Employees                 | 15,375     | 60,121     | 131,030     |

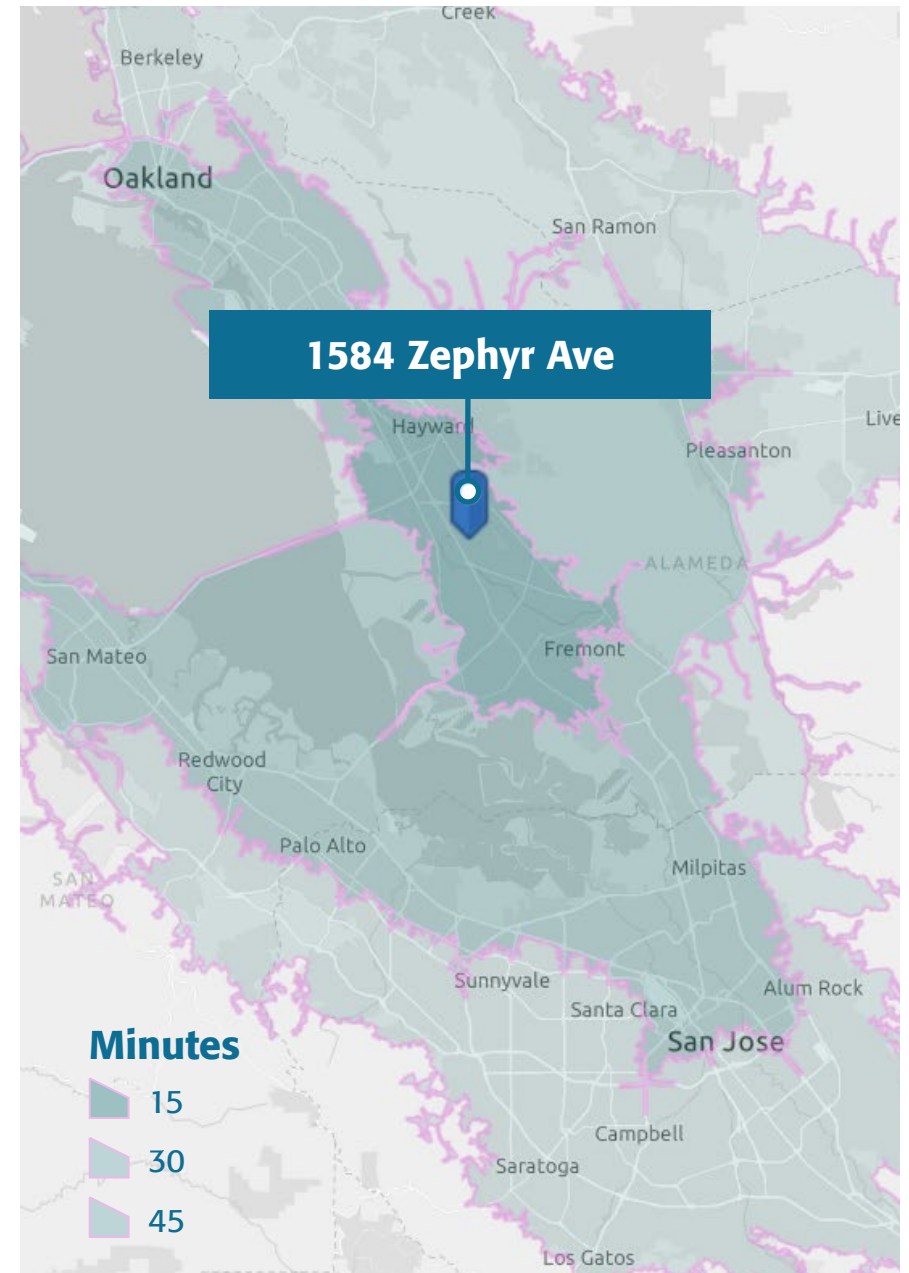



# 1584 Zephyr Ave

HAYWARD, CA

±15,82 SF  
Available for Lease

## Strategic location

### Port

|                      |                   |
|----------------------|-------------------|
| Port of Redwood City | <b>17.6 miles</b> |
| Port of Oakland      | <b>19.2 miles</b> |

### Airport

|                           |                   |
|---------------------------|-------------------|
| Oakland Airport           | <b>13.5 miles</b> |
| SFO International Airport | <b>24.5 miles</b> |
| San Jose Airport          | <b>21.5 miles</b> |

### BART

|                      |                  |
|----------------------|------------------|
| Hayward BART Station | <b>6.7 miles</b> |
|----------------------|------------------|

### Contact

Patrick J Metzger  
RE Lic. #: 01888895  
+1 510 285 5362  
[patrickj.metzger@jll.com](mailto:patrickj.metzger@jll.com)

Thomas Mensendiek  
RE Lic. #: 02001433  
+1 925 944 2163  
[t.mensendiek@jll.com](mailto:t.mensendiek@jll.com)

Jason Ovadia  
CA Lic. #: 01742912  
+1 510 285 5360  
[jason.ovadia@jll.com](mailto:jason.ovadia@jll.com)

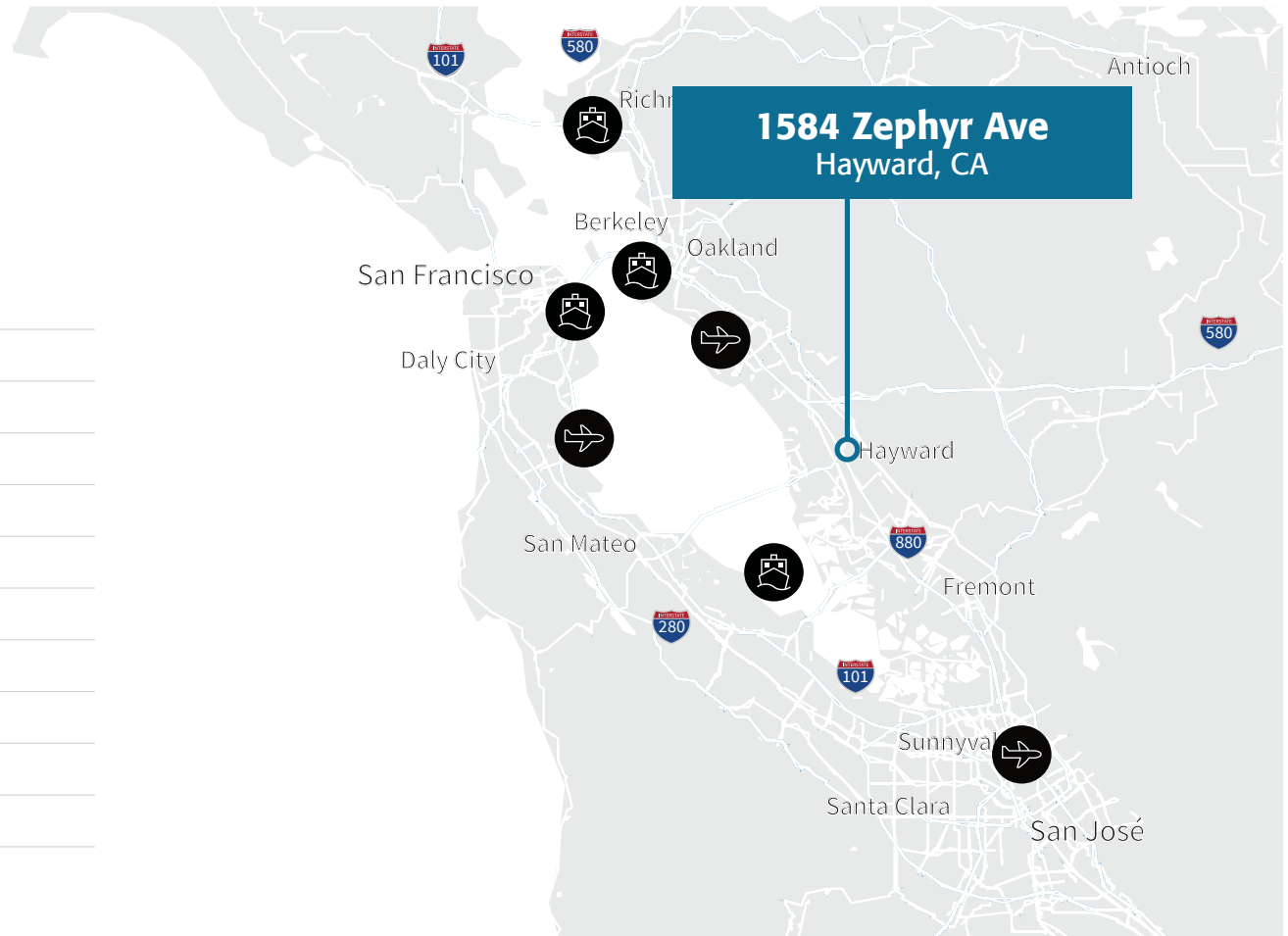

Although information has been obtained from sources deemed reliable, neither Owner nor JLL makes any guarantees, warranties or representations, express or implied, as to the completeness or accuracy as to the information contained herein. Any projections, opinions, assumptions or estimates used are for example only. There may be differences between projected and actual results, and those differences may be material. The Property may be withdrawn without notice. Neither Owner nor JLL accepts any liability for any loss or damage suffered by any party resulting from reliance on this information. If the recipient of this information has signed a confidentiality agreement regarding this matter, this information is subject to the terms of that agreement. ©2025. Jones Lang LaSalle Brokerage, Inc. Real Estate Lic# 01856260. All rights reserved.