



Ground Floor Retail/Office for Lease

2000 Ponce de Leon, Coral Gables FL 33134



Property Highlights

- Approximately 2,648 SF, former bank space
- Corner space situated at the base of 2000 Ponce, a boutique Class A office building in the heart of Coral Gables CBD
- Frontage on Ponce de Leon Blvd. with outdoor area
- Directly across the street from Target, Coral Gables Preparatory Academy and YWCA Child Care Center with other nearby tenants such as Bachour, Wells Fargo, Valley Bank, First Horizon Bank, Aromas del Peru, Zucca, Café Once, and many more



3 Miles
Demographics



251,462
Population



\$110,416
Average
Household
Income



44
Median Age



161,354
Daytime
Population



Floor Plan - Suite 100 2,648 SF

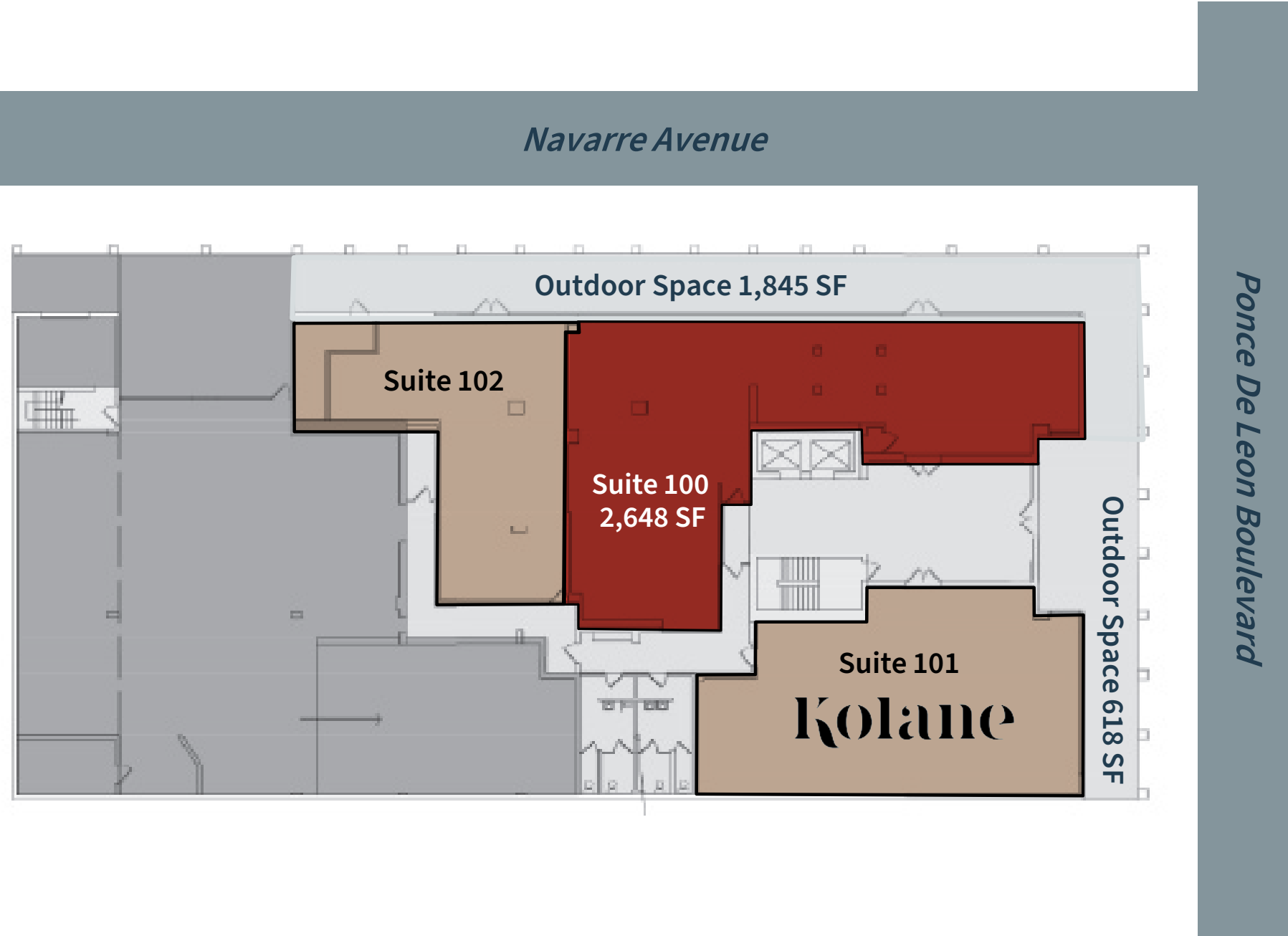

Retail map





Contact:

Zach Winkler
+ 1 305 704 1333
zach.winkler@jll.com

Carter Nash
+ 1 305 704 1328
carter.nash@jll.com

