



For lease

151,660 SF Available

2100 International Parkway, Canton, OH 44720

 **JLL** SEE A BRIGHTER WAY

Property Description

Site Size:	21.6 Acres
Building Size:	274,646 SF
Available Space:	151,660 SF
Office Space:	6,356 SF
Year Built	2000 / 2006
Clear Height	24'
Dock Doors	11 Doors
Drive-In Doors	4 Doors
Auto Parking	263 Spaces
Sprinkler:	Wet System
Power:	480/277v



Site Plan

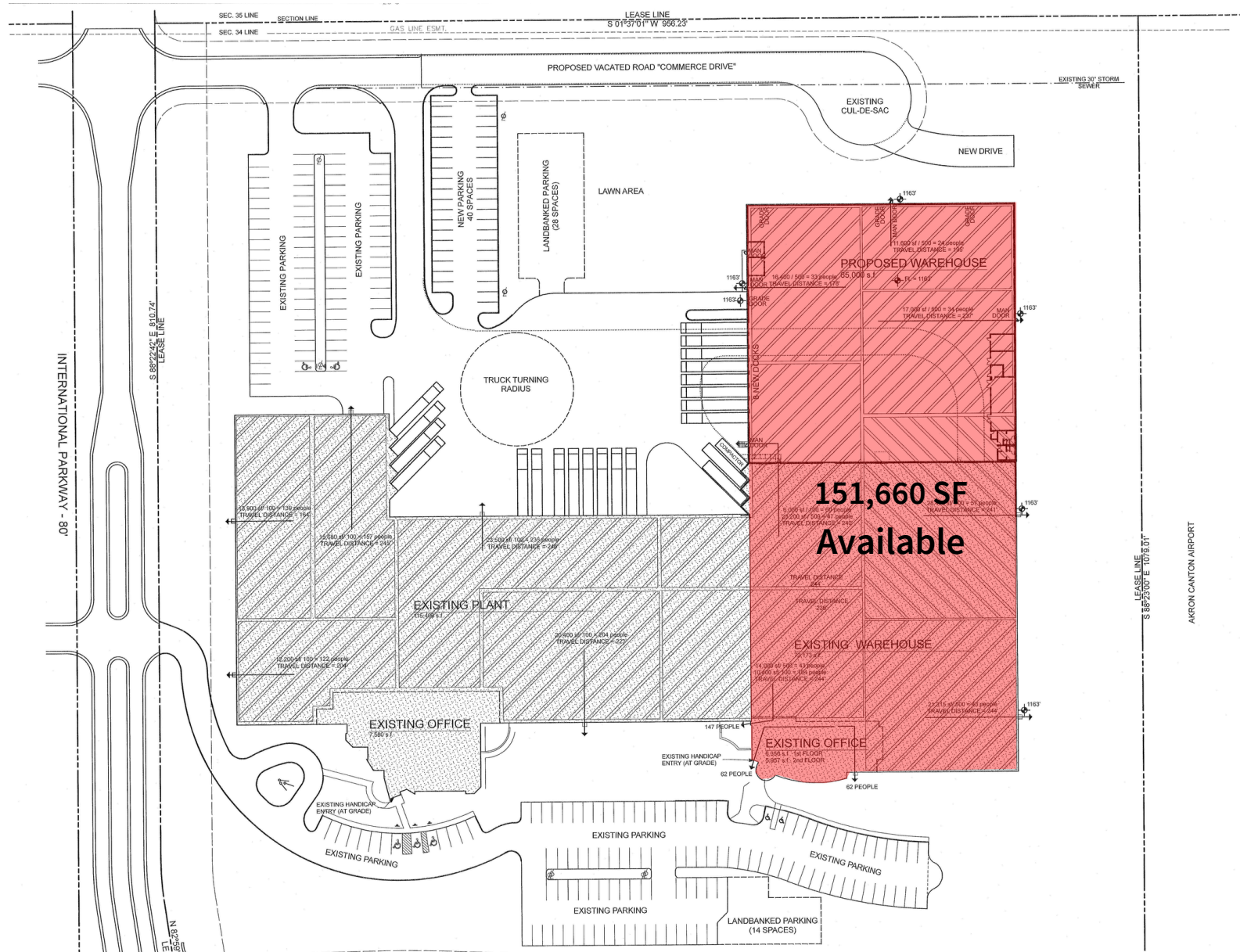

Property Photos



Location Overview

Akron Airport

3.6 miles

I-77

4 miles

Akron

14 miles

Cleveland

50.5 miles

Youngstown

59.3 miles

Columbus

132 miles

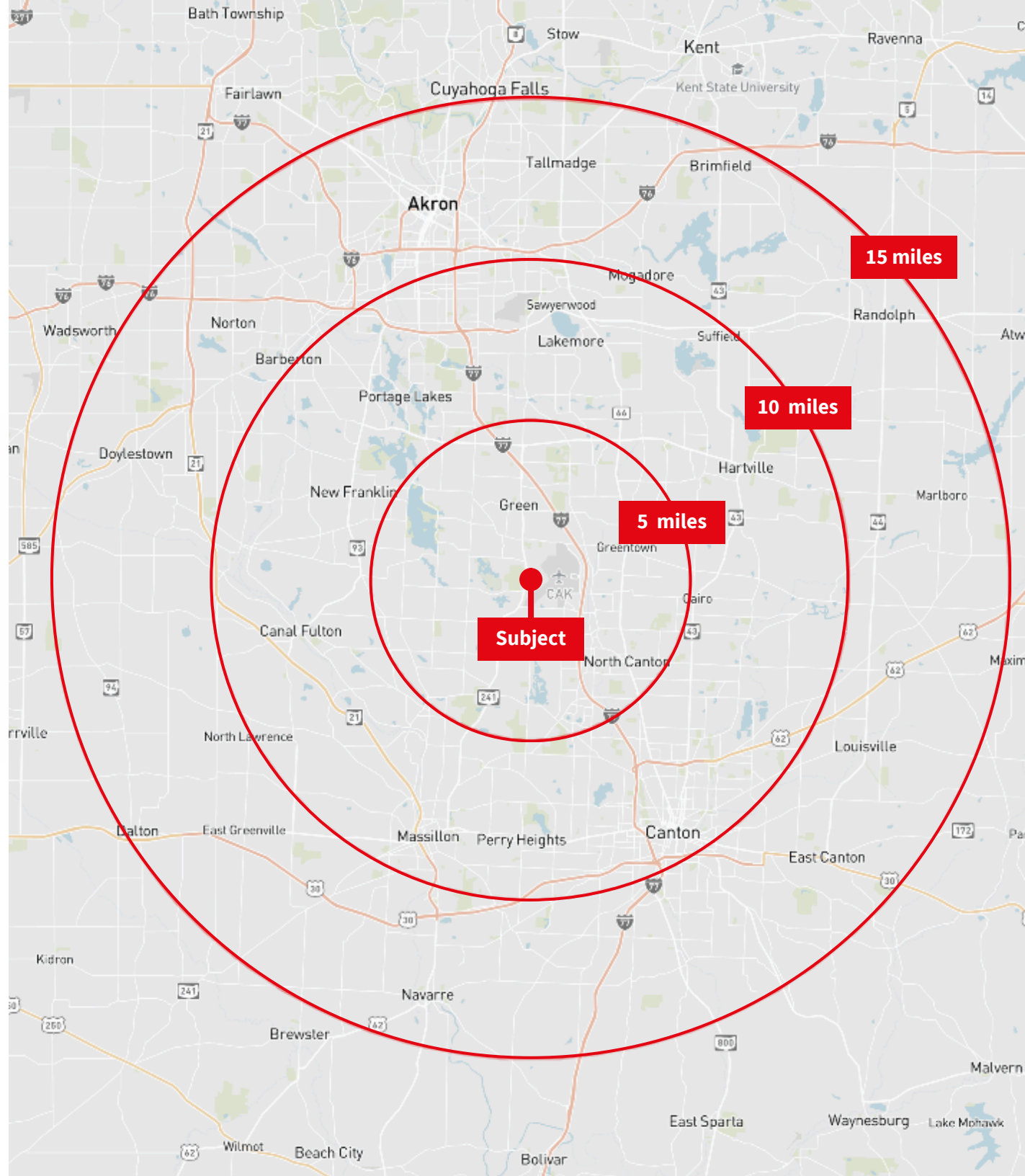

Thank you

For over 200 years, JLL (NYSE: JLL), a leading global commercial real estate and investment management company, has helped clients buy, build, occupy, manage and invest in a variety of commercial, industrial, hotel, residential and retail properties. A Fortune 500® company with annual revenue of \$20.9 billion and operations in over 80 countries around the world, our more than 103,000 employees bring the power of a global platform combined with local expertise. Driven by our purpose to shape the future of real estate for a better world, we help our clients, people and communities SEE A BRIGHTER WAY™. JLL is the brand name, and a registered trademark, of Jones Lang LaSalle Incorporated. For further information, visit jll.com.

JLL

David Stecker

Managing Director

david.stecker@jll.com

+1 (216) 937 1965

Jones Lang LaSalle Americas, Inc.

Although information has been obtained from sources deemed reliable, neither Owner nor JLL makes any guarantees, warranties or representations, express or implied, as to the completeness or accuracy as to the information contained herein. Any projections, opinions, assumptions or estimates used are for example only. There may be differences between projected and actual results, and those differences may be material. The Property may be withdrawn without notice. Neither Owner nor JLL accepts any liability for any loss or damage suffered by any party resulting from reliance on this information. If the recipient of this information has signed a confidentiality agreement regarding this matter, this information is subject to the terms of that agreement. © 2025 Jones Lang LaSalle IP, Inc. All rights reserved.