

# For Lease

**35,954 SF**

**935 Avenue R**

**Grand Prairie, TX 75050**



**JLL**

**Randy Touchstone**

214 236 6676

[randy.touchstone@jll.com](mailto:randy.touchstone@jll.com)

**Caleb McCoy, SIOR**

214 949 2084

[caleb.mccoy@jll.com](mailto:caleb.mccoy@jll.com)

**Bo Puckett**

214 621 1565

[bo.puckett@jll.com](mailto:bo.puckett@jll.com)



## Property Specifications

- Suite SF: 35,954
  - Warehouse SF: 33,201
  - Office SF: 2,753
- End Cap Suite
- 24' Clear Height
- (6) 10' x 10' Dock High Doors  
(5 with Pit Levelers)
- (1) Ramped Door
- Fully Sprinklered (Class IV)
- Ample Parking
- Available 12/1/2025
- Power: 3-Phase 120/240v, 600A  
(Ability to Upgrade)



## Map and Floor Plan

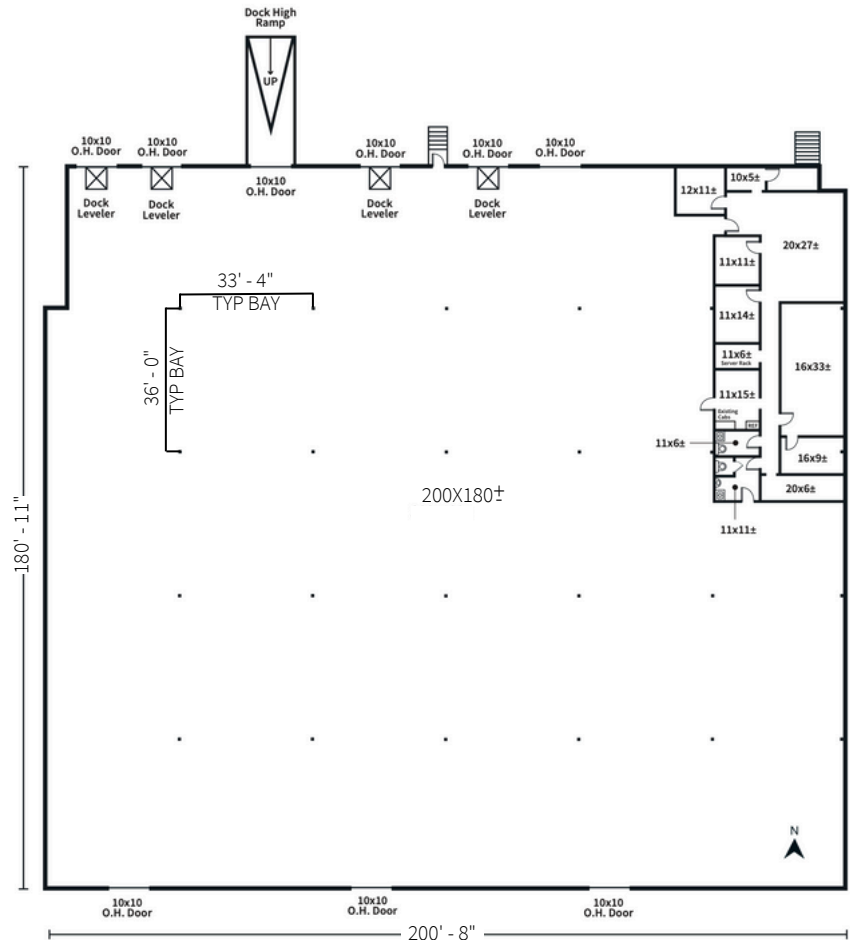
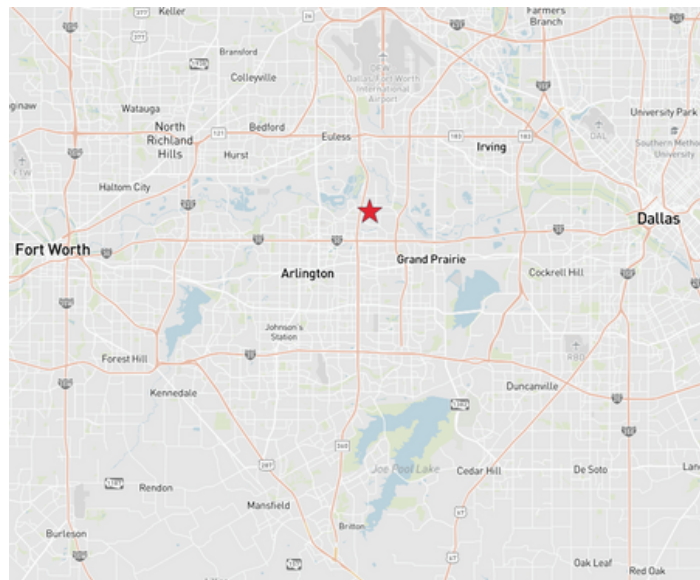

**JLL**

**Randy Touchstone**

214 236 6676

[randy.touchstone@jll.com](mailto:randy.touchstone@jll.com)

**Caleb McCoy, SIOR**

214 949 2084

[caleb.mccoy@jll.com](mailto:caleb.mccoy@jll.com)

**Bo Puckett**

214 621 1565

[bo.puckett@jll.com](mailto:bo.puckett@jll.com)