



# 153 TOWNSEND

**Brand New Creative Spec Suite**

**Full Floor - 35,578 RSF - With Expansion Opportunity  
Available Now**

 **5<sup>th</sup> Floor - Virtual Tour**

**FOR MORE INFORMATION, PLEASE CONTACT:**

**Ann Montilla**  
415 395 7285  
ann.montilla@jll.com  
RE License #: 01889254

**Carlye Parker**  
415 228 3130  
carlye.parker@jll.com  
RE License #: 02089807





# 153 TOWNSEND

SIZE:	5th Floor: 35,578 RSF <i>*Expansion opportunity with 6th, 7th, 8th, &amp; 9th Floors: 128,570 RSF</i>
AVAILABILITY:	Immediately
TERM:	Through February 28th, 2030
RATE:	Please Inquire



## Building Highlights

- Class A office property in San Francisco's hottest submarket
- Perfect for creative users
- Raised floor HVAC system
- Concrete construction with open ceilings
- Touchless technology features
- On-site parking
- Showers, lockers, and bike room
- Directly across from Oracle Park
- Immediate access to Muni
- 2 Blocks from Caltrain and highway access

# 153 TOWNSEND - 5th FLOOR



### FOR MORE INFORMATION, PLEASE CONTACT:

**Ann Montilla**  
415 395 7285  
ann.montilla@am.jll.com  
RE License #: 01889254

**Carlye Parker**  
415 228 3130  
Carlye.parker@am.jll.com  
RE License #: 02089807



Jones Lang LaSalle Brokerage, Inc.  
Real Estate License #: 01856260



153 TOWNSEND - 5<sup>th</sup> FLOOR



5<sup>th</sup> FLOOR: HYPOTHETICAL LAYOUT

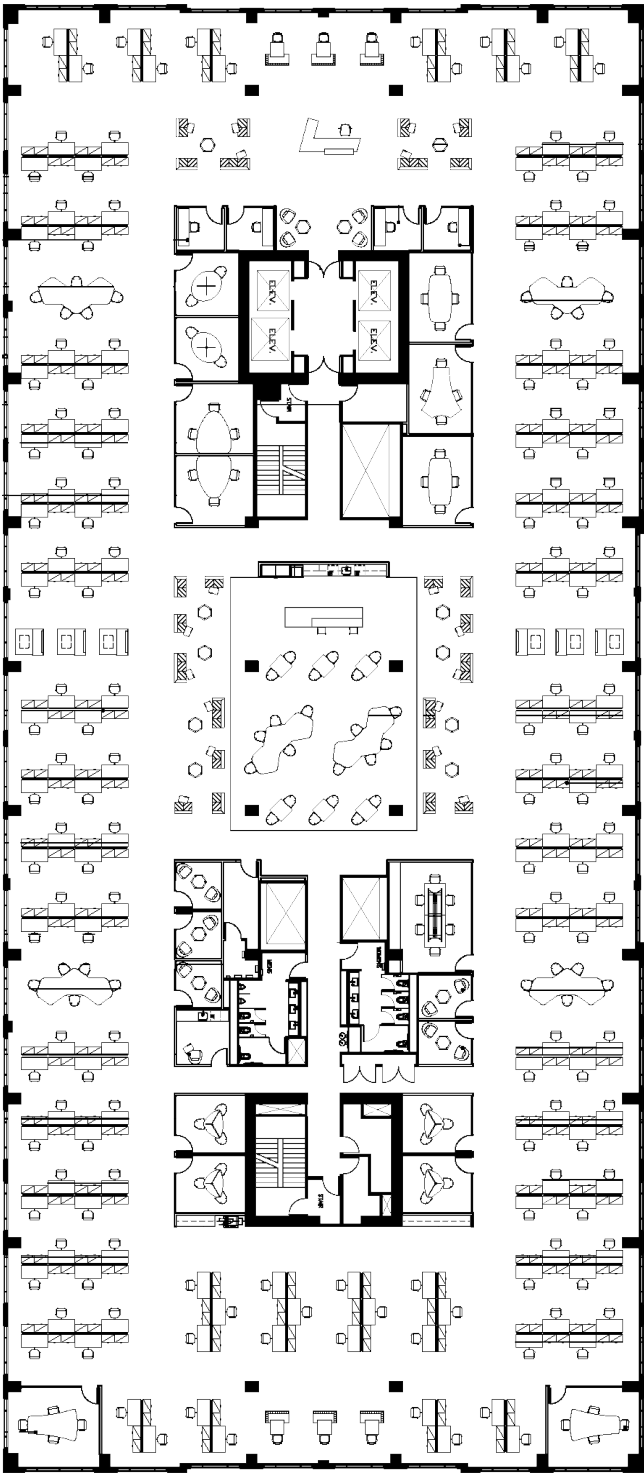

SPACE HIGHLIGHTS

- **Workstations** 152
- **Meeting Space**
  - Conference (4-6) 6
  - Conference (8-10) 0
  - Huddle 11
  - Phone 4
- **Ancillary Space**
  - Reception 1
  - Break Area 1
  - IDF 1
  - Storage 1
  - Print/Copy 2
  - Open Collaboration 10
  - Wellness 1

FOR MORE INFORMATION, PLEASE CONTACT:

**Ann Montilla**  
415 395 7285  
ann.montilla@am.jll.com  
RE License #: 01889254

**Carlye Parker**  
415 228 3130  
Carlye.parker@am.jll.com  
RE License #: 02089807

Jones Lang LaSalle Brokerage, Inc. Real Estate License #: 01856260  
©2021 Jones Lang LaSalle IP, Inc. All rights reserved. All information contained herein is from sources deemed reliable; howe





# 153 TOWNSEND

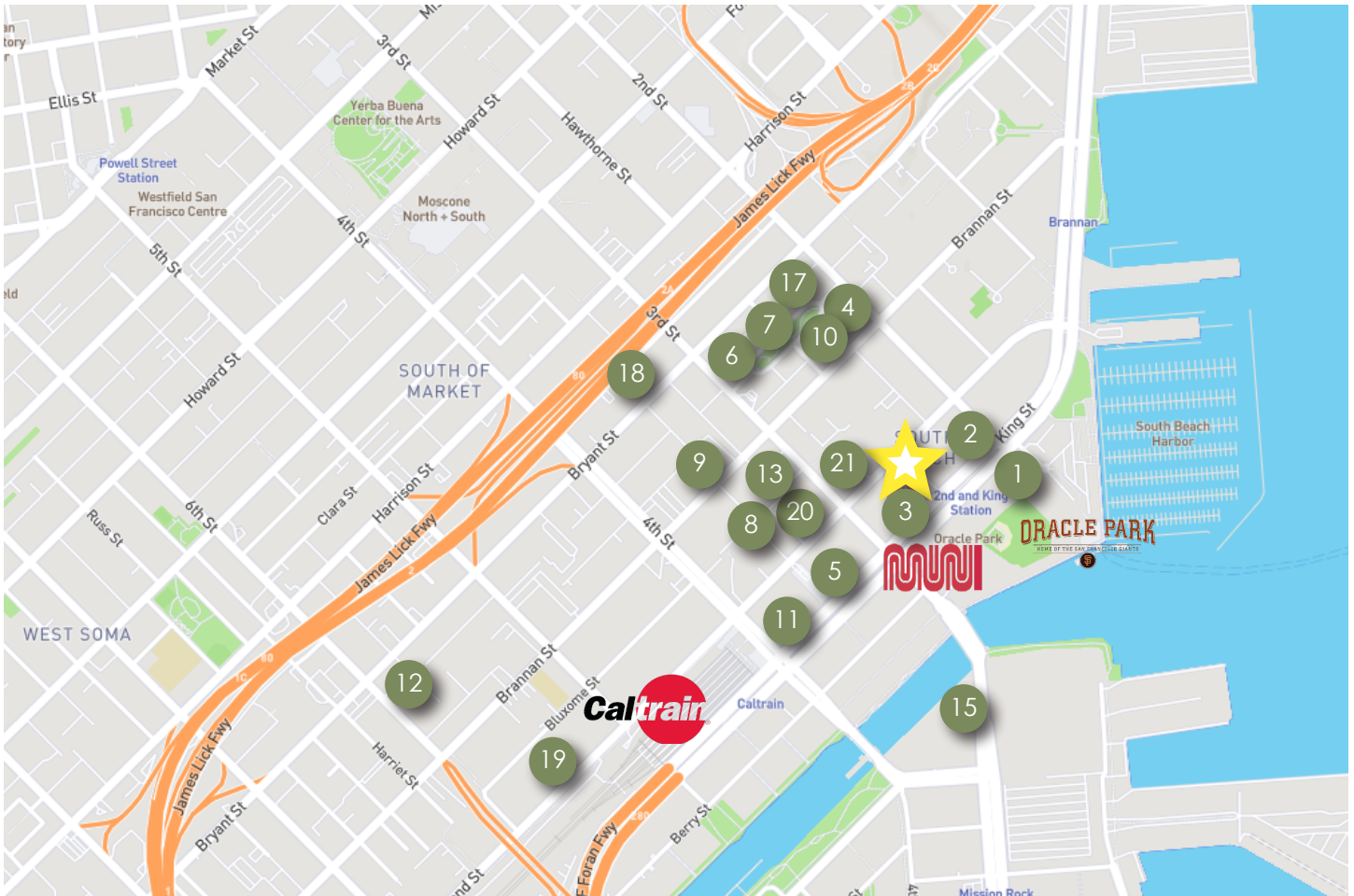

1. ORACLE PARK
  2. MoM's
  3. JENSEN'S
  4. 21ST AMENDMENT BREWERY
  5. UMAMI BURGER
  6. HRD™
  7. CAFFE CENTRO
  8. LUSK
  9. ALEXANDER'S GROUP
  10. Jax.
  11. SAFEWAY
  12. TURTLE TOWER SF
  13. SUN AND MOON
  14. saison
  15. NEW BELGIUM BREWING
  16. TRES
  17. BLUE BOTTLE COFFEE
  18. BLACK HAMMER BREWING
  19. LOCAL BREWING CO.
  20. CAFE OKAWARI
  21. ALCHEMIST
- ★ 153 TOWNSEND

FOR MORE INFORMATION, PLEASE CONTACT:

**Ann Montilla**  
415 395 7285  
ann.montilla@am.jll.com  
RE License #: 01889254

**Carlye Parker**  
415 228 3130  
Carlye.parker@am.jll.com  
RE License #: 02089807

