

# For Sublease

The Dorsey | 252 NW 29th Street | Wynwood

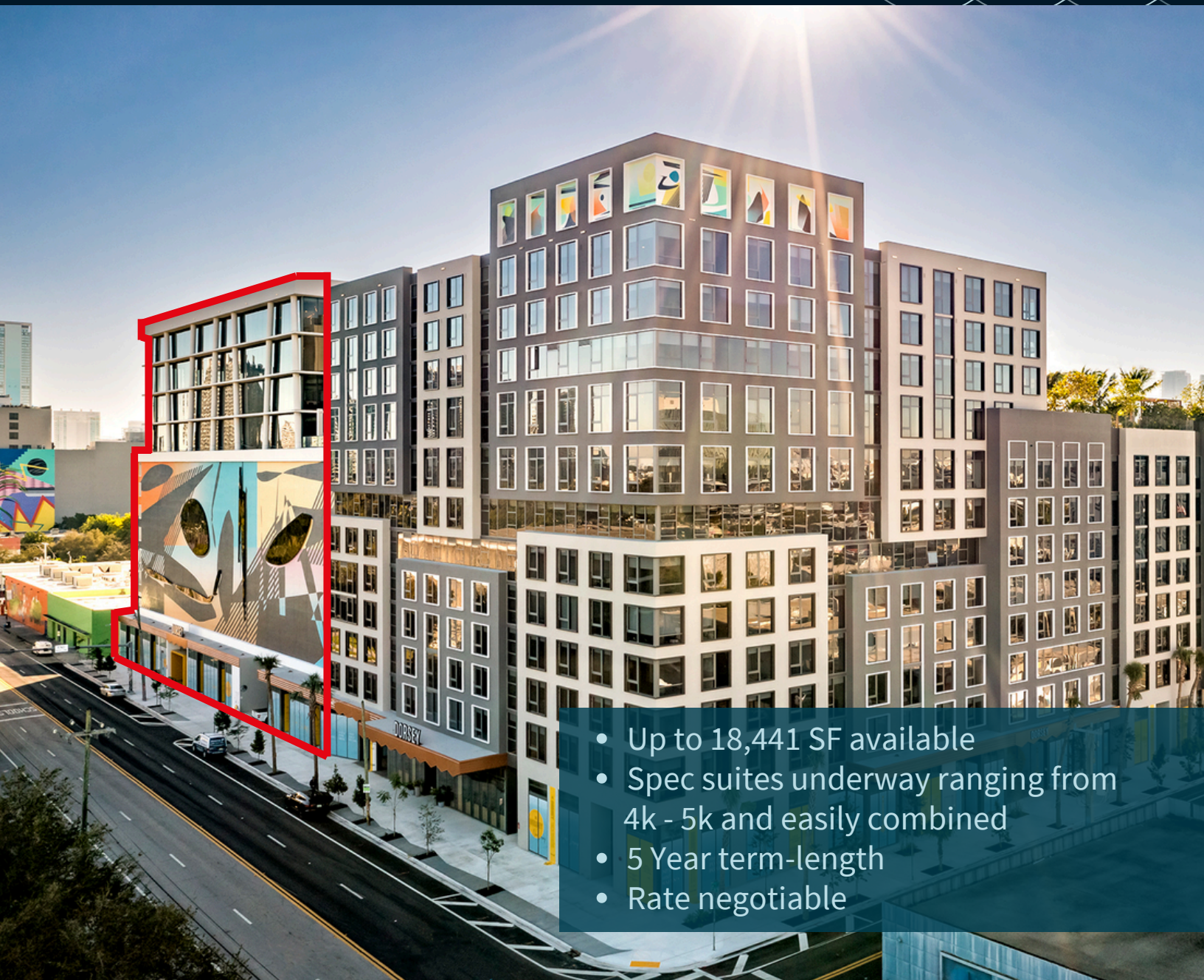

- Up to 18,441 SF available
- Spec suites underway ranging from 4k - 5k and easily combined
- 5 Year term-length
- Rate negotiable

For More Information, Please Contact:

Adam Bernstein  
Executive Vice President  
[Adam.Bernstein@jll.com](mailto:Adam.Bernstein@jll.com)  
+1 954 854 3040

Jessica Reyes  
Associate  
[Jessica.Reyes@jll.com](mailto:Jessica.Reyes@jll.com)  
+1 305 960 8424

# 11th Floor: Up to 18,441 SF



The Dorsey | 252 NW 29th Street | Wynwood

Proposed spec suites (can be combined)

[Click for 3D Virtual tour](#)

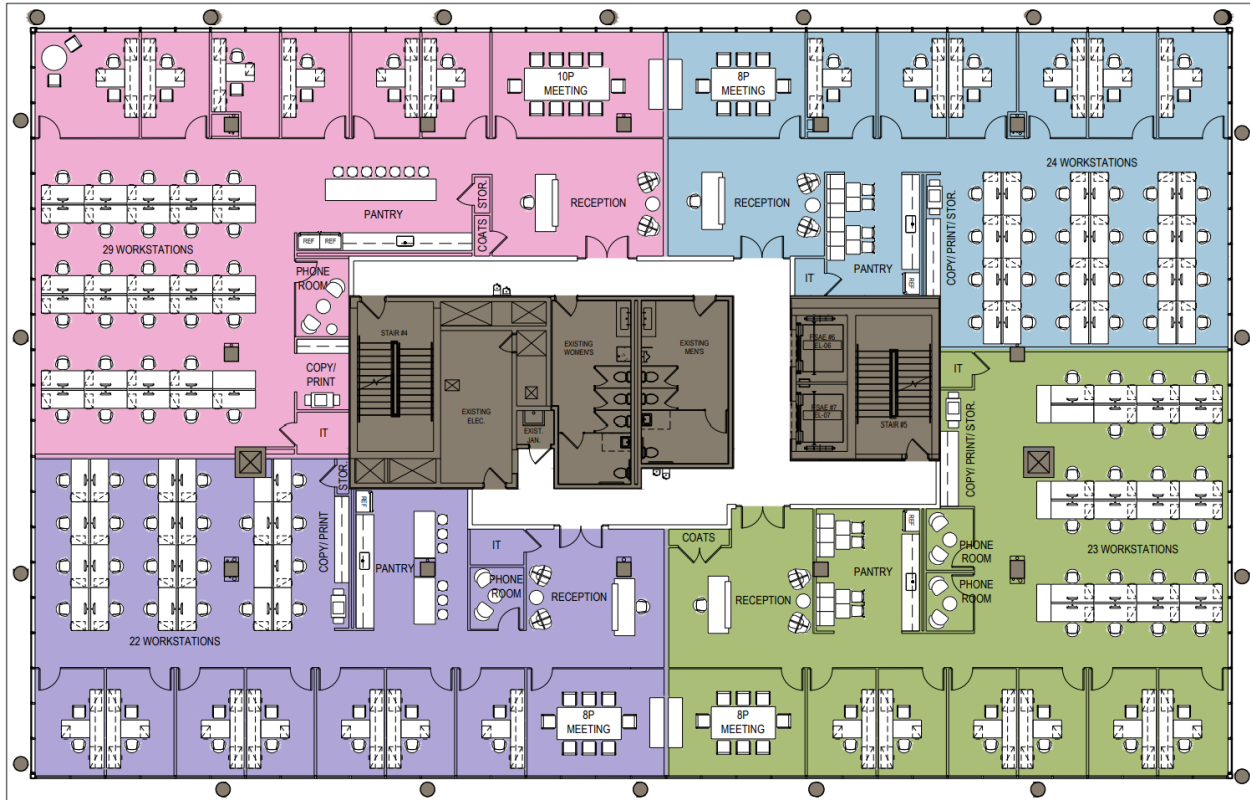

Option A: 5,085 SF    Option B: 3,949 SF    Option C: 4,569 SF    Option D: 5,085 SF



For More Information, Please Contact:

Adam Bernstein  
Executive Vice President  
Adam.Bernstein@jll.com  
+1 954 854 3040

Jessica Reyes  
Associate  
Jessica.Reyes@jll.com  
+1 305 960 8424

# 11th Floor: Up to 18,441 SF



The Dorsey | 252 NW 29th Street | Wynwood

## Sample Finishes

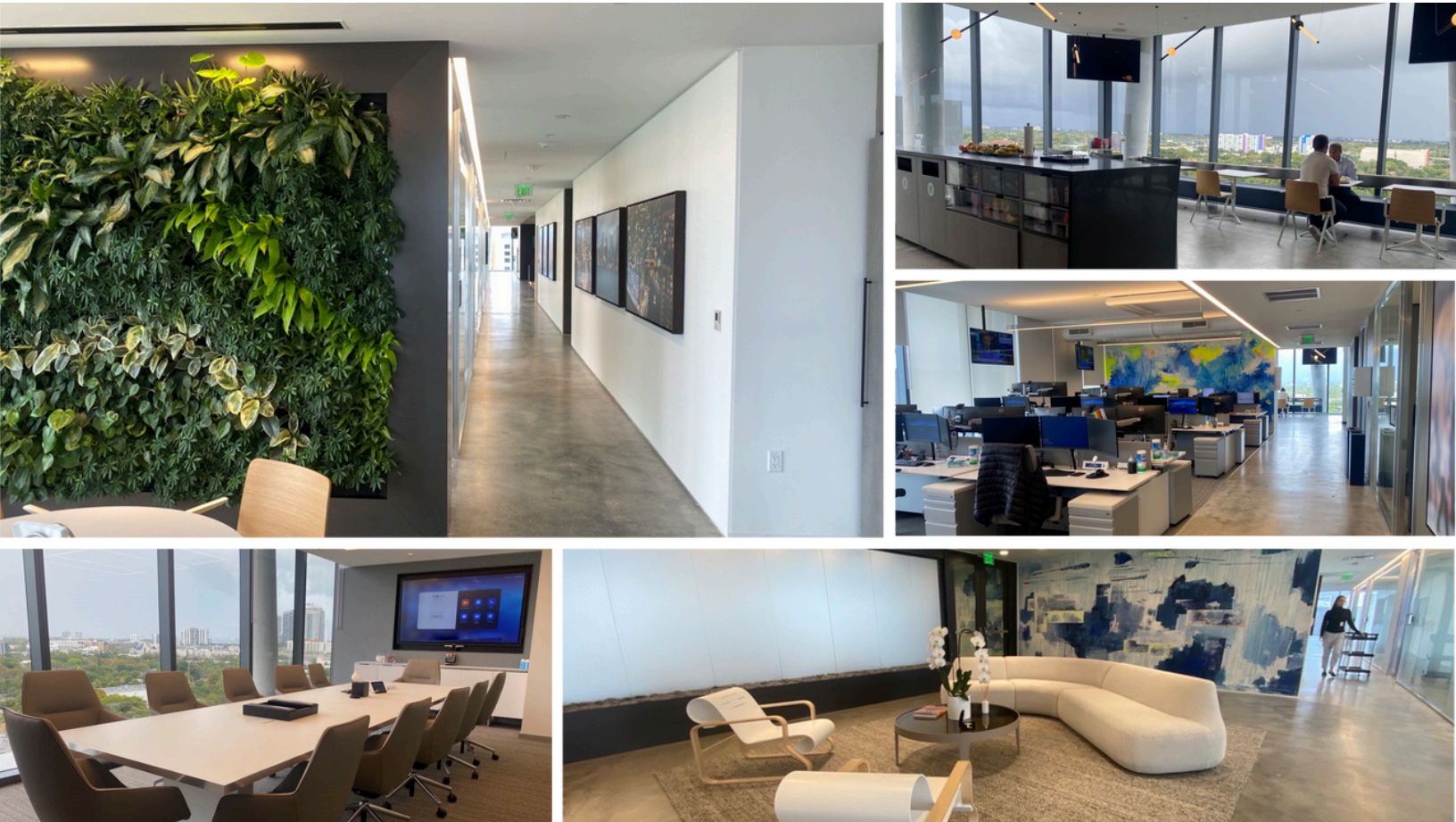

For More Information, Please Contact:

Adam Bernstein  
Executive Vice President  
[Adam.Bernstein@jll.com](mailto:Adam.Bernstein@jll.com)  
+1 954 854 3040

Jessica Reyes  
Associate  
[Jessica.Reyes@jll.com](mailto:Jessica.Reyes@jll.com)  
+1 305 960 8424