

# 12921

S Vista Station Blvd

FOR SUBLEASE | ENTIRE 2ND FLOOR  
36,950 RSF (DEMISABLE TO ~18,500 SF)





# PLUG & PLAY SUBLEASE

## Welcome to 12921 S Vista Station Blvd in Draper.

Offering 36,950 RSF (demisable to ~18,500 SF) for sublease. Part of the Vista Station development, it boasts excellent connectivity with convenient access to the UTA Frontrunner Station, I-15, and Bangerter Highway, providing easy commutes throughout the Salt Lake Valley.



Newly built out  
Class A office space



Available 8/1/25



Rate: \$25.00 per  
RSF full service



LED 8/30/2031



Onsite fitness center



Covered parking



EV chargers



Located on a  
FrontRunner stop







# 2nd Floor

36,950 RSF | Full Floor Available

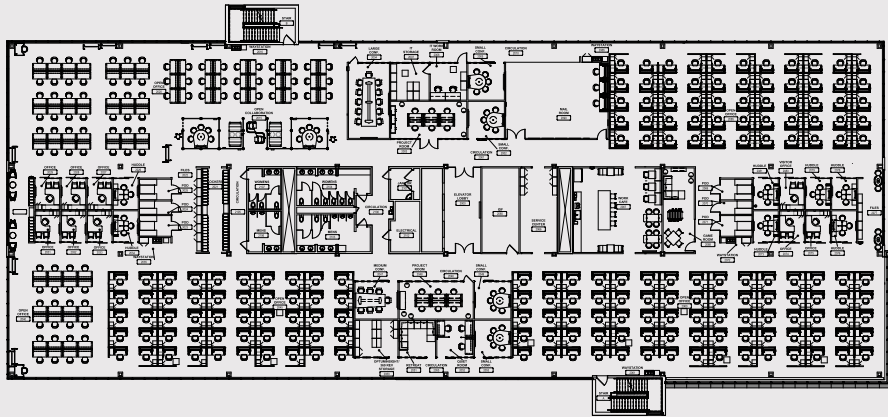

Demisable Option | ~18,500 RSF

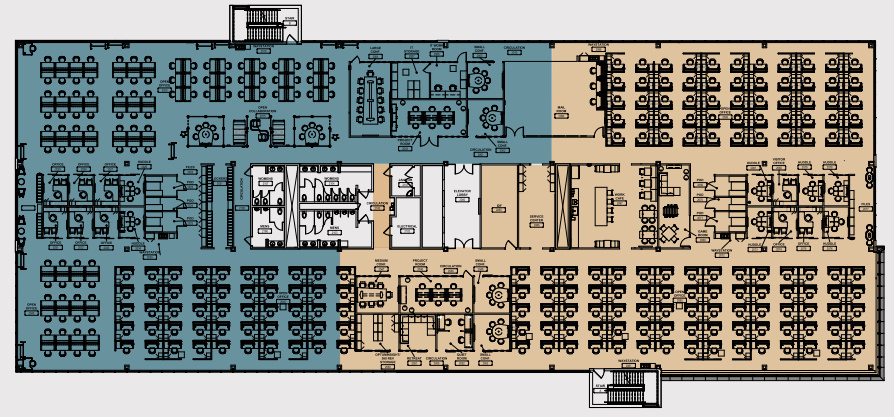









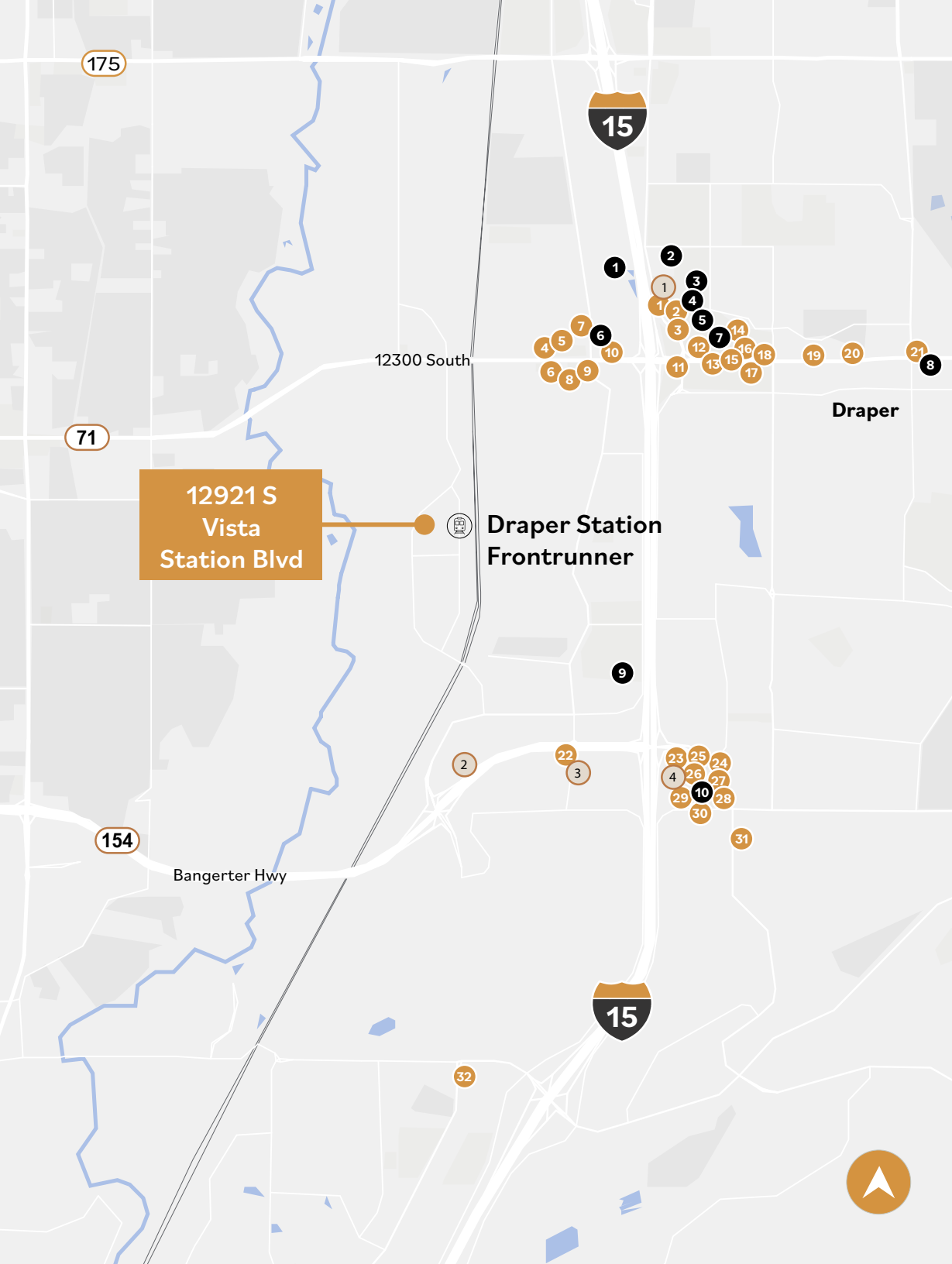

# LOCATION



## Eateries & Bars

1. Leatherheads Sports Bar & Grill
2. Mountain Mike's Pizza
3. In-N-Out Burger
4. Starbucks
5. Swig
6. Daily Espresso
7. sushi bomb
8. Port of Subs
9. NAWABS INDIAN RESTAURANT
10. Thai Land
11. Panda Express
12. Goodwood Barbecue Company
13. Noodles and Company
14. Great Harvest Bread Co. Bakery & Cafe
15. Costa Vida
16. Astro Burgers
17. Hash Kitchen
18. Dutch Bros Coffee
19. Swig
20. Cupbop - Korean BBQ in a Cup
21. Gourmandise
22. McDonald's
23. NY Pizza Patrol
24. Ivie Juice Bar Draper
25. Water Moon
26. Beans & Brews Coffeehouse
27. Bigeye Poke Grill Draper
28. Kneaders Bakery & Cafe
29. La fogata
30. La Barba Coffee
31. Jimmy John's
32. Toro Ramen and Sushi



## Shops & Entertainment

1. Loveland Living Planet Aquarium
2. Cowabunga Bay WaterPark
3. Impact Golf Center
4. Cinemark Draper and XD
5. Sephora
6. Draper Indoor Golf Club
7. Shirlyn's Natural Foods
8. HANGAR 15 Bicycles - Draper
9. IKEA
10. Harmons Grocery



## Hotels

1. SpringHill Suites Salt Lake City Draper
2. Homewood Suites by Hilton Salt Lake City Draper
3. Hampton Inn Draper Salt Lake City
4. TownePlace Suites Salt Lake City Draper





FOR MORE INFORMATION, CONTACT

**David Nixon**

+1 801 456 9518

[david.nixon@jll.com](mailto:david.nixon@jll.com)

**Jami Marsh**

+1 801 456 9514

[jami.marsh@jll.com](mailto:jami.marsh@jll.com)



Although information has been obtained from sources deemed reliable, JLL does not make any guarantees, warranties or representations, express or implied, as to the completeness or accuracy as to the information contained herein. ©2025 Jones Lang LaSalle Brokerage, Inc. All rights reserved.