



For Sublease

10741 - 10761 King William Dr.
Dallas, TX 75220

± **29,297 SF Available**



Caleb McCoy, SIOR
Managing Director
caleb.mccoy@jll.com
(214) 949.2084

Paul Davis
Associate
paul.davis2@jll.com
(214) 808-1519

10741 - 10761 King William Dr. | Dallas, TX 75220

Property Specifications

- $\pm 29,297$ SF available
 - $\pm 25,777$ SF Warehouse
 - $\pm 3,520$ SF Office - 1st floor
- $\pm 3,015$ SF Mezzanine office - 2nd floor
(Not included in overall SF)
- 23' clear height
- 7 (10' x 10') dock high doors
- Heavy power
- Front load distribution
- End cap space
- Lease Expiration 12/31/2027

Site Plan

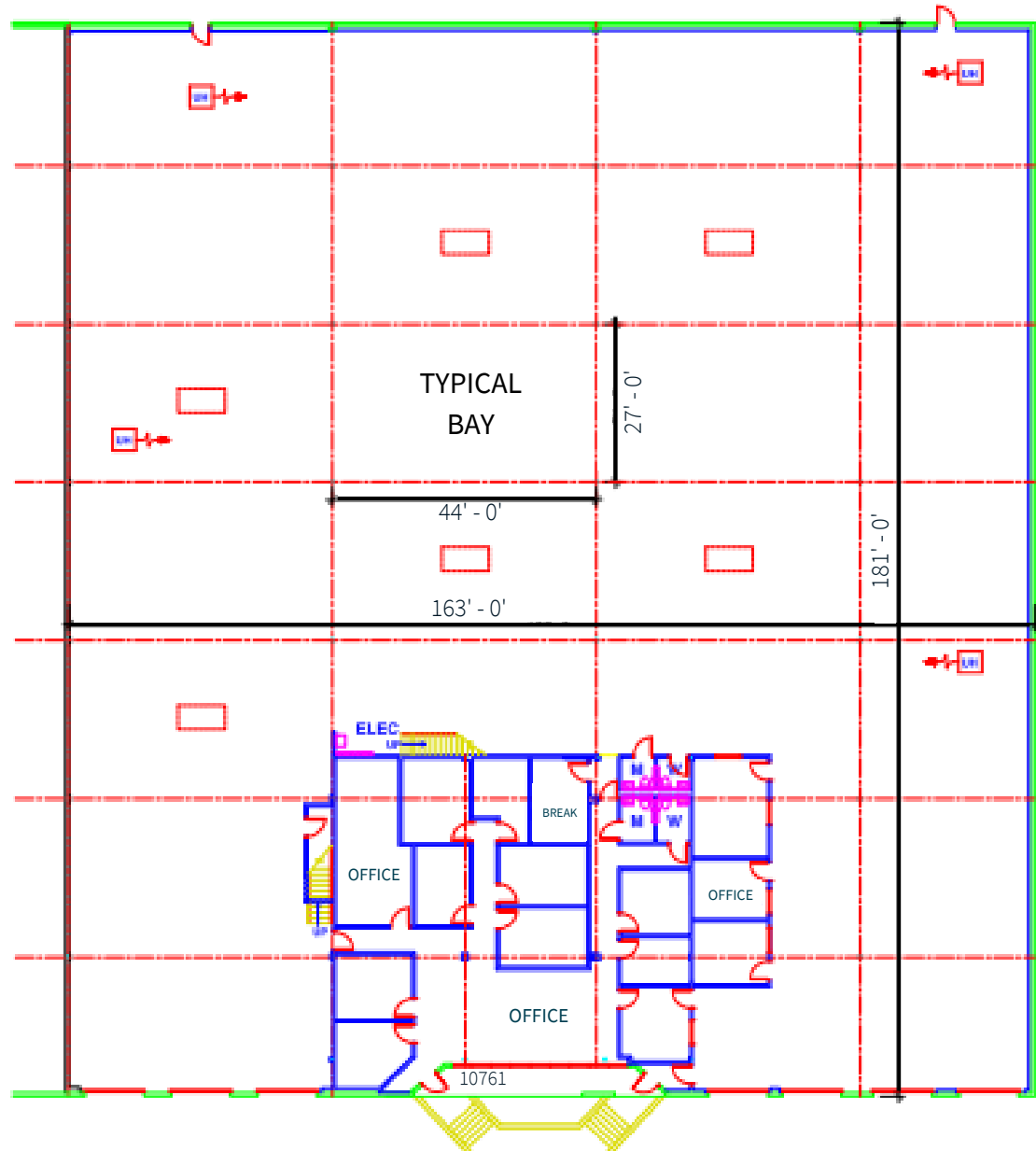

10741 - 10761 King William Dr. | Dallas, TX 75220

Property Photos

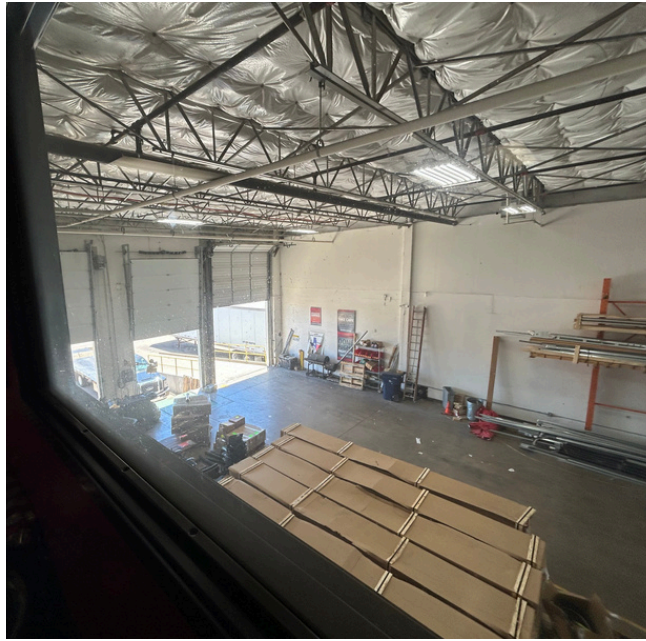

10741 - 10761 King William Dr. | Dallas, TX 75220

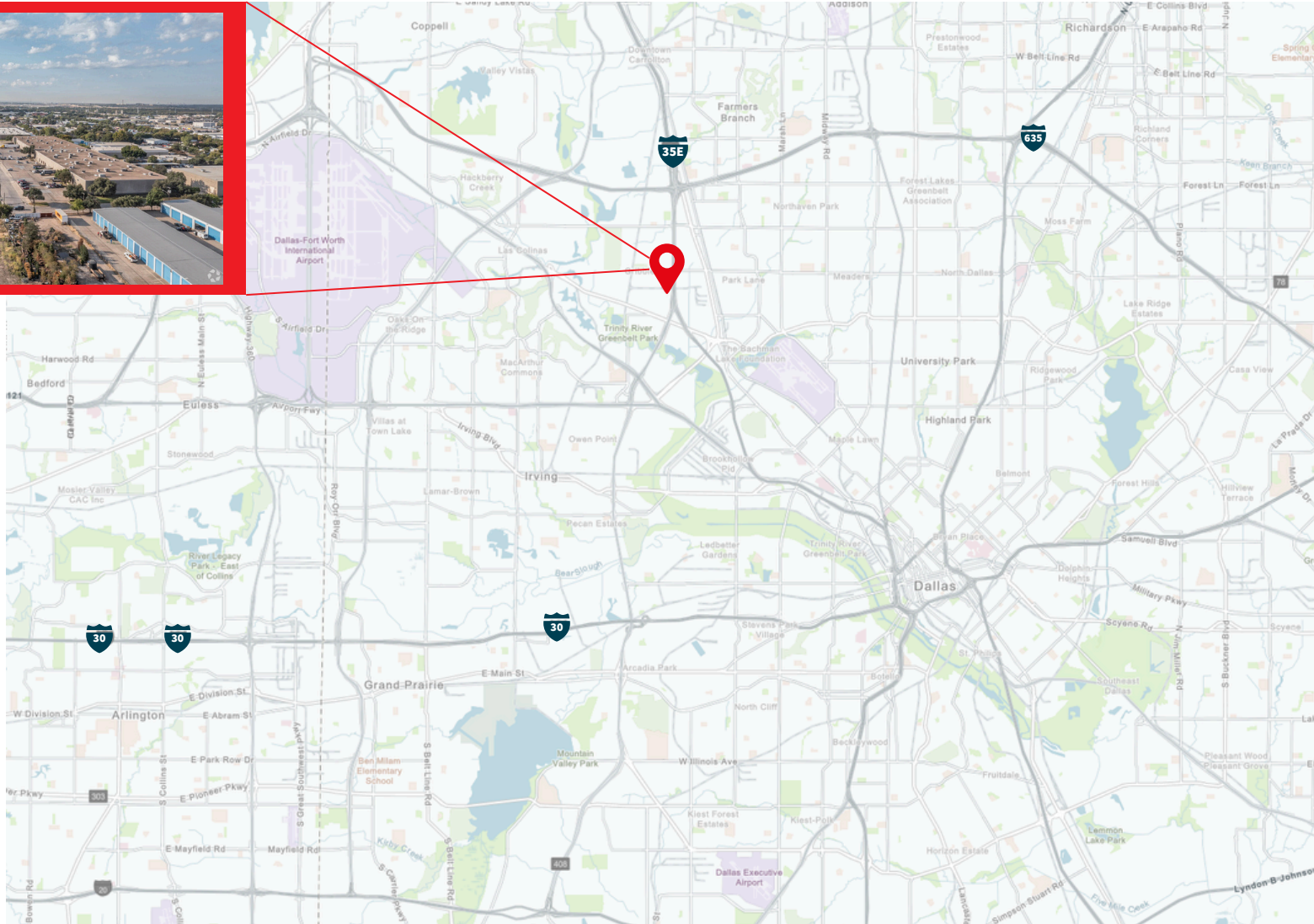

Although information has been obtained from sources deemed reliable, neither Owner nor JLL makes any guarantees, warranties or representations, express or implied, as to the completeness or accuracy as to the information contained herein. Any projections, opinions, assumptions or estimates used are for example only. There may be differences between projected and actual results, and those differences may be material. The Property may be withdrawn without notice. Neither Owner nor JLL accepts any liability for any loss or damage suffered by any party resulting from reliance on this information. If the recipient of this information has signed a confidentiality agreement regarding this matter, this information is subject to the terms of that agreement. © 2024 Jones Lang LaSalle IP, Inc. All rights reserved.



Caleb McCoy, SIOR
Managing Director
caleb.mccoy@jll.com
(214) 949.2084

Paul Davis
Associate
paul.davis2@jll.com
(214) 808-1519